

PORT

2024

May 28, 2020

Port Lands Flood Protection SAC #7

LANDS

Canada

Ontario

Toronto



Agenda

- Introductions and Teams Instructions – Waterfront Toronto (10 minutes)
- Construction and Design Update – Waterfront Toronto (5 minutes)
- Update: Promontory Park and River Valley Park – MVVA
- Discussion and Feedback (40 minutes)
- Update: Sediment and Debris Management Area – MVVA
- Discussion and Feedback (15 minutes)
- Wayfinding and Interpretive Signage for Parks – MVVA
- Discussion and Feedback (35 minutes)
- Upcoming public meeting – Waterfront Toronto
- Discussion and Feedback (15 minutes)

Introductions + Teams Instructions

Teams 101 – Joining on a Computer

- Turn your camera on if you're comfortable
- Click the microphone icon to mute yourself when you're not speaking
- Troubleshooting: use the chat window to note any issues
- "Raise your hand" to ask a question or make a comment
- We'll record this session for minuting purposes

Microsoft Teams

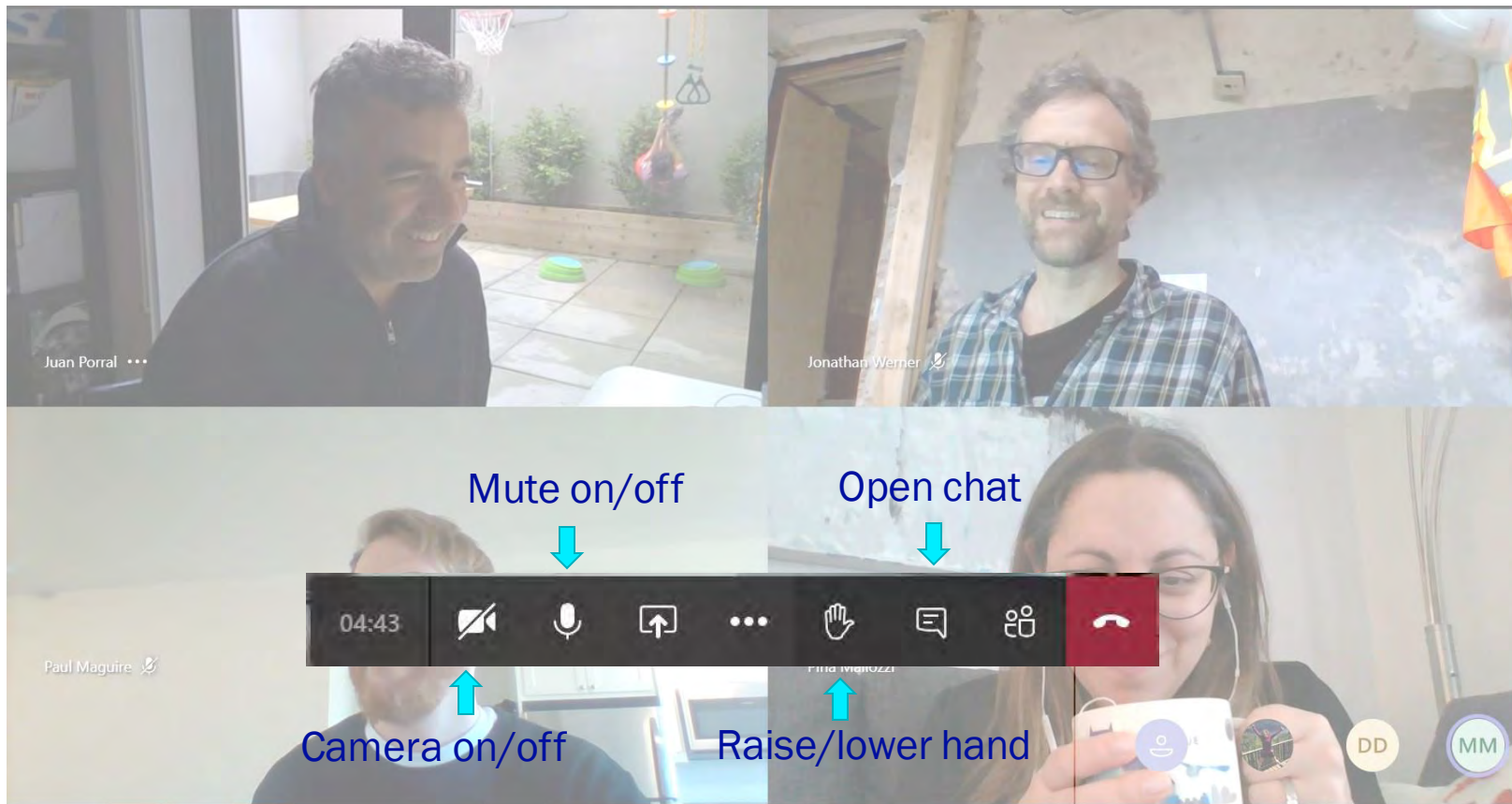

Teams 101 – Joining via Telephone

- To mute/un-mute yourself, press *6
- Mute yourself when you're not speaking
- Let us know if you can't hear or you can't tell which slide is being presented
- We'll open the floor to your questions/comments once all hands are down

Introductions...and checking in



On a scale of
mud pile to marshy oasis

How is everyone doing?

Construction and Design Update

A view of the construction site (video)



Rocky Radar – Progress Reports via @TheRockRipper

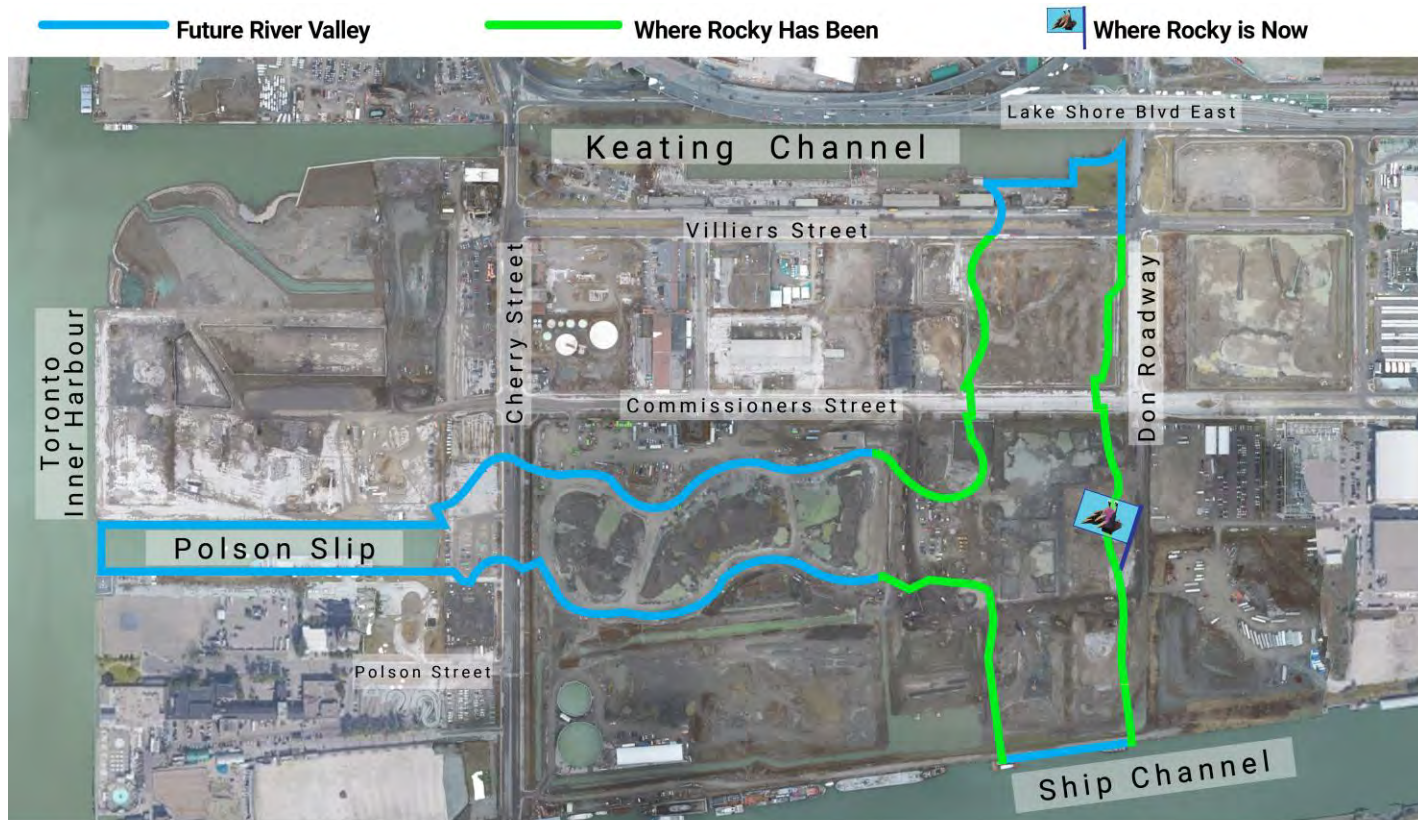

May 29, 2020

Project Design Schedule

- 10/10/2019- 60% Design Submission (RVPN/RVPS) Work Package #9
- 01/23/2020- 100% Design IFC Submission (River) Work Package #8
- 02/26/2020- SAC Meeting #6
- 05/07/2020- 60% Design Submission (PPS/Canoe Cove) Work Package #9.2/9.3
- 05/28/2020- SAC Meeting #7
- 06/25/2020- 90%/IFT Submission (MT-35 Dockwall/Atlas Crane) Work Package #9.1
- 10/29/2020- 90% Design IFT Submission (RVPN/RVPS/PPS) Work Package #9

Design Update

- MVVA has issued a Request for Proposals for an Indigenous Design Consultant
- We anticipate having a consultant on board by the end of June 2020
- The consultant will:
 - Have both an advisory and design role
 - Work with the design team as well as a counterpart at the Mississaugas of the Credit First Nation
 - Work with the project communications team
 - Work with us until the end of the design and construction to integrate First Nations interests, tradition and culture into the project

Port Lands Flood Protection & Enabling Infrastructure Stakeholder Advisory Committee Meeting #7

Prepared for Waterfront Toronto
May 28, 2020

Michael Van Valkenburgh Associates, Inc.
Landscape Architects

Project Feedback

Design Review Panel

- Find a role for **public art** within the design
- Develop signage and way-finding
- Create a family of materials and furnishings
- **Consider future conditions** in and around the park, such as the catalyst building and urban massing
- Future-proof the design to **accommodate fluctuating lake levels**
- **Study event programming** at the central lawn
- Develop **park operations** and programming
- Choreograph **winter programming and character**
- Consider unique engagement opportunities between park visitors and site ecology
- Create an **inventive, bio-diverse, and daring planting strategy**
- **Strongly integrate remnants** of industrial and natural heritage
- Provide renderings of the Esplanade
- Develop the character of Destination Play

Community (Survey + Consultations)

- Feeling immersed in nature comes from ability to wander while discovering new views or un-manicured vegetation
- **Variation of landscape and ecology** was noted as “nice to have”
- People expressed a desire for **clear information about access points** (lighting and signage indicating formal paths)
- Emphasis on **views and variety of landscape types**
- **Create views of Inner Harbour and City**
- **All season use** support winter programming
- Facilitate public water activities and **connections/access to the water**
- **Integrate history** through preserving local heritage and culture (adaptive reuse, art)

SAC Meeting #6 - 2/26/2020

- The adventurous, all-ages design for the River Valley Park North **play area is exciting**
- Interest in **preserving space for grills, fire pits and gathering spaces** as the design progresses
- Take care to **engage Indigenous Communities in placemaking** in the park
- The plans for the Lower Don Trail connection to the Martin Goodman Trail are not ideal
- The Sediment and Debris Management Area’s footprint is large. The public realm and nearby trails should be considered in its design.

Promontory Park South and River Valley Park North/South - Updated Design



Orchestrating a Complete Ensemble

Promontory Park South

- Event Lawn & Plaza
- Harbour Esplanade
- Marine Terminal 35 Building Commemoration
- Promontory
- Atlas Crane Peninsula
- Entry Plaza
- Destination Play Area (Contingent on Fundraising)

River Valley Park North and South

- Commissioners Street Edge
- Nature Play Area
- Picnic Area
- Picnic Lawn
- Dog Off Leash Areas
- FH-30 Plaza
- Future Polson Street Edge
- Bike Bridges

Park Wide Features

- Gathering Areas
- Art
- Wayfinding and Signage
- Site Furnishings, Lighting and Materials
- Operations and Maintenance
- Planting

Promontory Park South

Event Lawn, Plaza and Esplanade - Enlargement Plan



Harbour Esplanade - Section

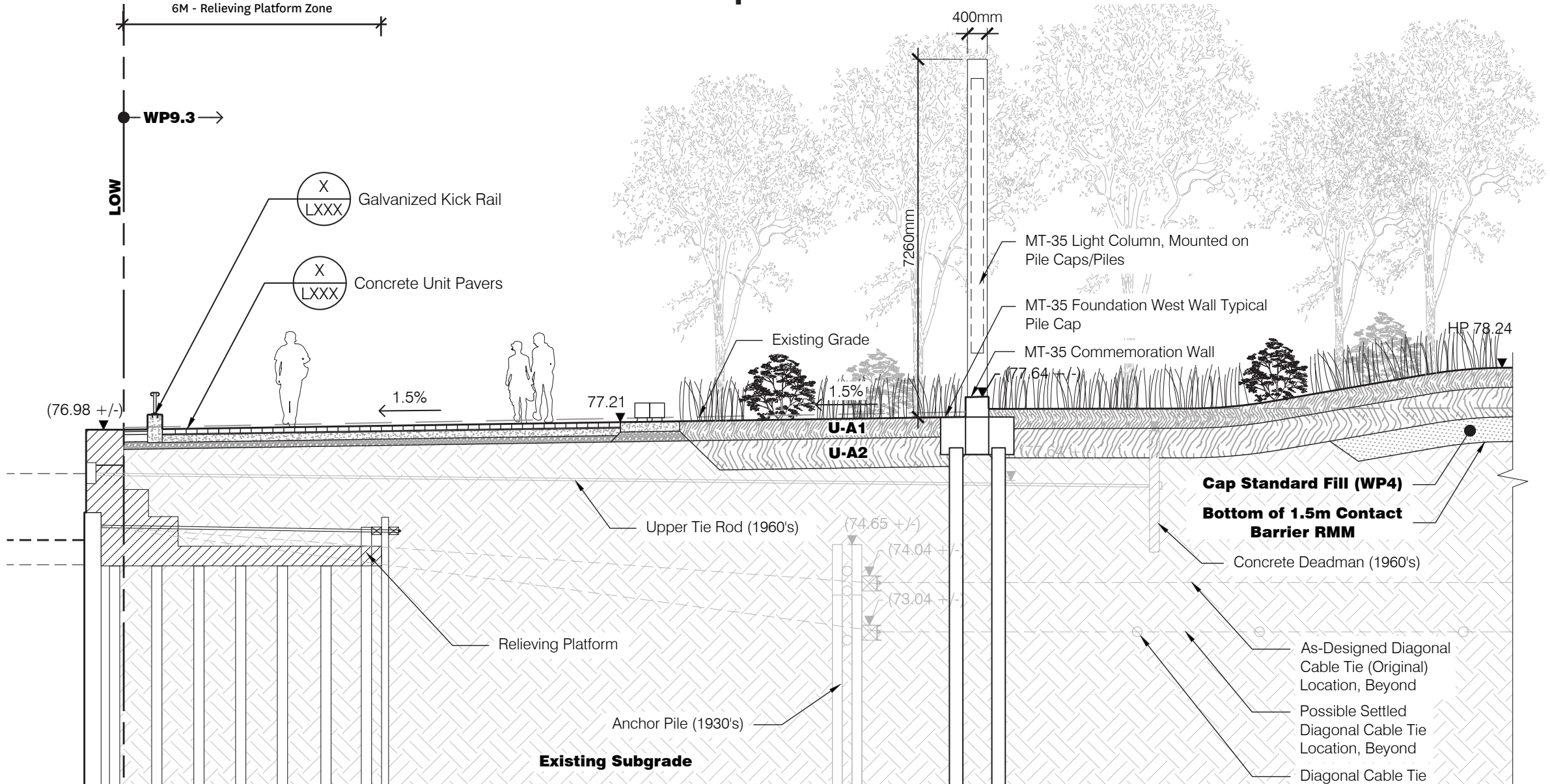

MT-35 Building Commemoration - Scale and Volume

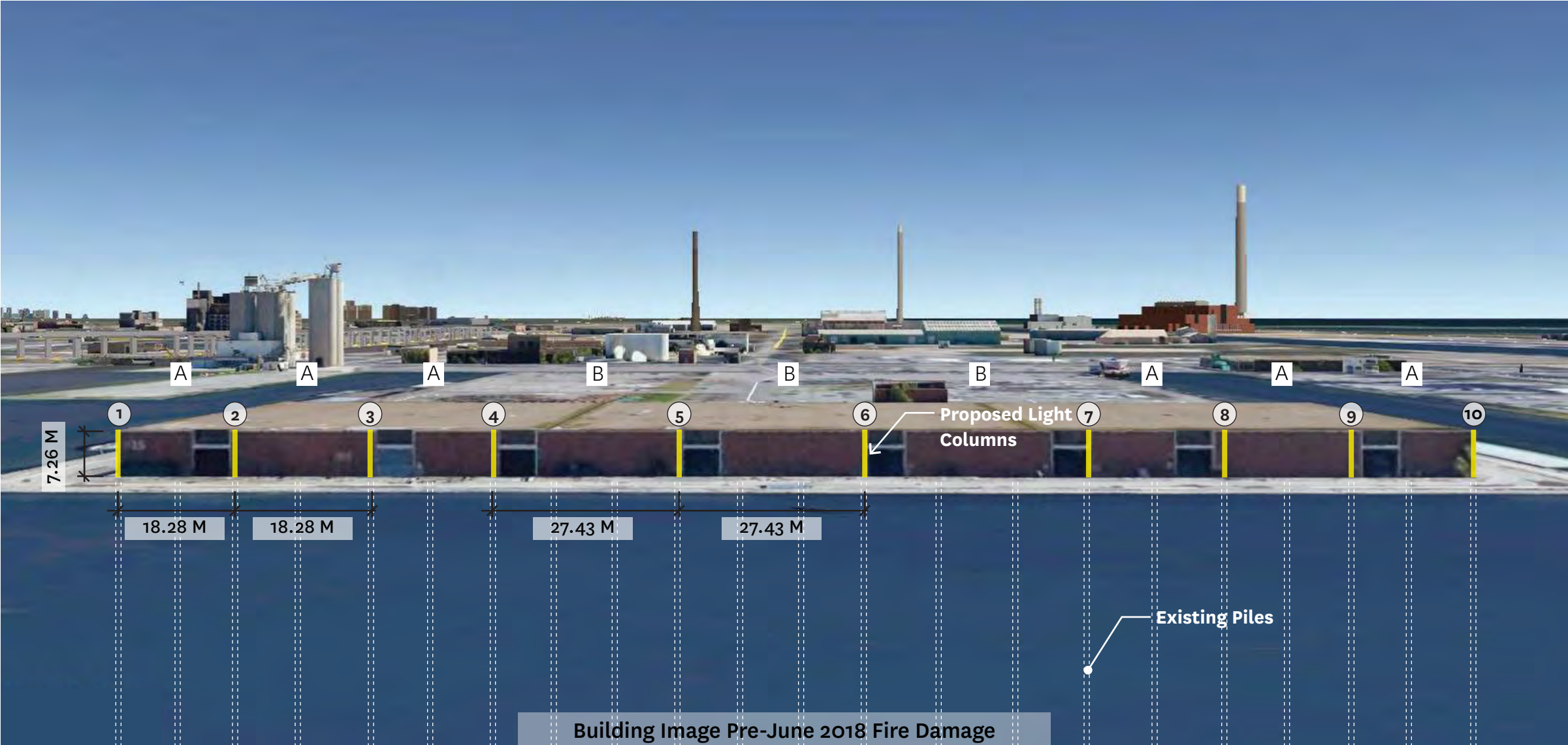

View From Harbour Promenade Looking South Towards Toronto Islands



Promontory - Bird's Eye View



Promontory Walls - Detail Section



MSE Wall - Waller Creek, Austin, TX

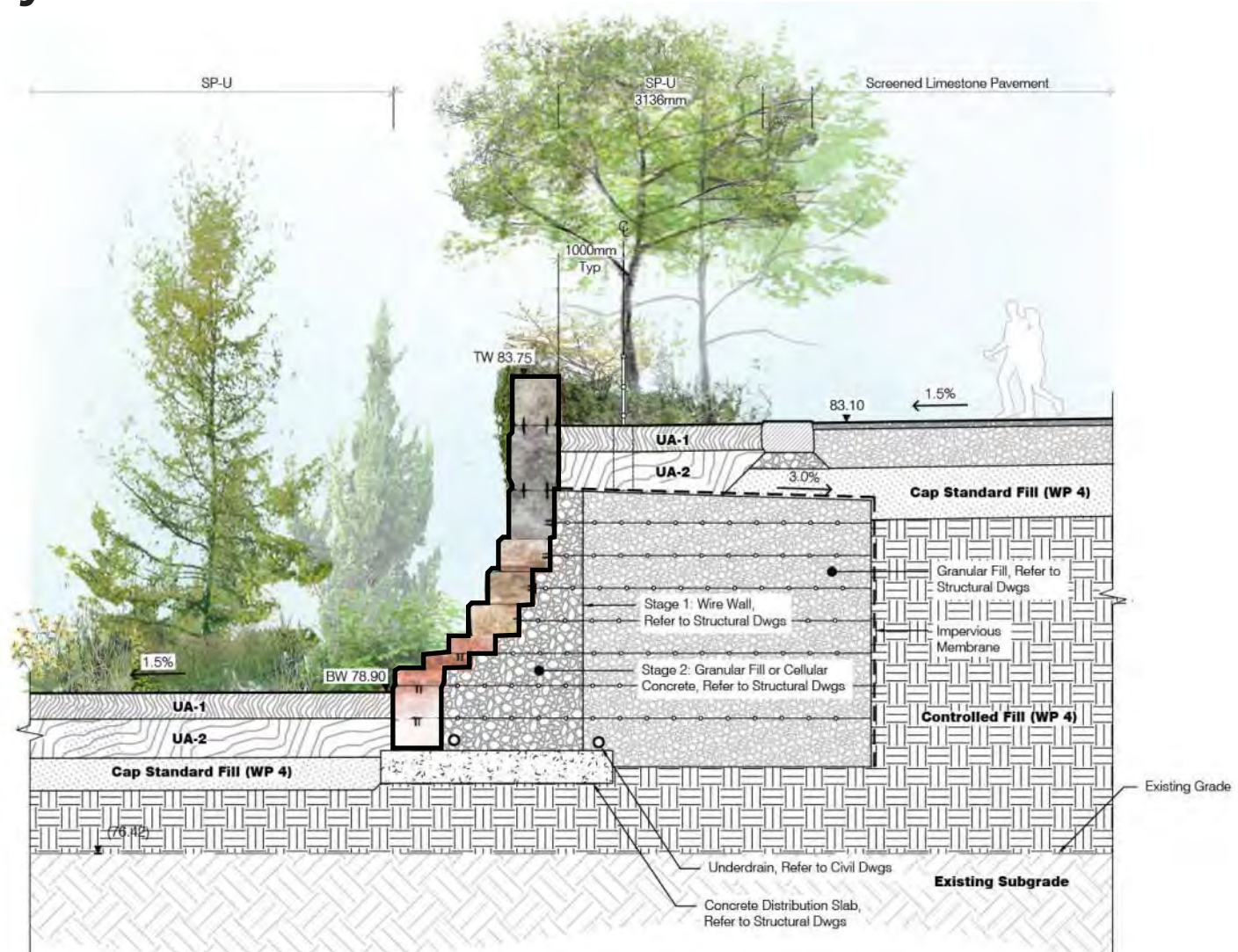

2nd Stage - Stone Facing

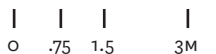

East Promontory Wall - Unfolded Elevation

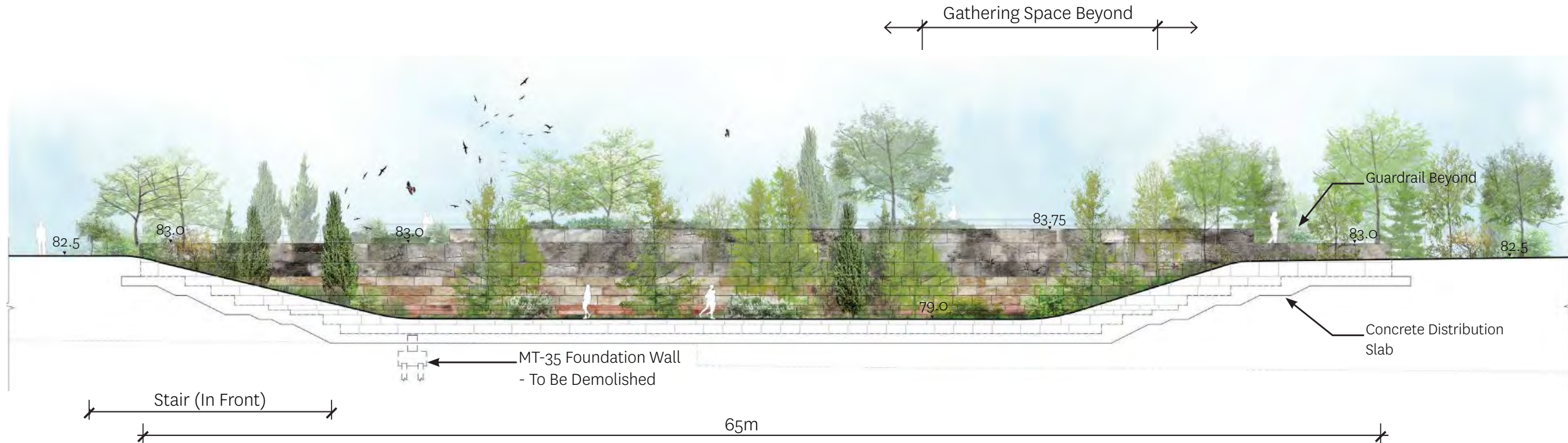

0 1.75 3.5 7M

View from Polson Slip Overlook looking Northwest to Harbour Promontory



Atlas Crane Peninsula - Enlargement Plan

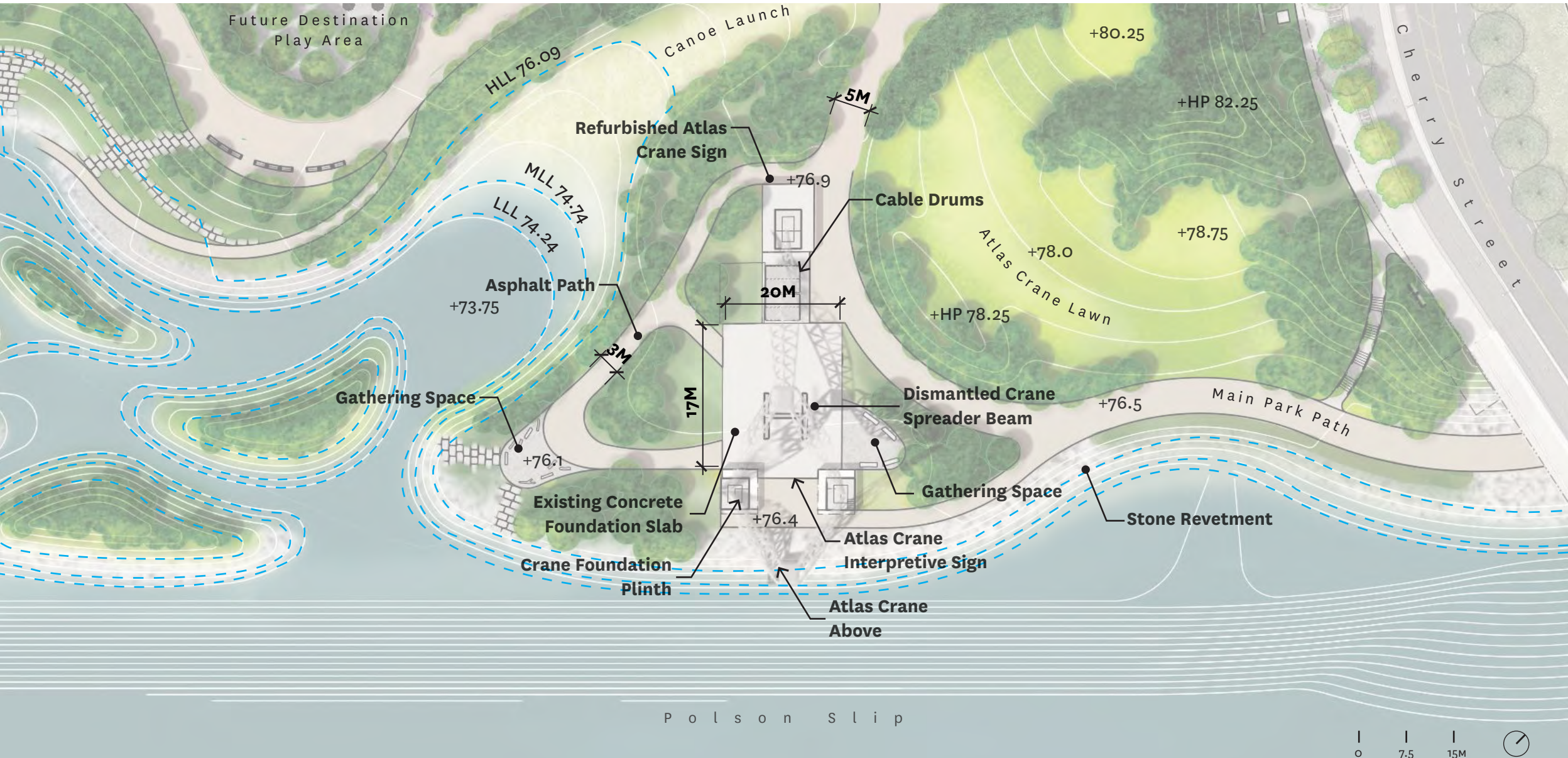

Park Entrances at Cherry Street - Enlargement Plan

The image displays two detailed landscape architectural site plans for the 'Park Entrances at Cherry Street - Enlargement Plan'. The plans are oriented horizontally, with the 'Limit of Work' indicated by dashed lines.

Left Plan (Western Side):

- Top:** Future Trinity Blvd, Asphalt Service Road, 20M dimension.
- Center:** Entry Garden, Screened Limestone, Park Benches (5M), Waste and Recycling Receptacles, Asphalt Path (+78.0), Main Park Path (+78.0), Range Fence Type 2 (+80.25, +HP 82.25), CIP Concrete Stair (+78.75).
- Bottom:** Atlas Crane Lawn (+76.9), Atlas Crane Peninsula.
- Right:** Cherry Street, Future Cherry Street LRT.

Right Plan (Eastern Side):

- Top:** Commissioners Street, Future Commissioners Street LRT, Bike Racks, Waste and Recycling Receptacles (+78), Park Benches (+77.5), Dogs Off-Leash Area.
- Center:** Wetland View Lawn (+HP 80.5), Range Fence Type 2 (4M), Park Benches, CIP Concrete Stair (+76.5), Main Park Path (+77.5), DOLA Fence, Range Fence Type 1, Wetland 1.
- Bottom:** Wetland View Lawn (+79), Limit of Work LRT.

Scale and Orientation:

- Scale: 0, 7.5, 15M.
- North Arrow: Indicated by a circle with an arrow pointing towards the top right.



River Valley Park North and South

Connections and Porosity to the Urban Context

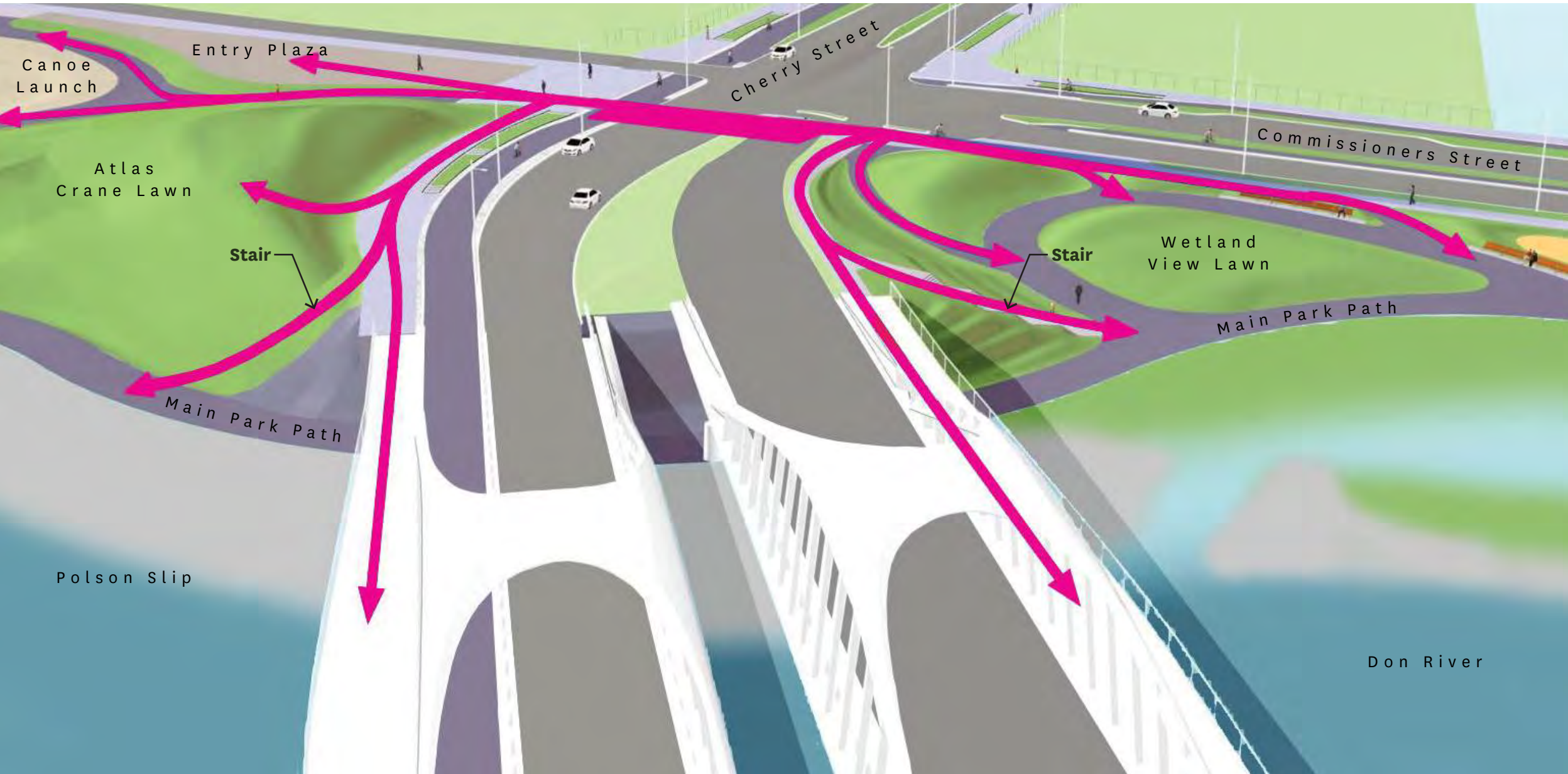

View From Cherry Street Entrance Looking Southeast into River Valley Park North



Porosity at Commissioners Street Edge

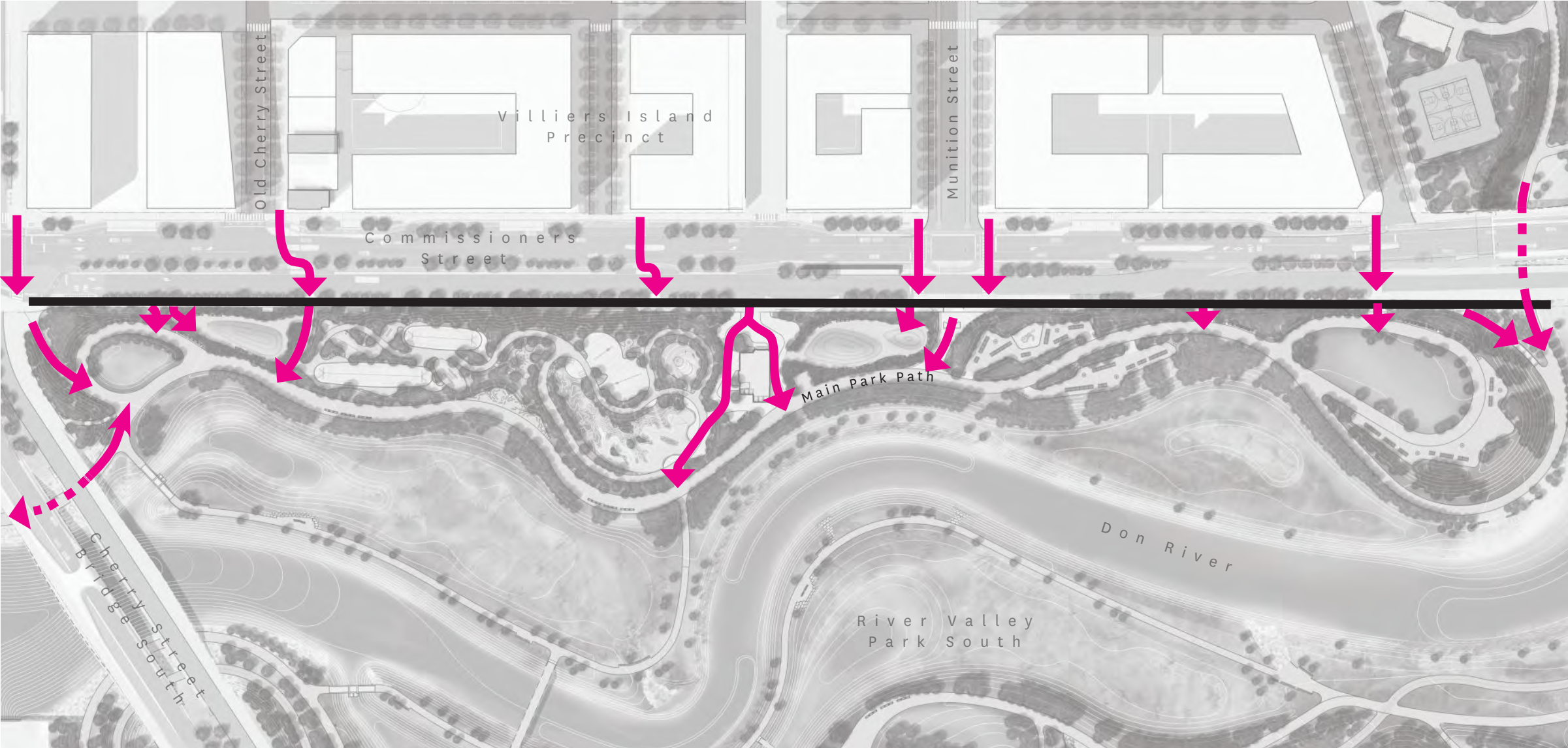

Full Vision



Fire Hall 30 Entry Plaza - Diagram

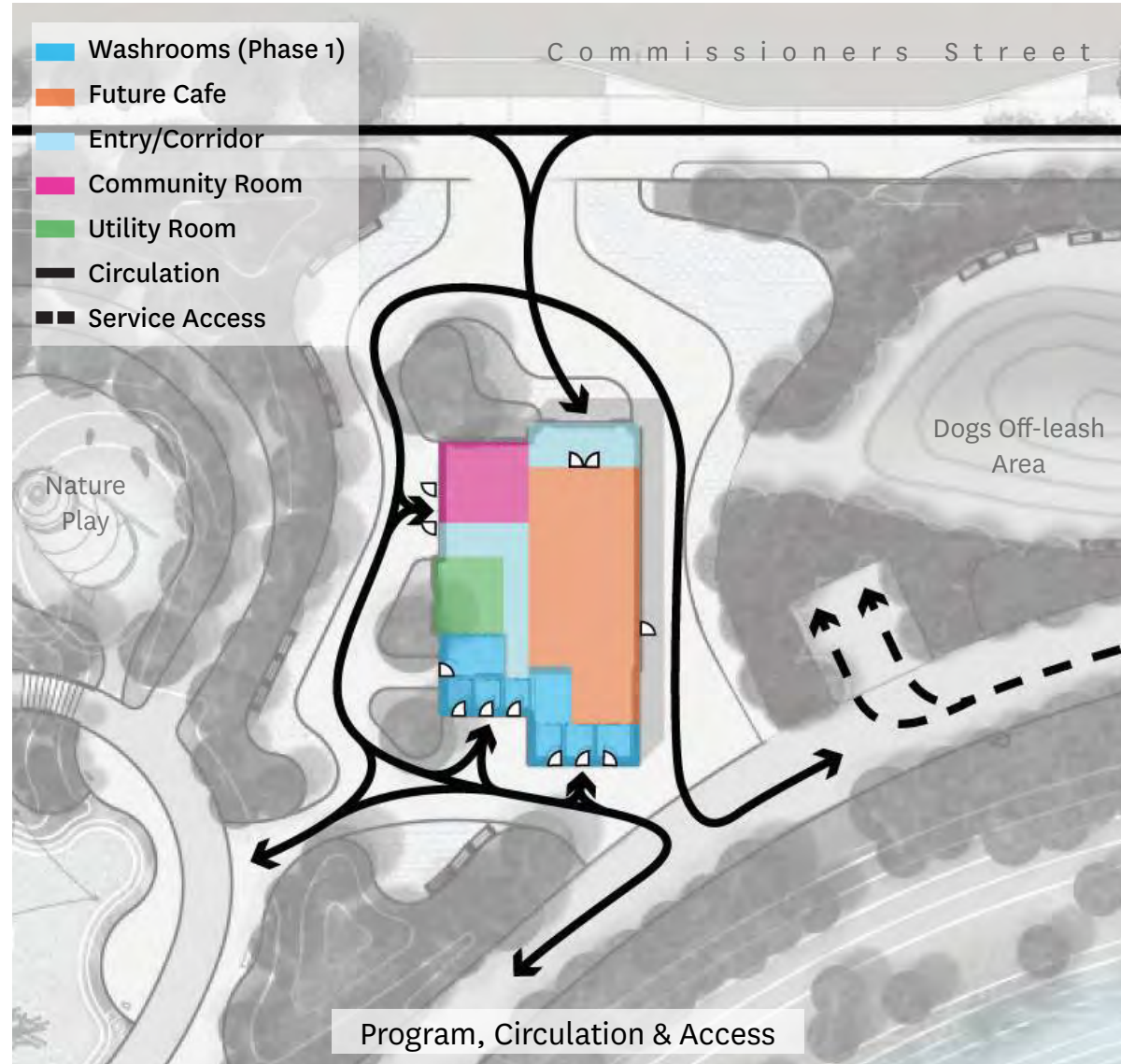
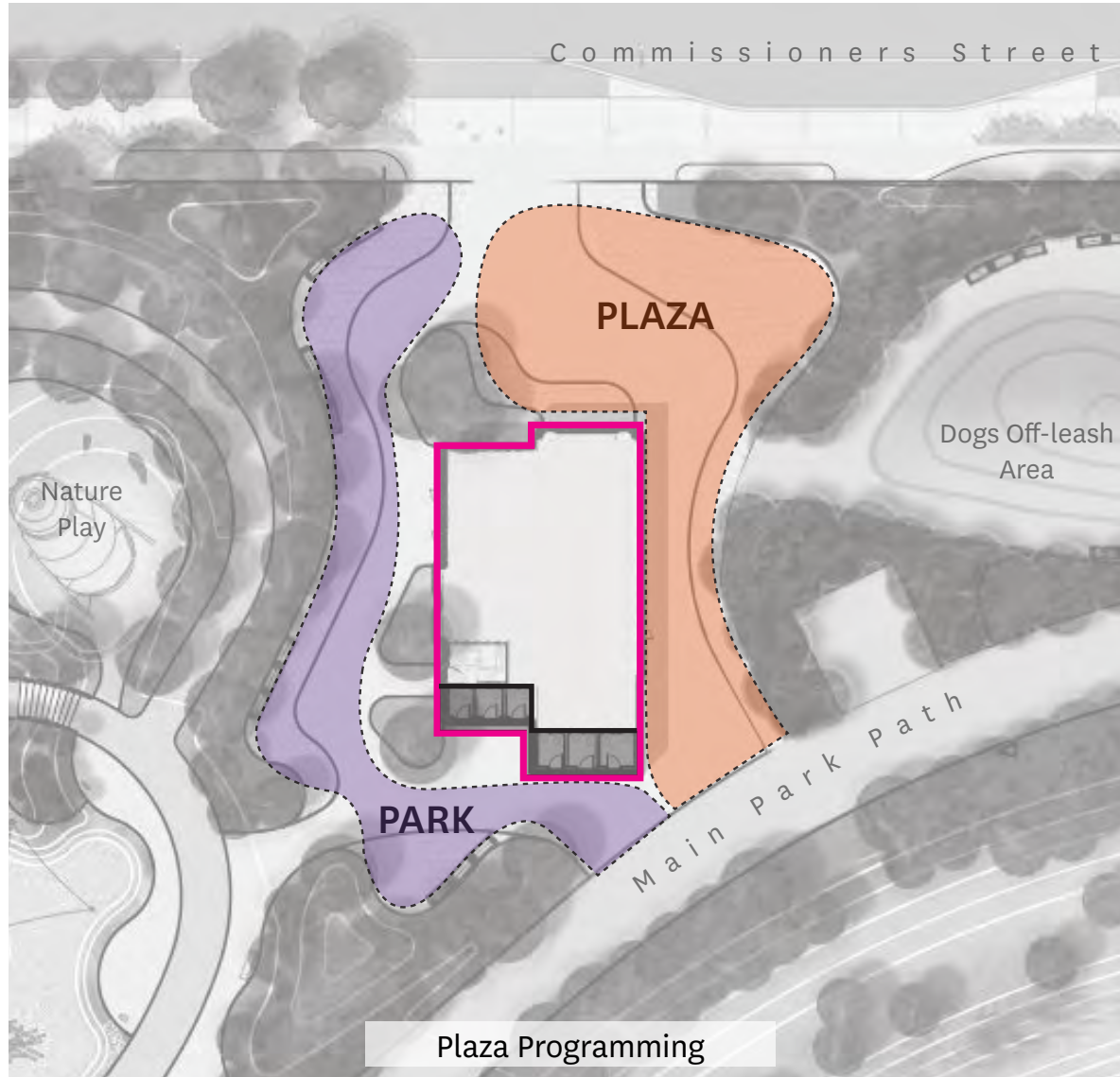

View from Commissioners Street Looking Southeast to Fire Hall 30 Plaza



Nature Play Area - Plan



Nature Play Area Garden Room - Diagram

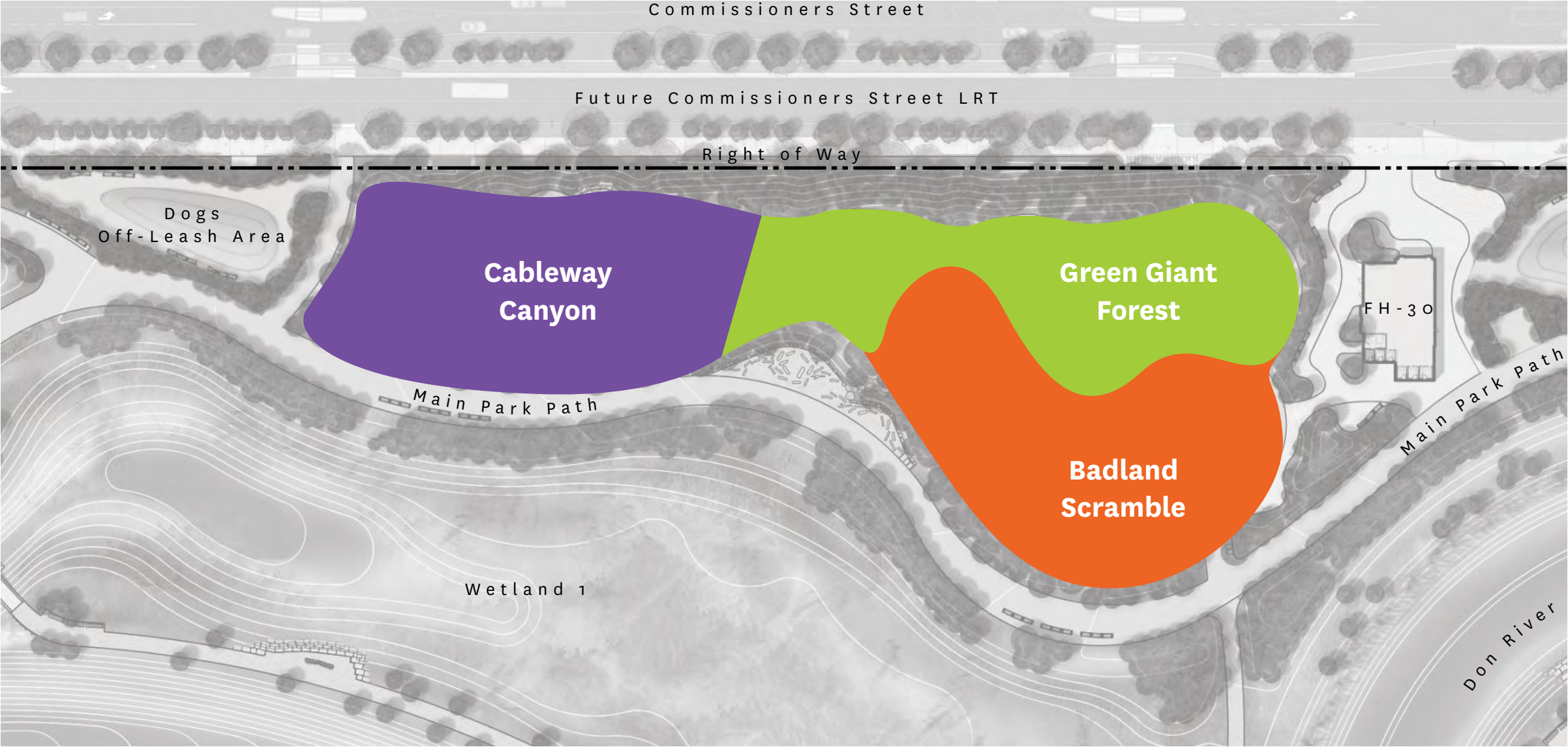

0

17

34M



Badland Scramble - Details

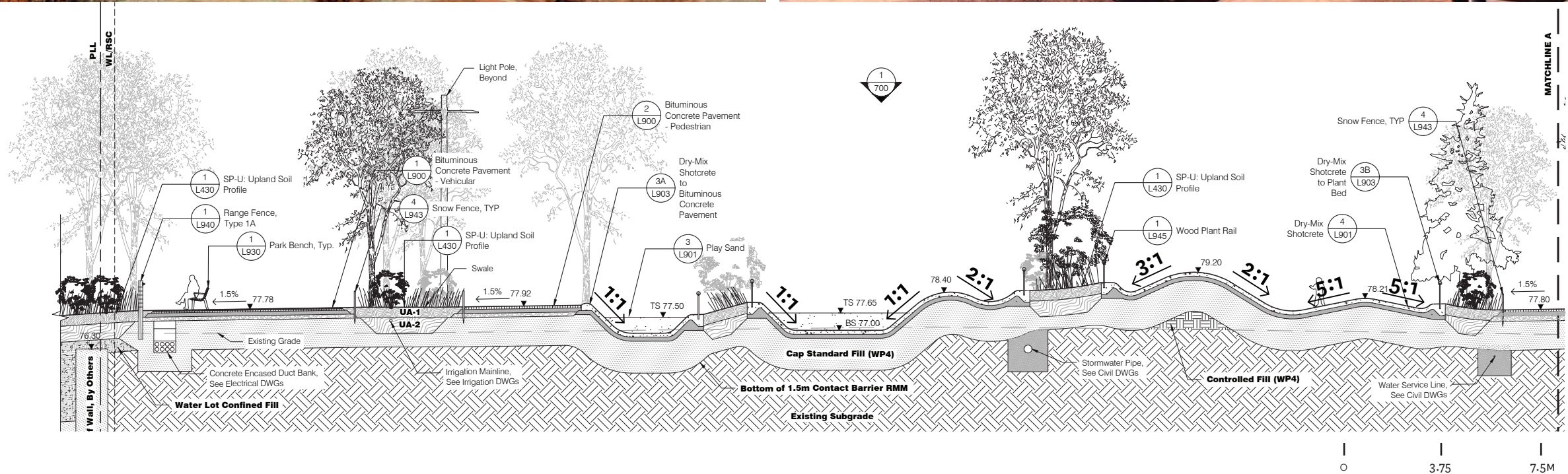

Picnic Terraces and Picnic Lawn - Plan



Picnic Terrace - Enlargement Plan

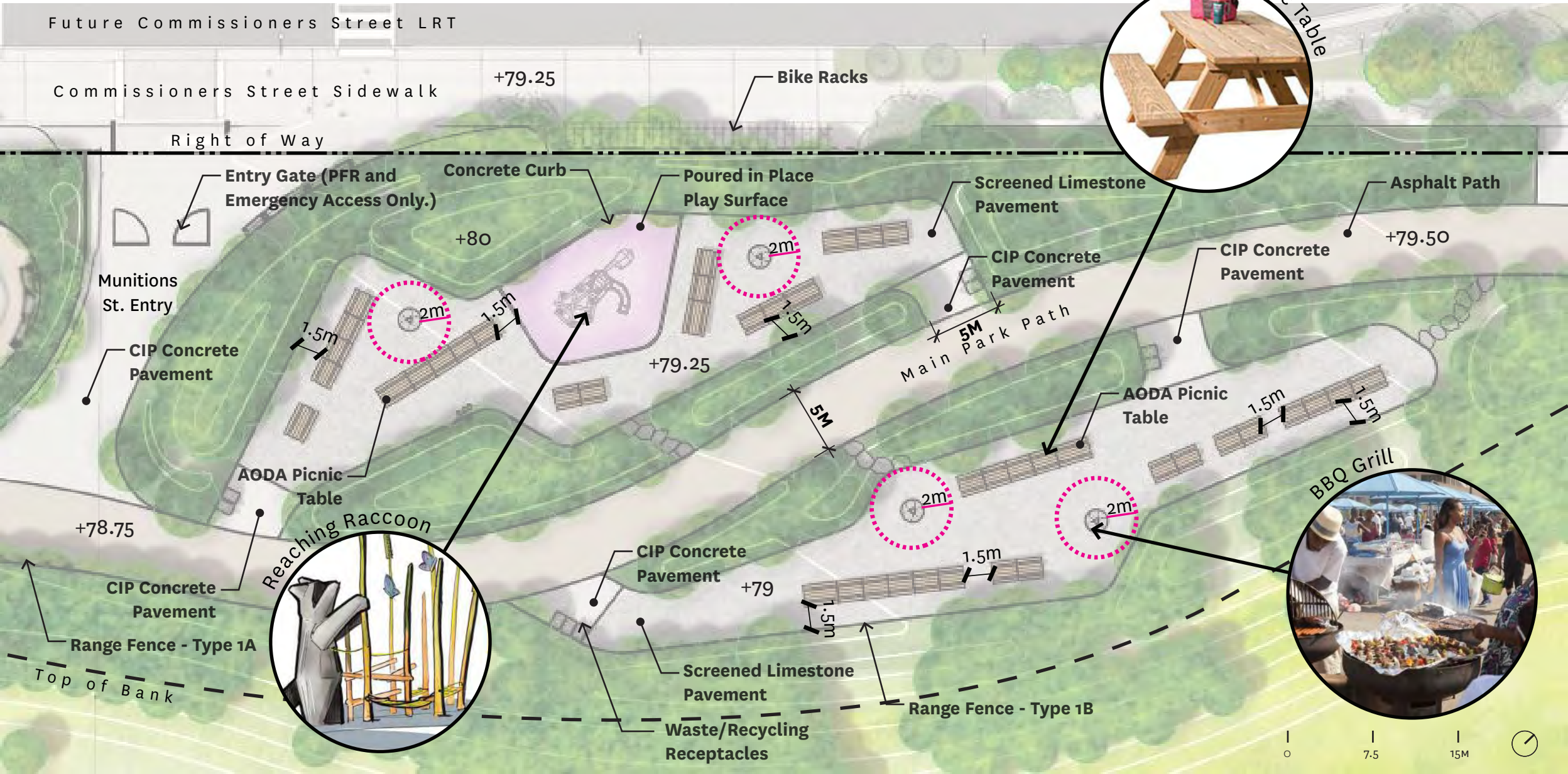

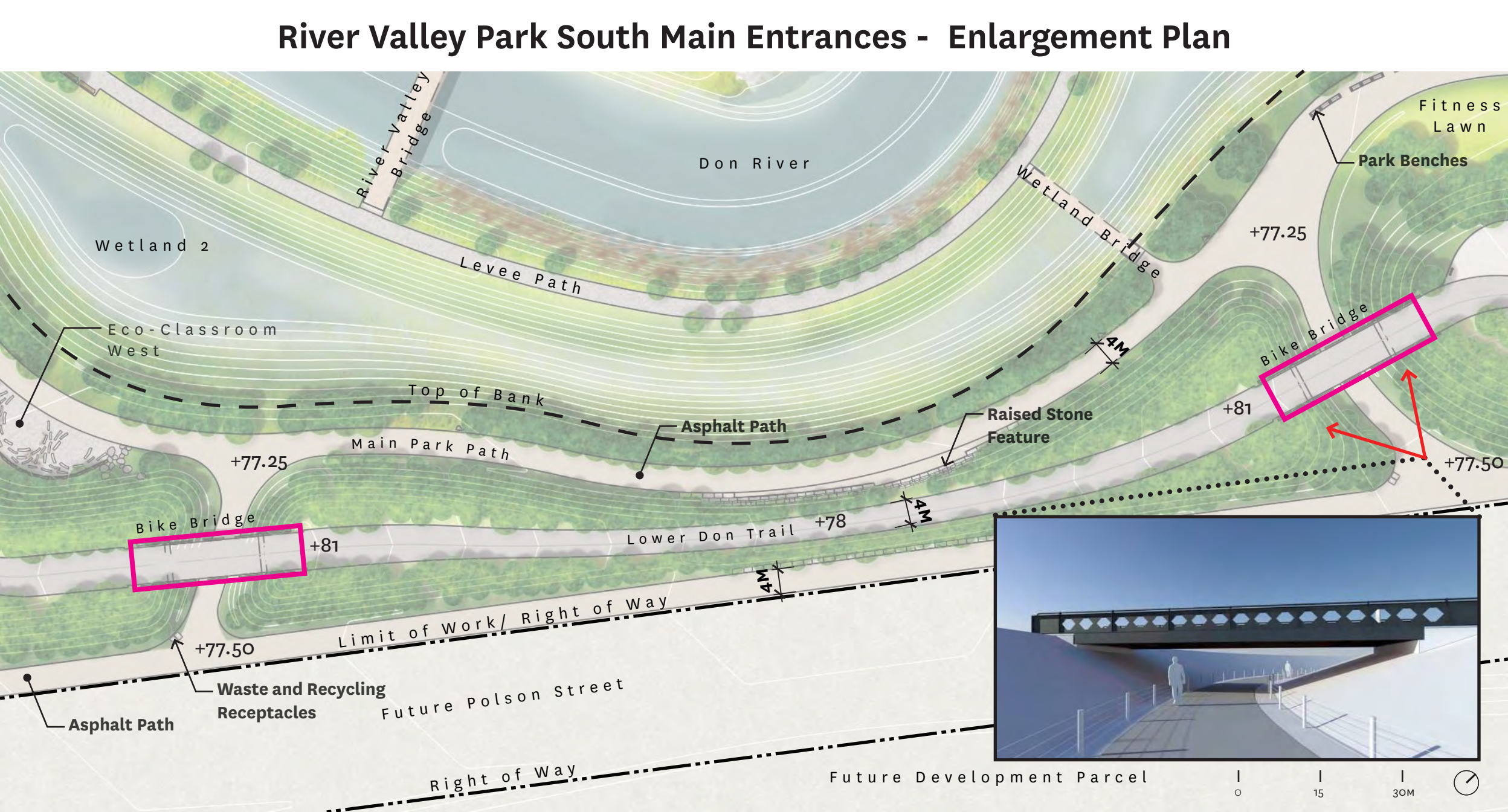
[illegible]



(B) Section Elevation - Longitudinal

Gathering Spaces - Overall Diagram



Gathering Spaces - Enlargement Diagram

Legend

- Log Seating Type 1
- Log Seating Type 2
- Log Edging
- Timber Planks
- Glacial Erratics

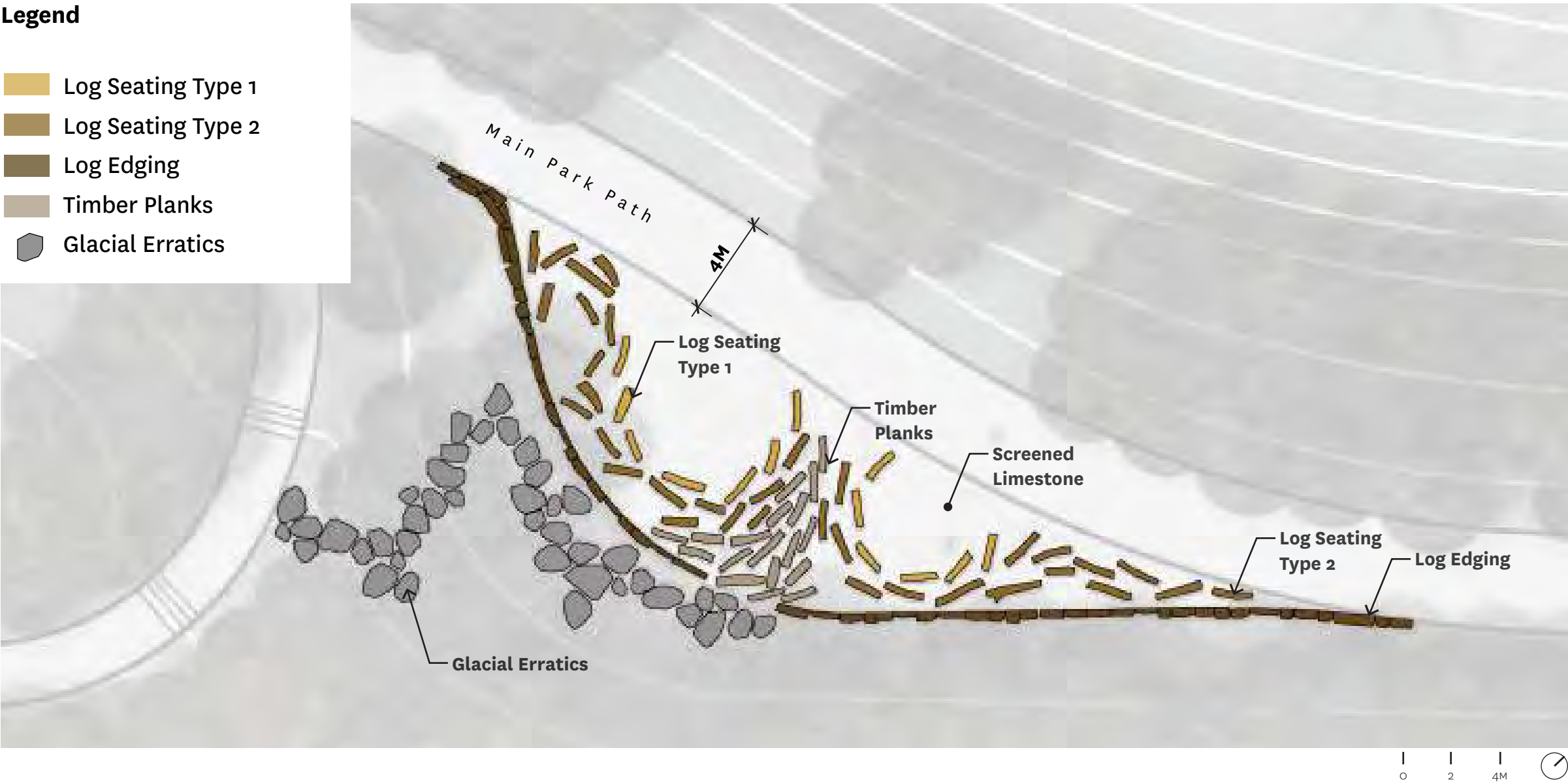

View from Cherry Street Park Entrance looking Southwest towards Canoe Cove



View from River Valley Park South Lawn looking West Towards Promontory Park South



Discussion

- Does this design address previous comments and feedback from the SAC?
- Do you have any concerns about the final design for parks and public realm?

Wayfinding and Interpretive Signage

Wayfinding and Signage Strategy - Diagram

- Entry Hub
- Cyclist
- Pedestrian
- ★ Park Identification
- Tactile Map
- Pavement Compass
- Finger Post
- Rules & Park Area Map
- Bridge ID
- Bridge ID & AODA Info

Alerts:

- Bike Crossings
- Accessible Routes
- Lawns
- Play Areas
- No Climbing
- No Dogs
- Washrooms



Wayfinding and Signage - Example

(Combine Park Entry ID with Map and other Welcome Info)



MAIN ENTRANCE ID



DIRECTIONAL
(FINGERPOST)

(Combine Park Area ID with Rules & regulations)

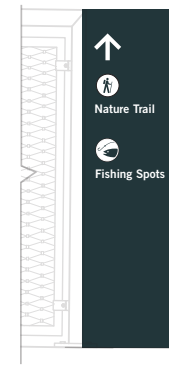

DIRECTIONAL
(BRIDGE)

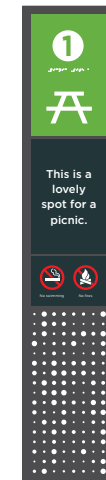

PARK
AREA ID

Wayfinding and Signage - PLFP Orientation Details - Draft Concept

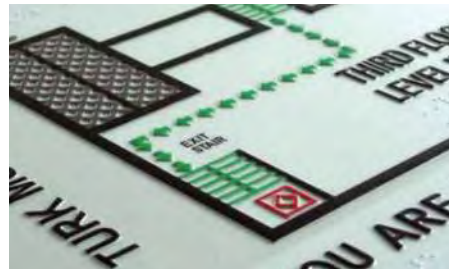

Tactile Map

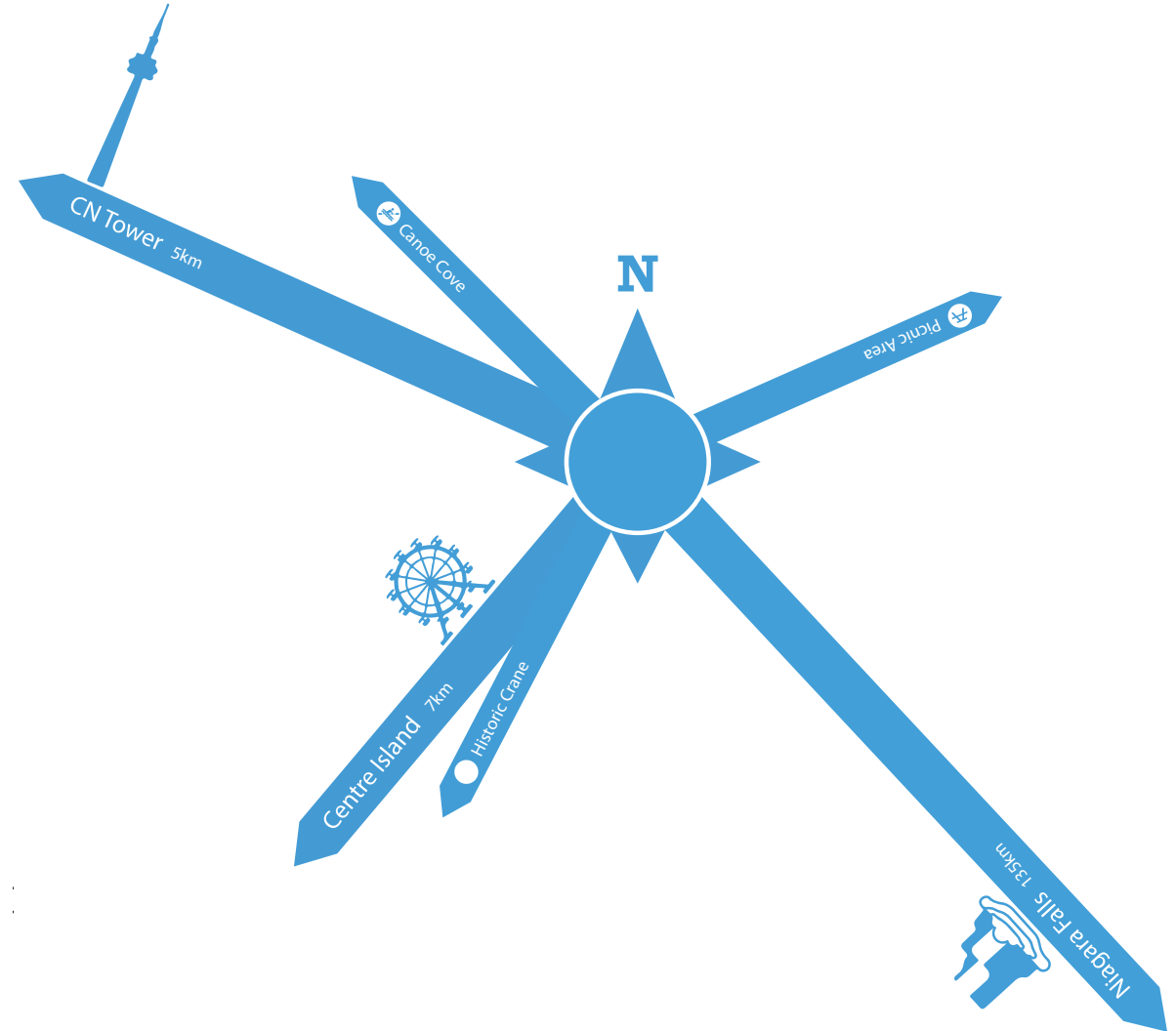

Pavement Compass

Landscape Interpretive Signage Program - Types

- Heritage Element
- Park Exit
- Flood Protection Prospect
- Promontory
- River Calendar
- Habitat Scale
- River Timbers
- Carp Gates
- Habitat Heiroglyphs

Landscape Interpretive Signage Program: Heritage Element

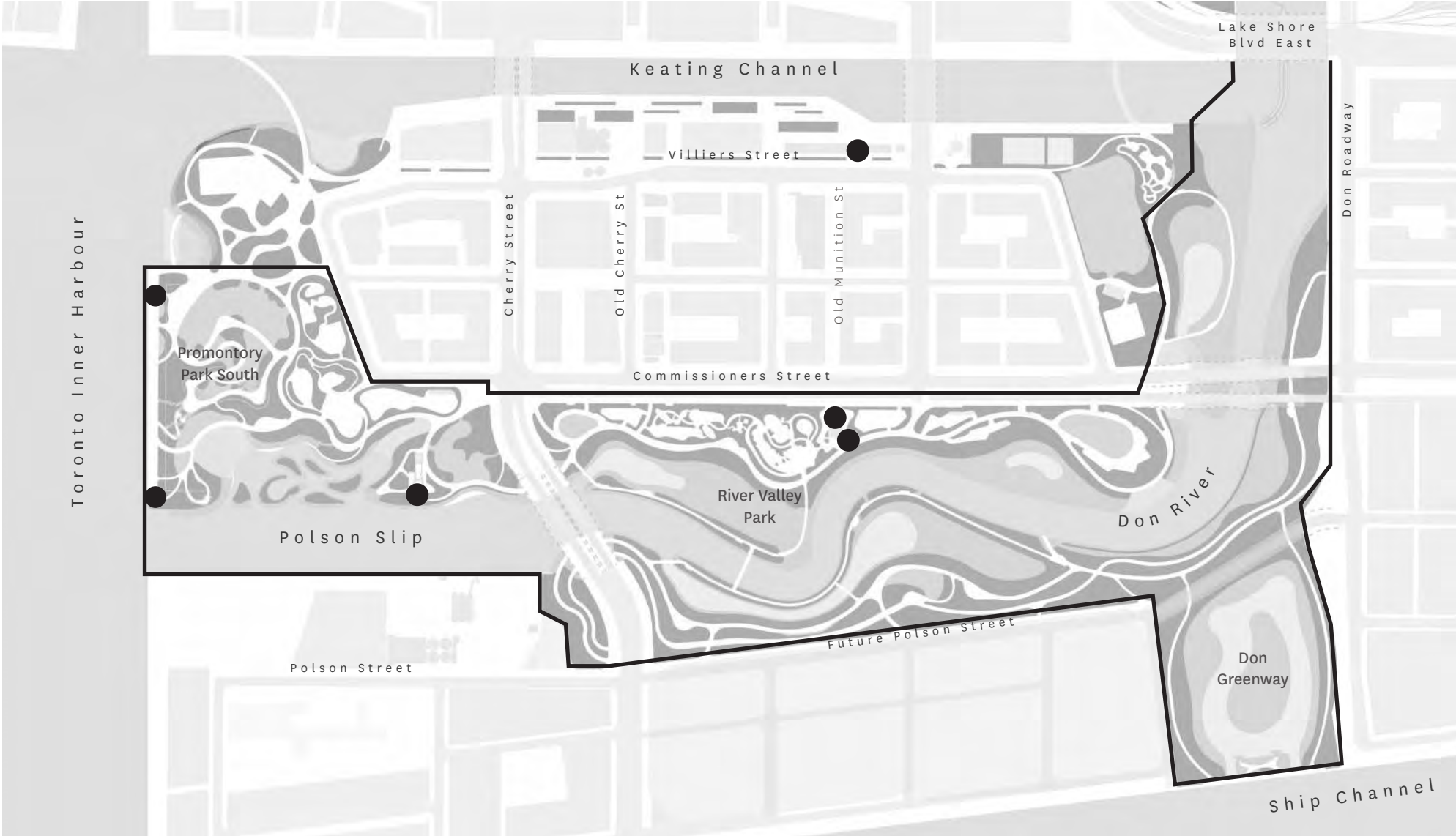

FH-30 - Possible Signage Location

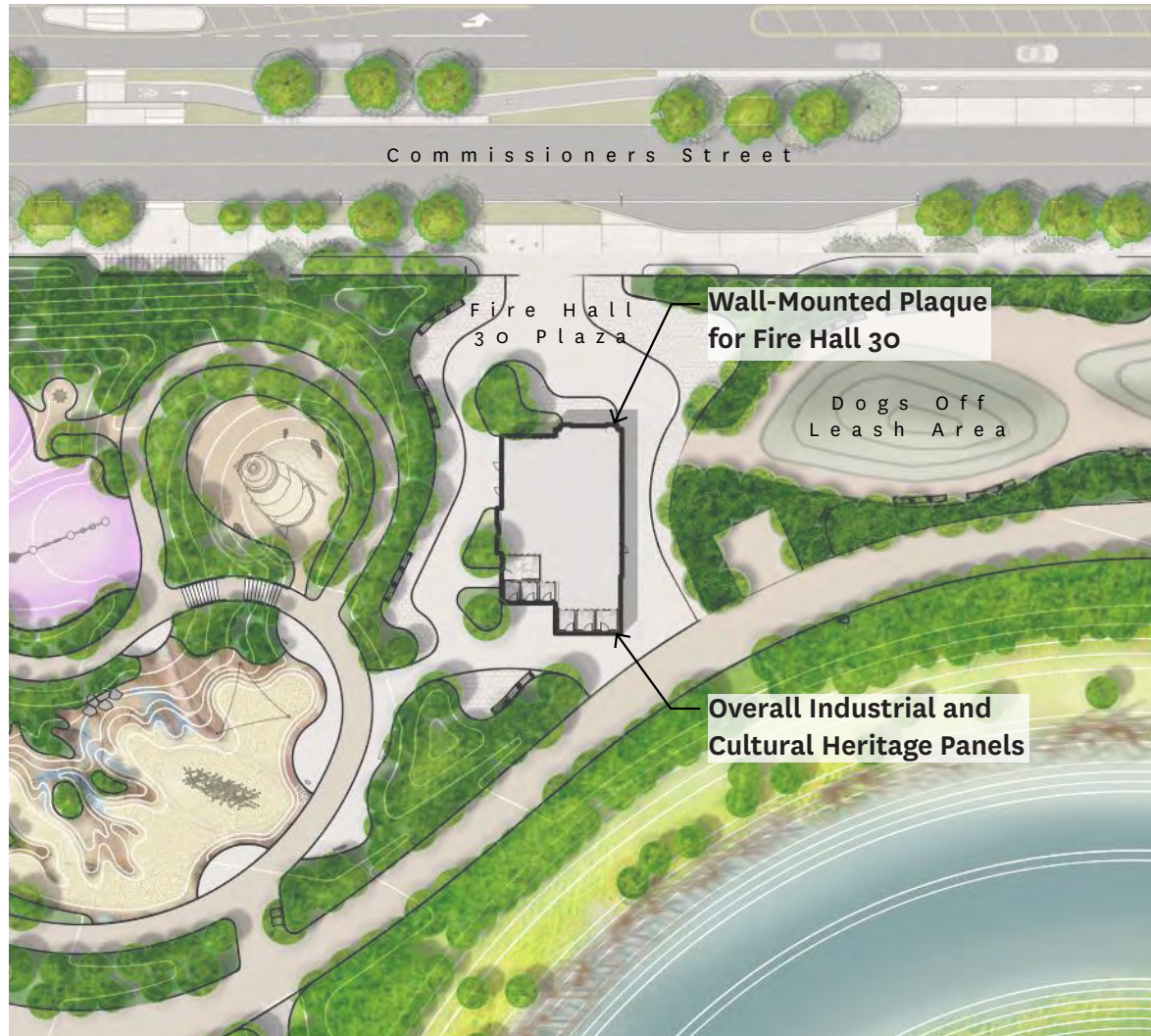

MT-35 - Possible Signage Location

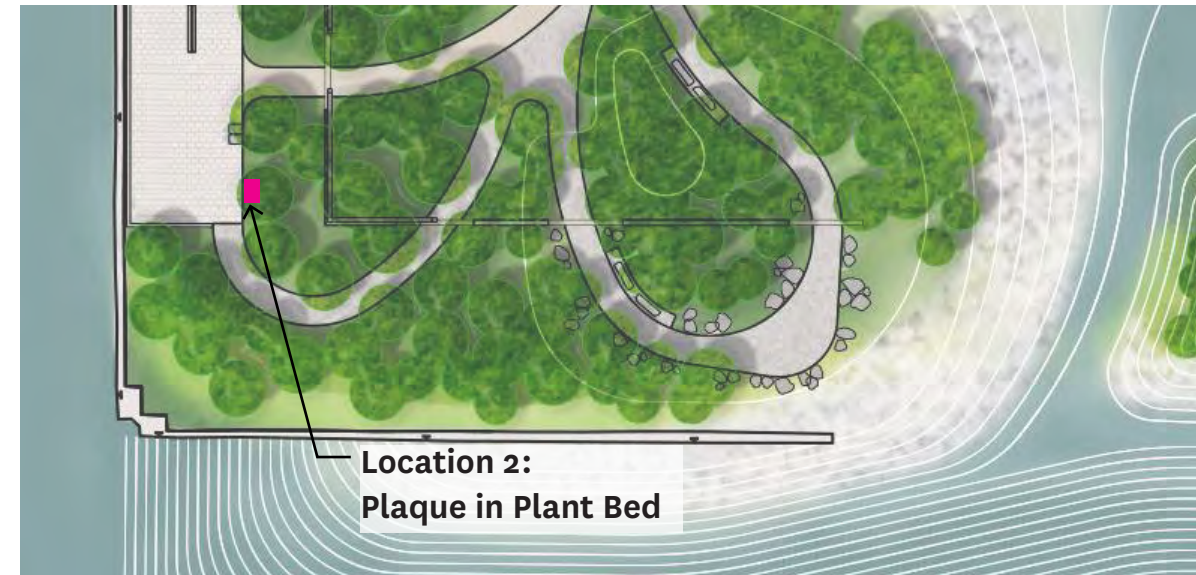
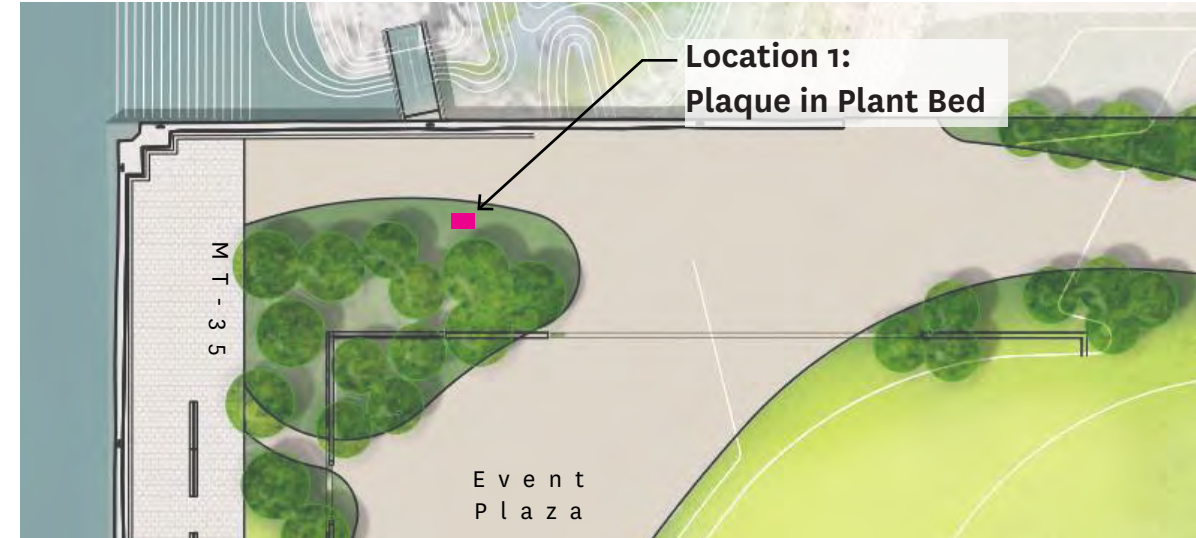

Landscape Interpretive Signage Program: Park Exit Precedents



Berlin
Germany



San Rafael Unido
Urban integration project
Caracas, Venezuela
2010

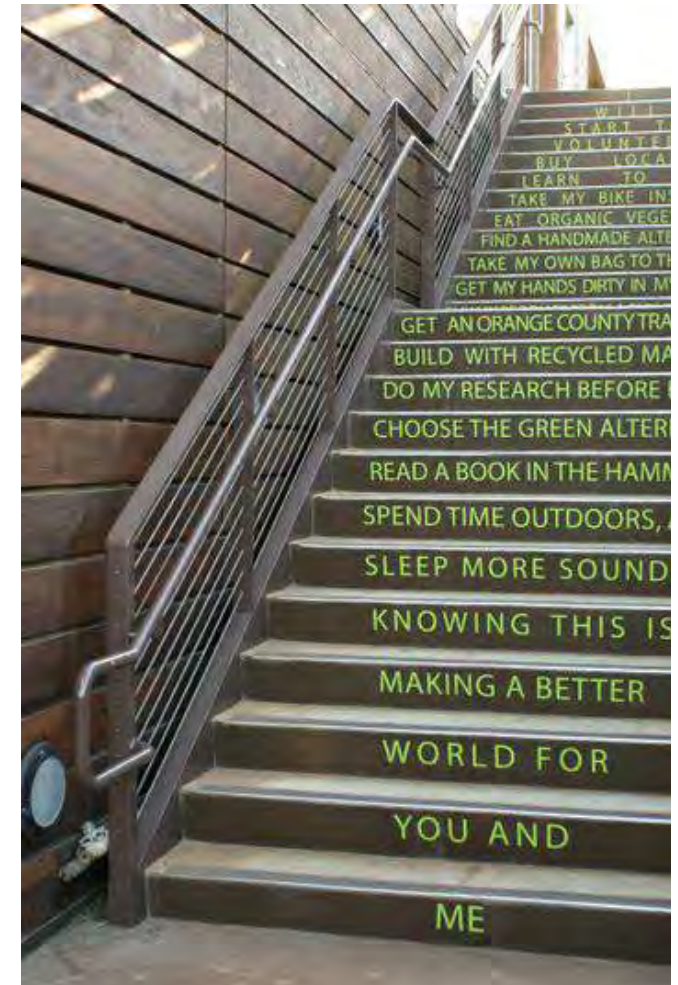

The Camp Retail Campus
Costa Mesa, CA

Landscape Interpretive Signage Program: Park Exits

- Stair risers can display text at eye level as the visitor leaves. The text poses questions that bring what was observed in the park to the front of the mind and resonate with visitors as they reach the street and return to urban life.

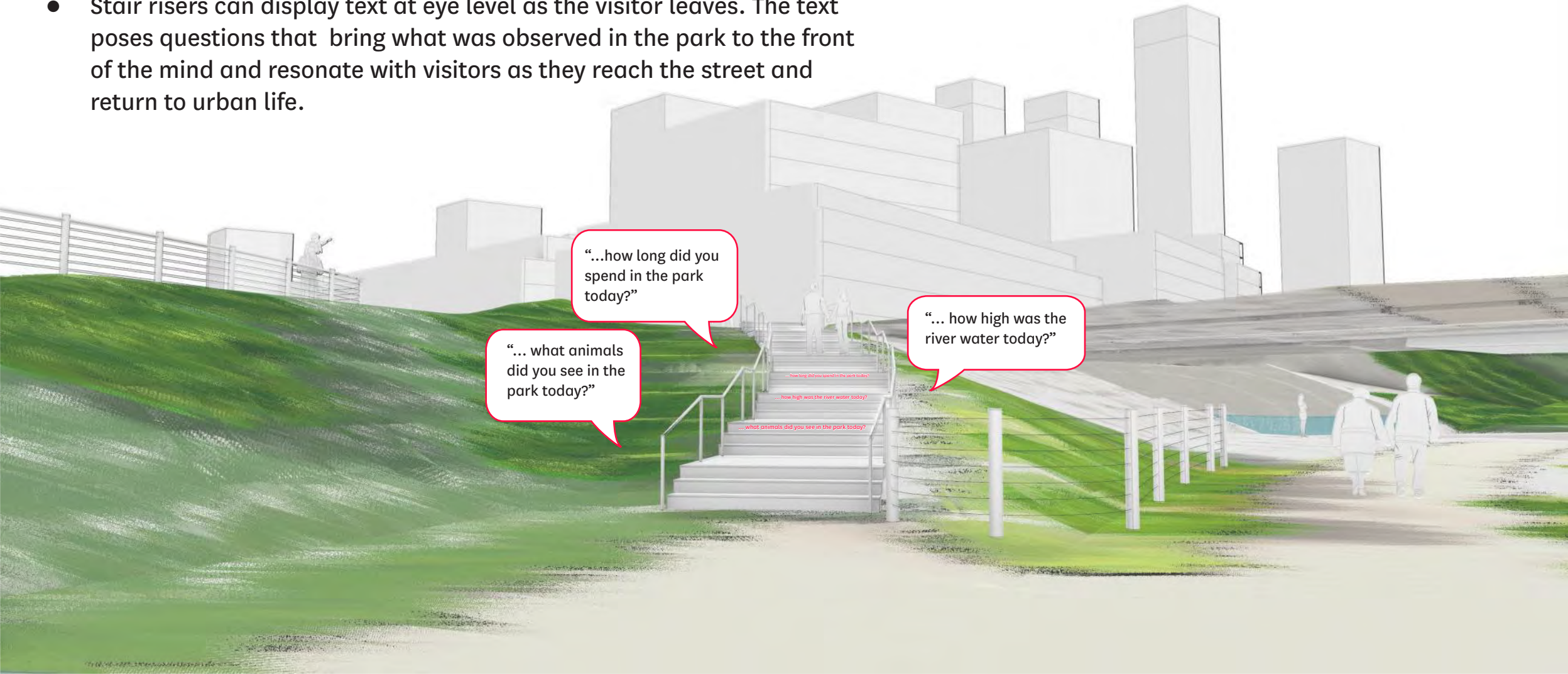

Landscape Interpretive Signage Program: Flood Protection Prospect Precedents



Mississippi Riverwalk
A half-mile contour map of the Mississippi River
Army Corps of Engineers
Memphis, TN



National Aquarium
Exposed agg. concrete pavers in a wave pattern &
stone map depicting Chesapeake Bay Watershed
Rhodeside & Harwell
Baltimore, MD



Landscape Interpretive Signage Program: Promontory

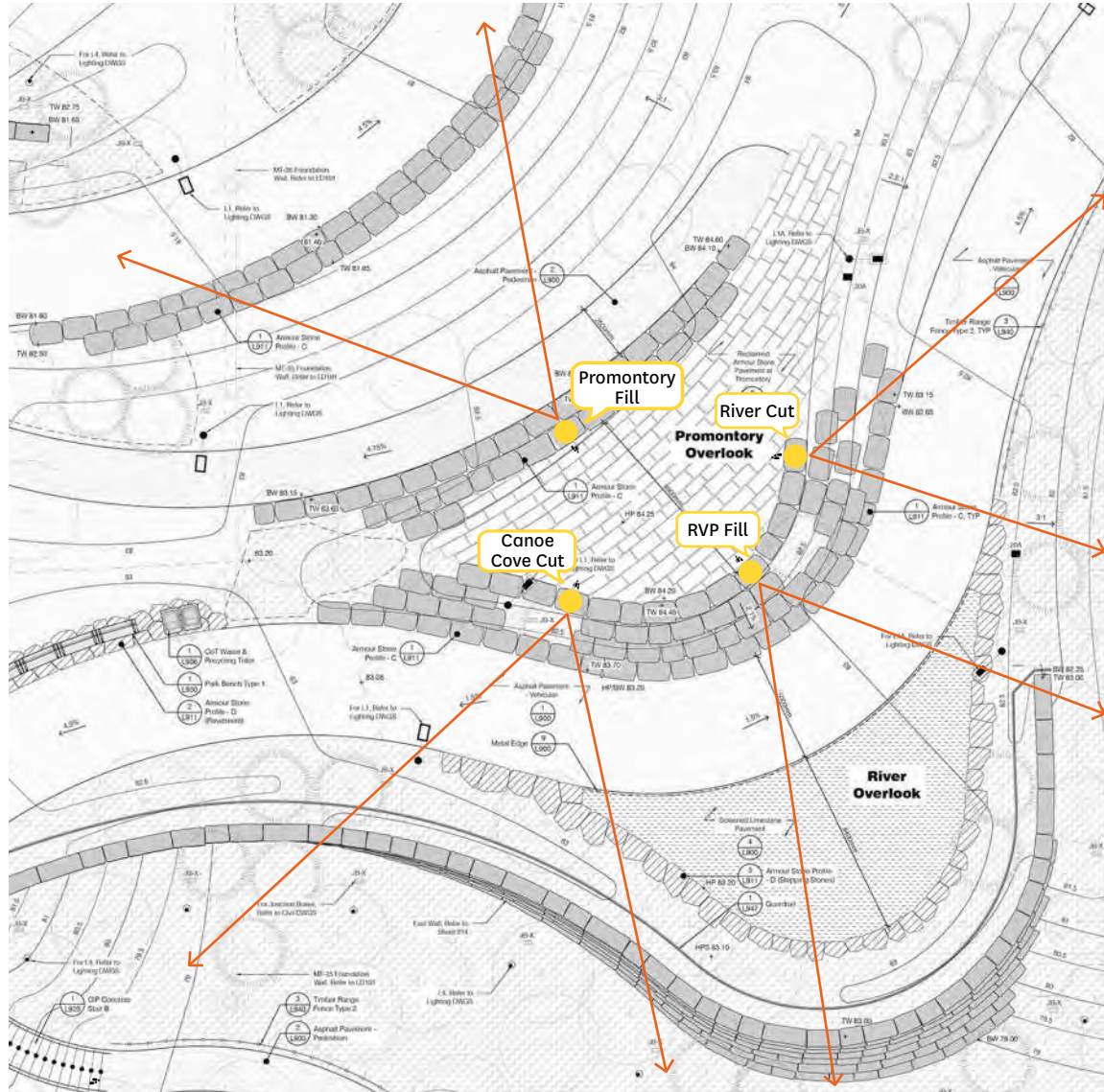

0 3 6M

- The Promontory High Point offers 360 views of the new River Valley and park land. Limestone blocks provide an interface to describe the massive earthwork project that created the high point non which the visitor is standing on

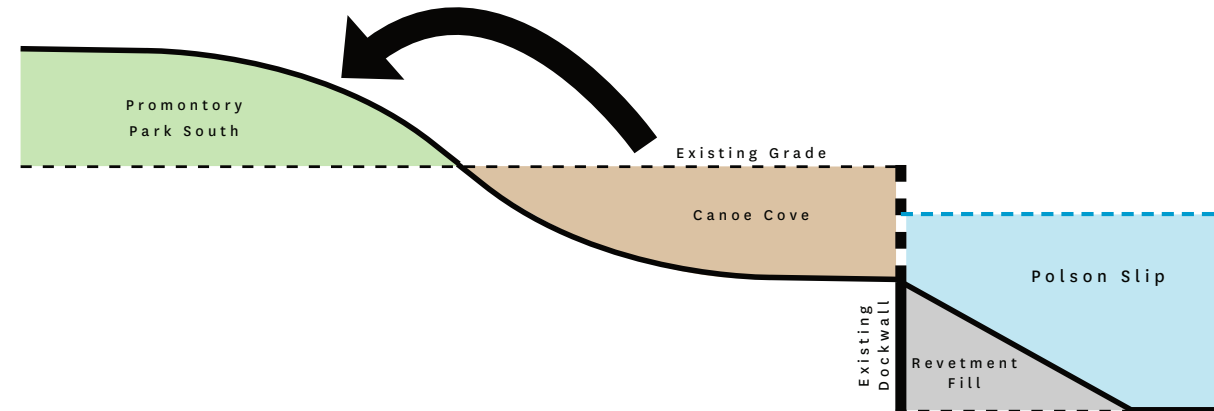

Concept Diagram

0 3 6M

Landscape Interpretive Signage Program: Promontory Precedents



NYC Transit Map
Greene Street, NYC



Public art installation
Dance instructions
Capitol Hill, Seattle



The Present Order is the Disorder of the Future - Saint Just
Ian Hamilton Finlay
Little Sparta (Pentland Hills of Scotland, UK)
1983

Landscape Interpretive Signage Program: River Calendar



Tully Memorial Flood Markers
Logan City Council
Logan River, Australia
2017



Aswan Nilometer
Elephantine Island, Aswan, Egypt

Landscape Interpretive Signage Program: River Calendar

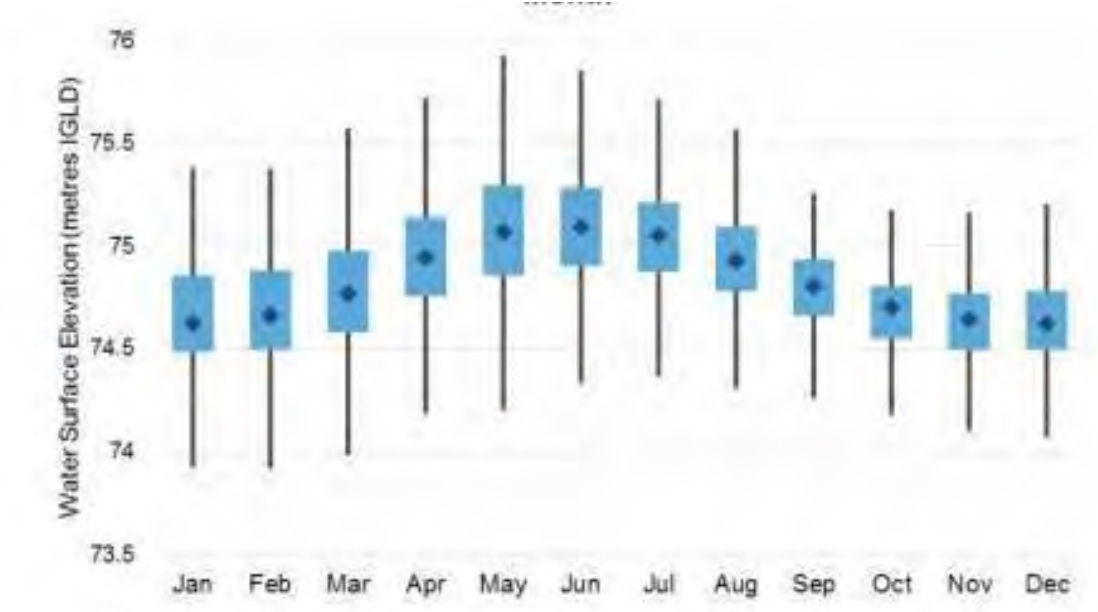
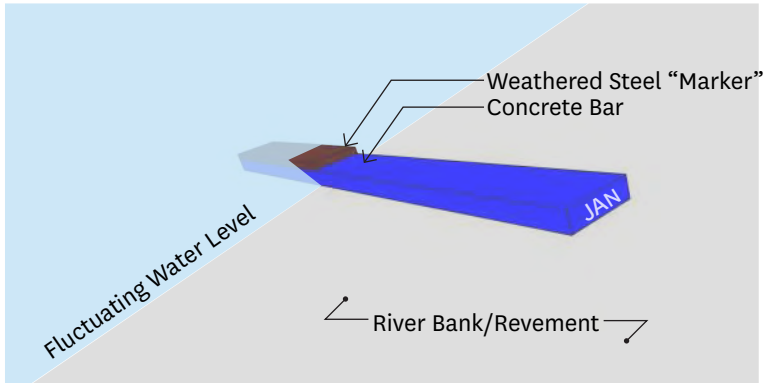
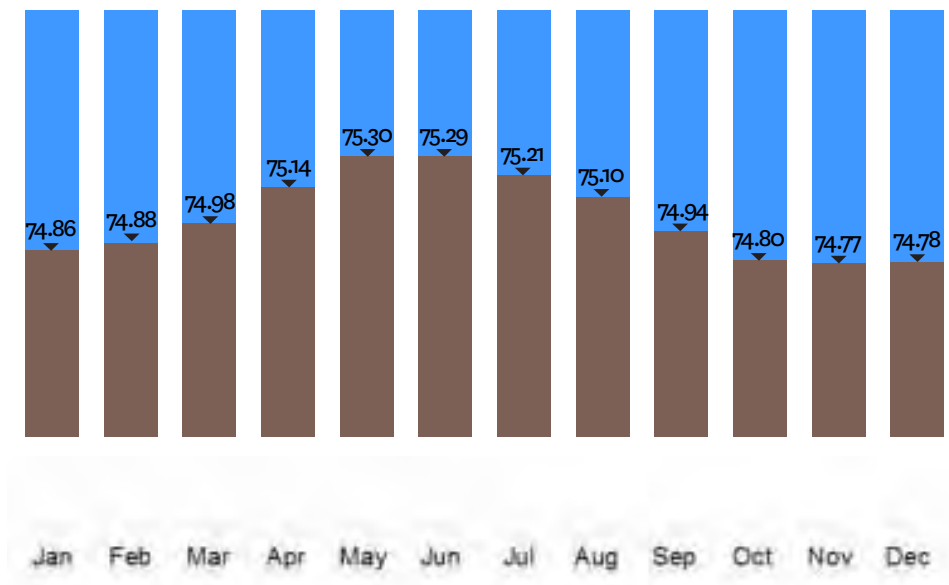

FIGURE 6.20: Monthly boxplots of modeled Lake Ontario-Toronto Harbour WSEs



Concept Diagram

Landscape Interpretive Signage Program: Habitat Scale

Habitat Typologies:

Aquatic: 13 Ha

Wetland: 13 Ha

Terrestrial: 4 Ha

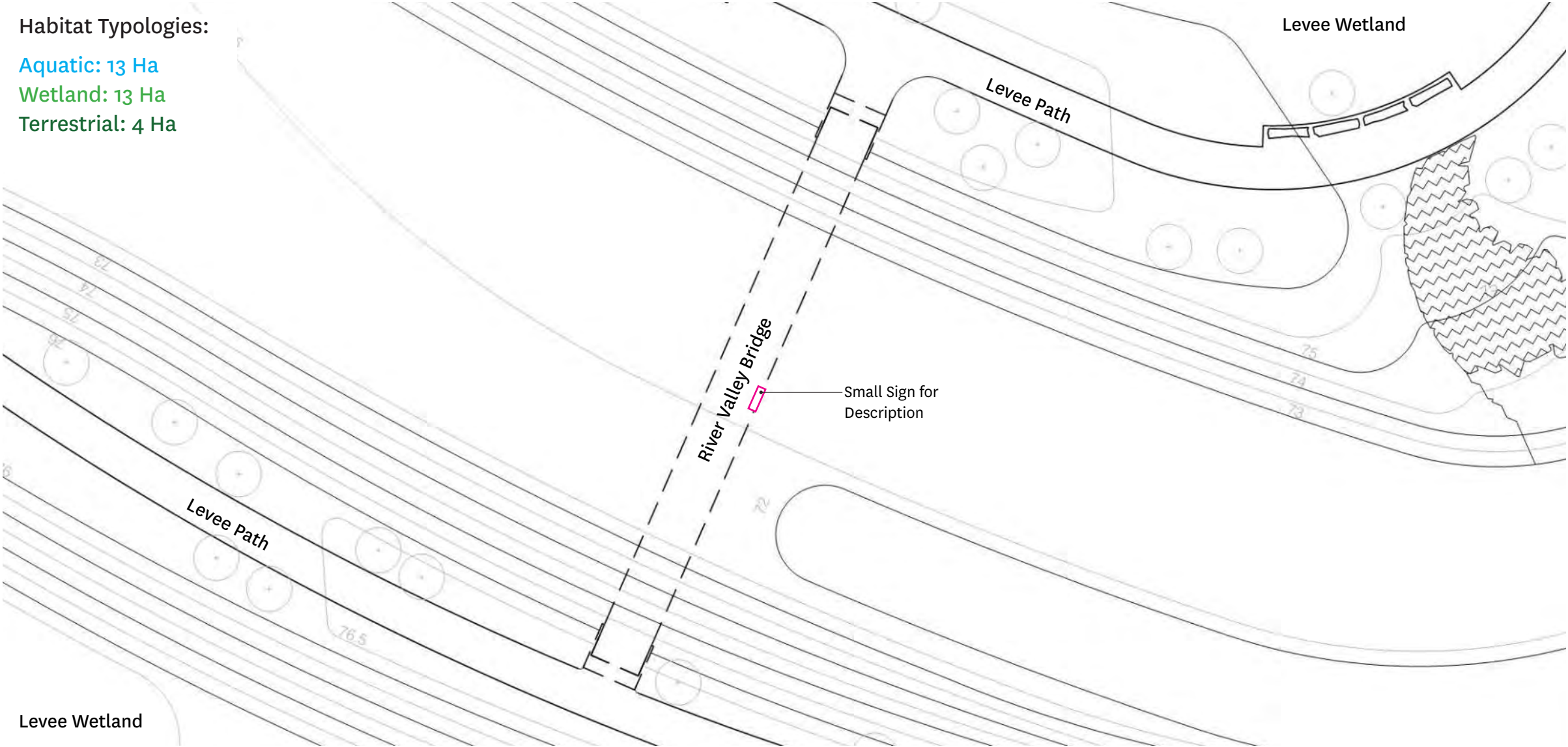

[illegible]

Landscape Interpretive Signage Program: River Timbers



Landscape Interpretive Signage Program: River Timbers



Weir fishing structures and Ontario indigenous practices



Urbanization and the practices in harvesting timber

Landscape Interpretive Signage Program: River Timbers

- These areas of refuge are designed as places to overlook the riverine landscape and are understood as “eco-classrooms” for interpreting the new river mouth. The log seating and mazes are an allusion to tree fall and lag jams typical in woodland-edged river systems. The logs are formed in patterns of eddies from an imagined elevated flood water event. Amidst these logs visitors are invited to climb, sit, play.



Log Features as
an Interface for
Indigenous Culture

Log Features as
an Interface for
Indigenous Culture

Carp Gate Facts: Invasive Carp are kept out of the constructed wetlands with gates to protect habitat and native species

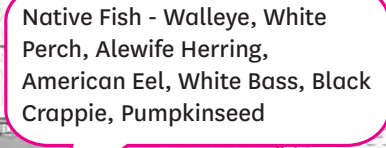
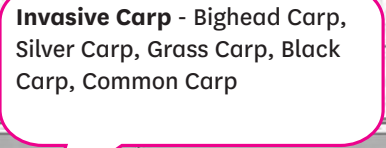

Landscape Interpretive Signage Program: Carp Gate Precedents



*Hull Fish Trail
East Yorkshire, UK*



*Toronto Waterfront Fish
Queens Quay Boulevard
Toronto, ON*

Landscape Interpretive Signage Program: Habitat Heiroglyphs

- The wetland overlooks are explicitly about finding a reflective moment in which the visitor is immersed in the wetland habitat

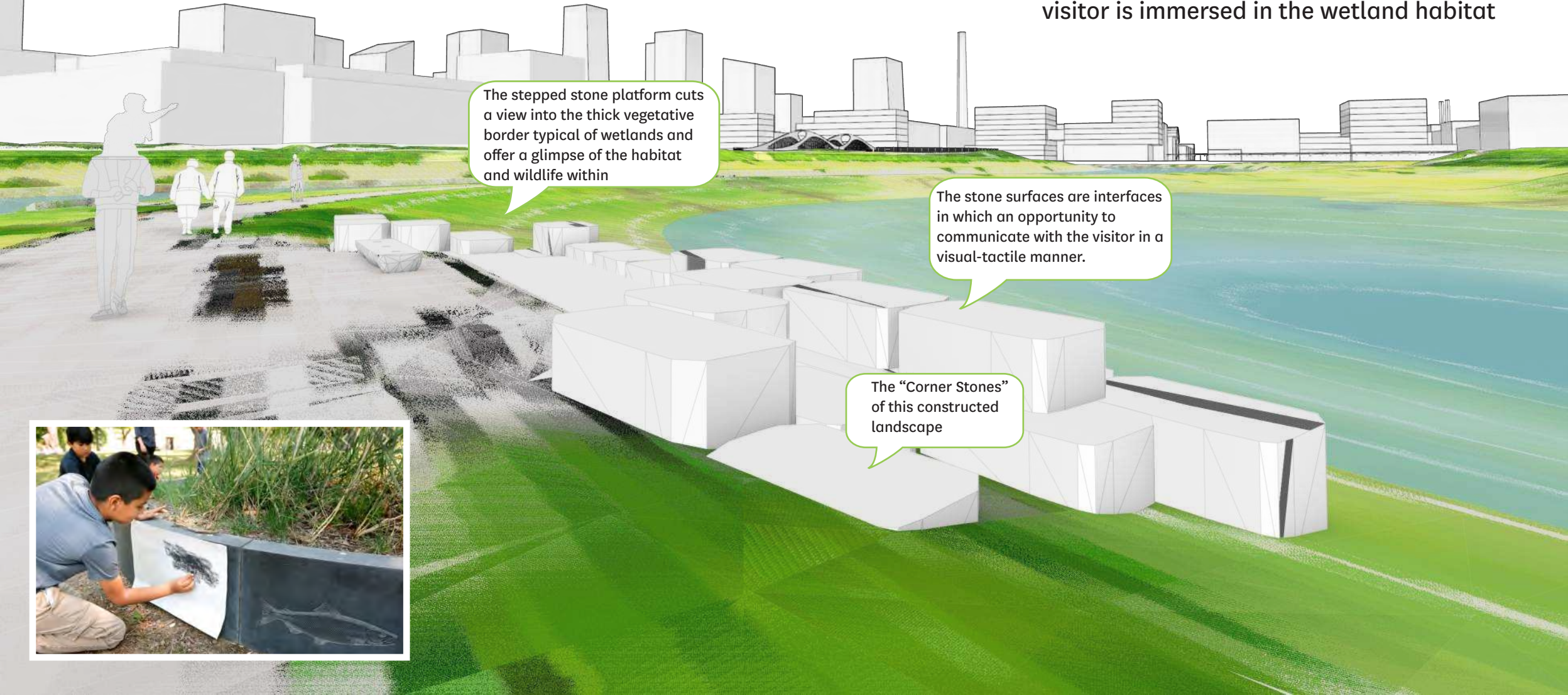

Landscape Interpretive Signage Program: Habitat Heiroglyphs



Historic animal engraving (Antelope)
Taghirt, Tassili n'Ajjer, Algeria
10,000 BCE



Araripegomphus andreneli Dragonfly fossil
Ceara Province, Brazil
Cretaceous period



Aswan Nilometer
Elephantine Island, Aswan, Egypt

Discussion

- Have we identified the right landscape elements to interpret via signage or installations?
- Is there anything you would like the team to consider as we finalize wayfinding signage and locations?

Sediment and Debris Management Area

Existing Conditions



SDMA Interim Conditions (2024)

LEGEND

- Public Realm
- Reserved for Operations
- Lower Don Trail
- Existing Lower Don Trail
- Access Drive/ SDMA
- Boat Ramp
- Interim SDMA
- Harbour Lead Rail
- Reinforced Existing Dockwall

SITE PROGRAM

- Lower Don Trail
- Debris Management (1000m²)
- SDMA Working Area
 - Option for 10,000m³ Sediment Piles
- Access from existing Lake Shore Blvd

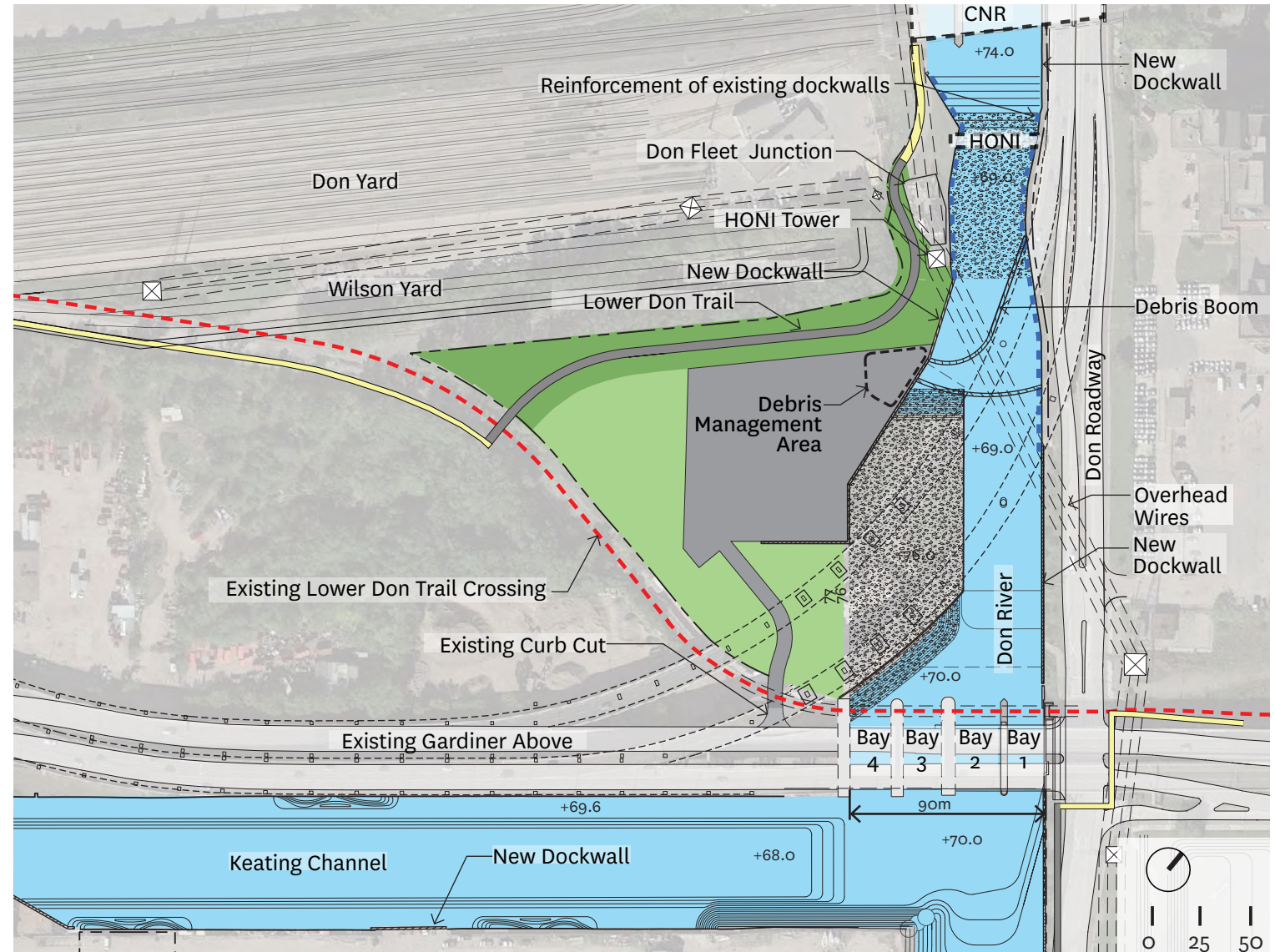

Full Vision

LEGEND

- Public Realm
- Reserved for Operations
- Lower Don Trail
- Existing Lower Don Trail
- Access Drive/ SDMA
- Boat Ramp
- Harbour Lead Rail

SITE PROGRAM

- Lower Don Trail
- Debris Management (1000m²)
- SDMA Working Area
 - Option for 10,000m³ Sediment Piles
- Boat Ramp
- Boat Slip
- Fixed Weir
- Flow Curtain
- Access from realigned Lake Shore Blvd.

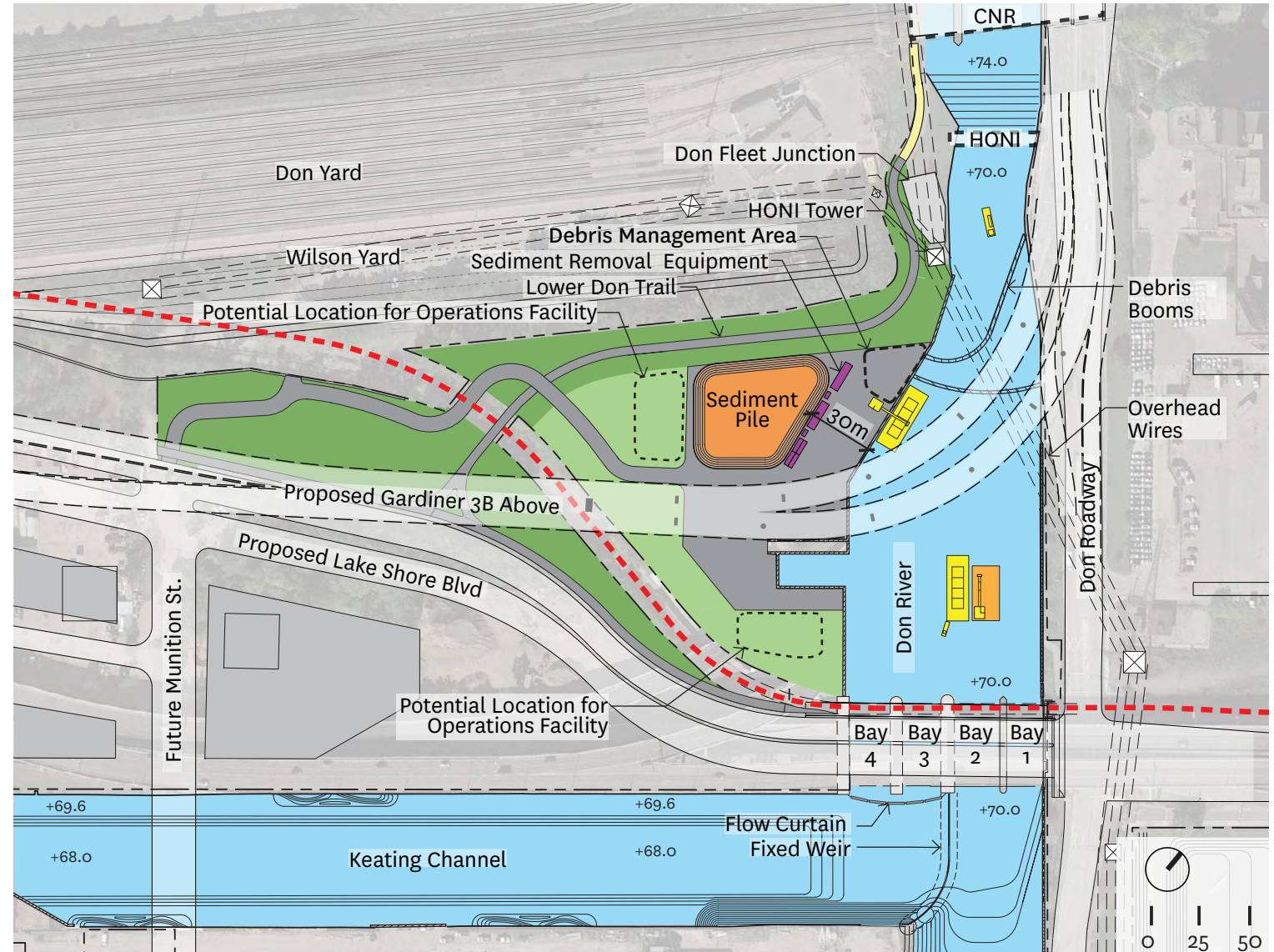

Fixed Weir

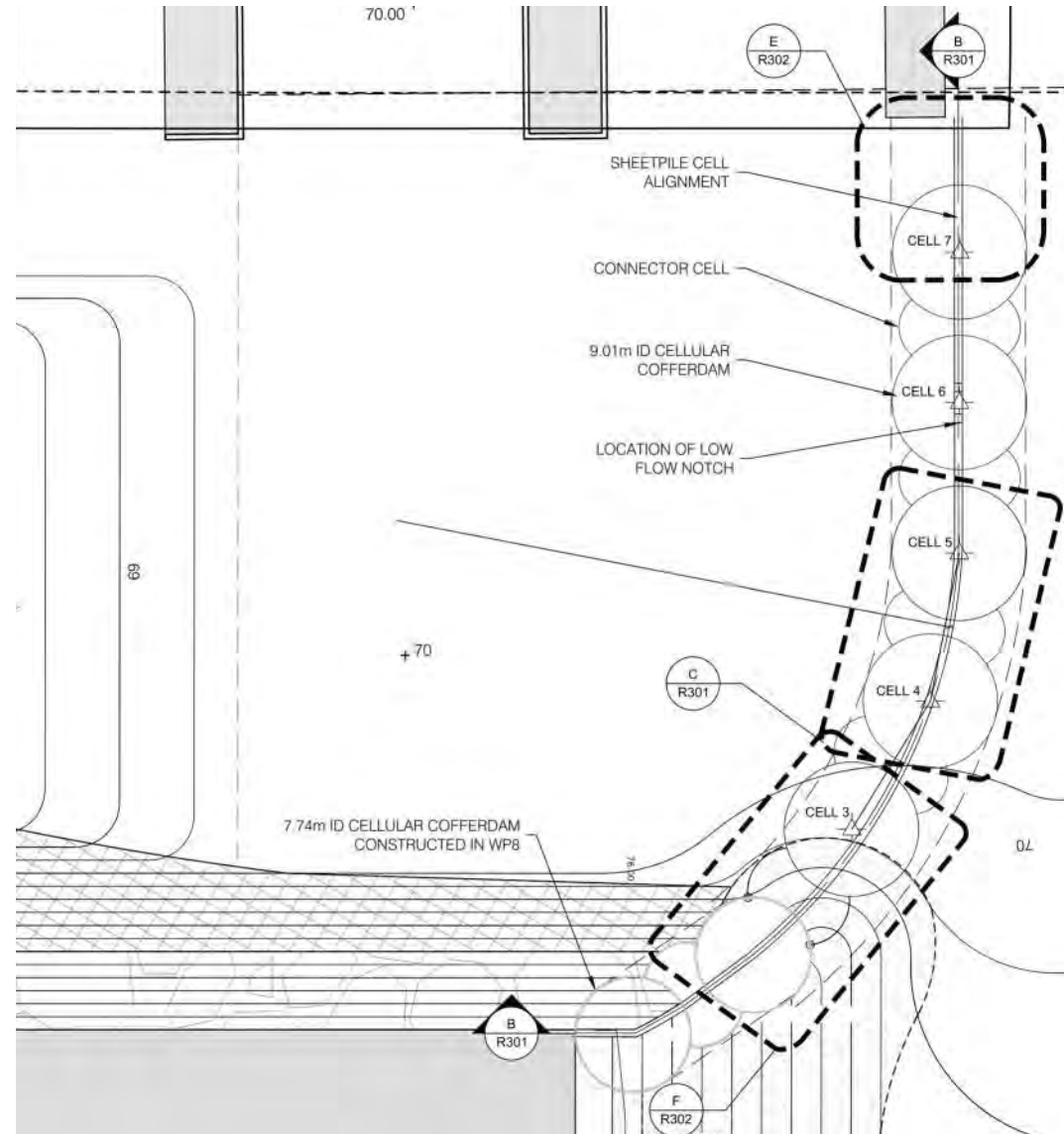

Flow Curtain

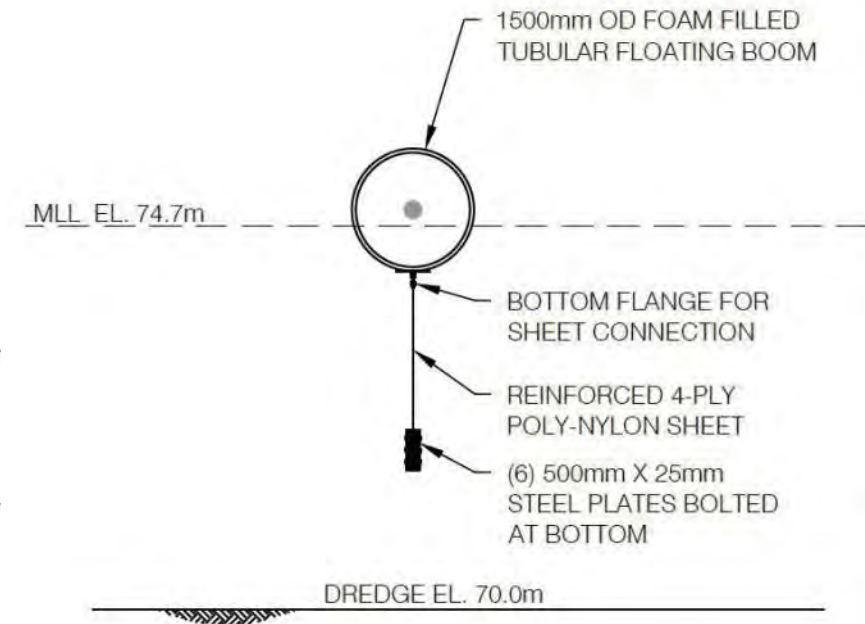
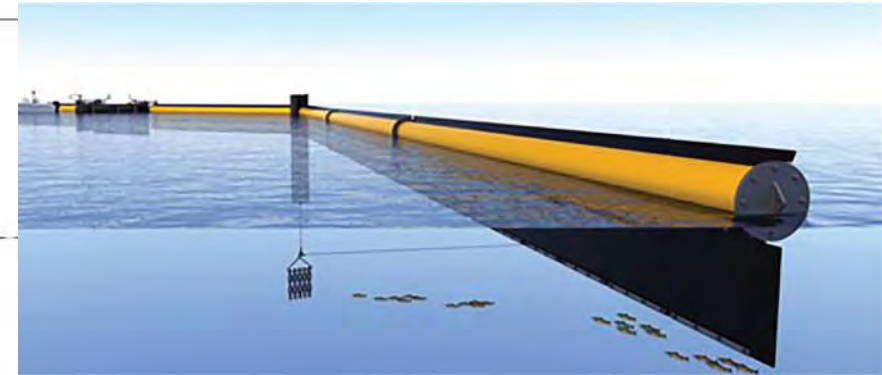
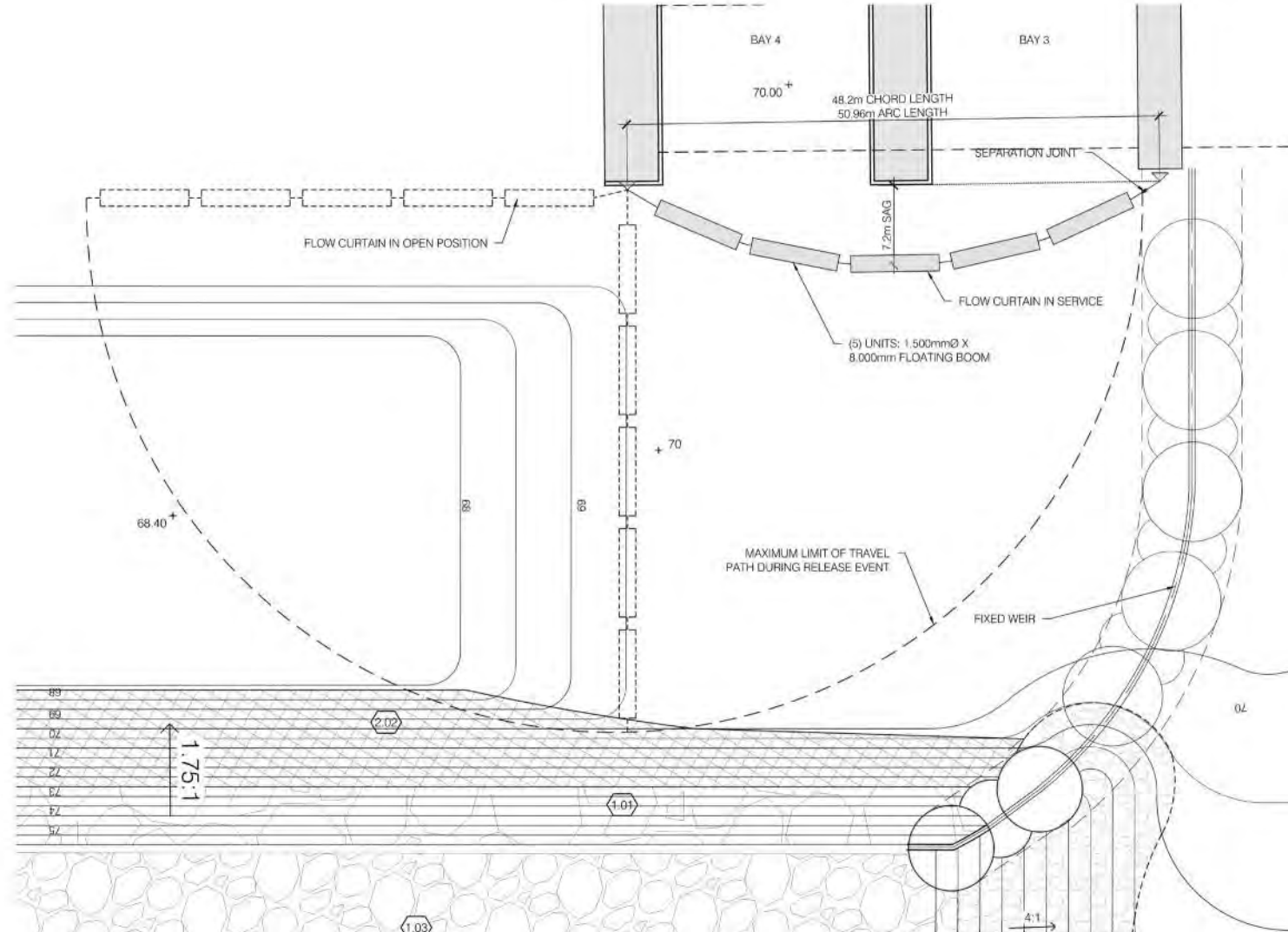

Existing Dredge Scow + Dredge Barge



Sediment Management: Anticipated Equipment

Dredge Barge

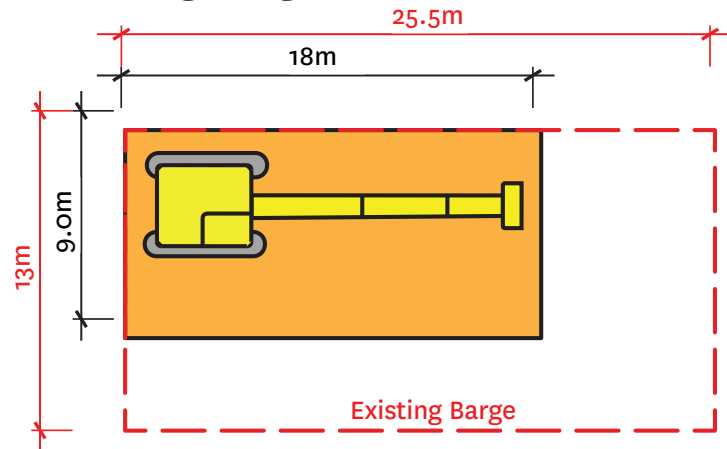

Jon Boat

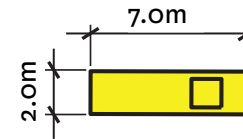

Dump Scow

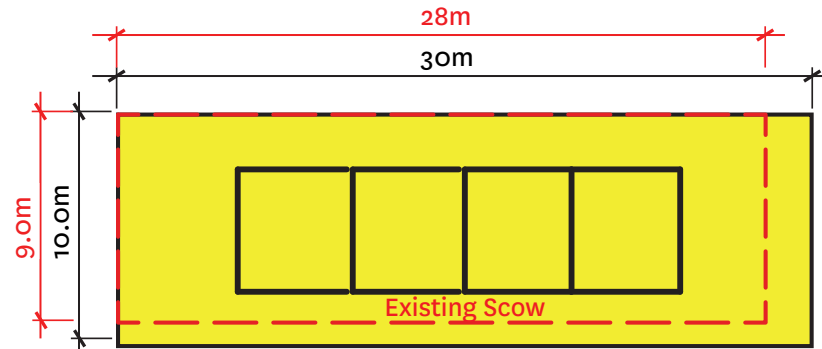

Excavator

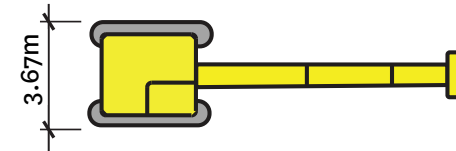

Other Equipment

Debris Booms



Material Storage Bins



Flow Curtain

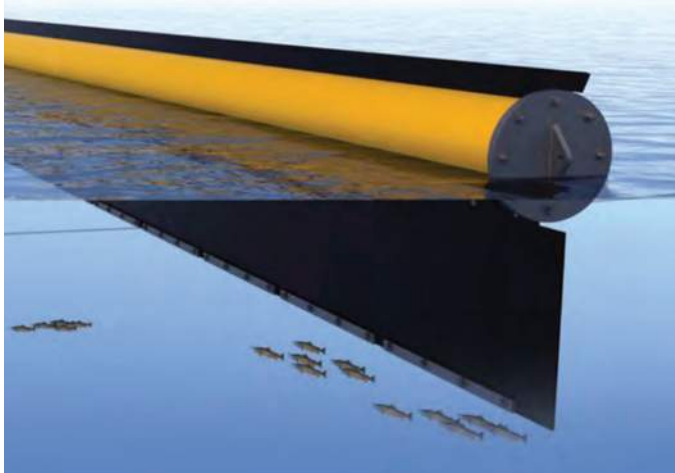

Discussion

- Does this material address the SAC's questions or concerns about the Sediment and Debris Management Area?

Upcoming Public Meeting

Where are we now?

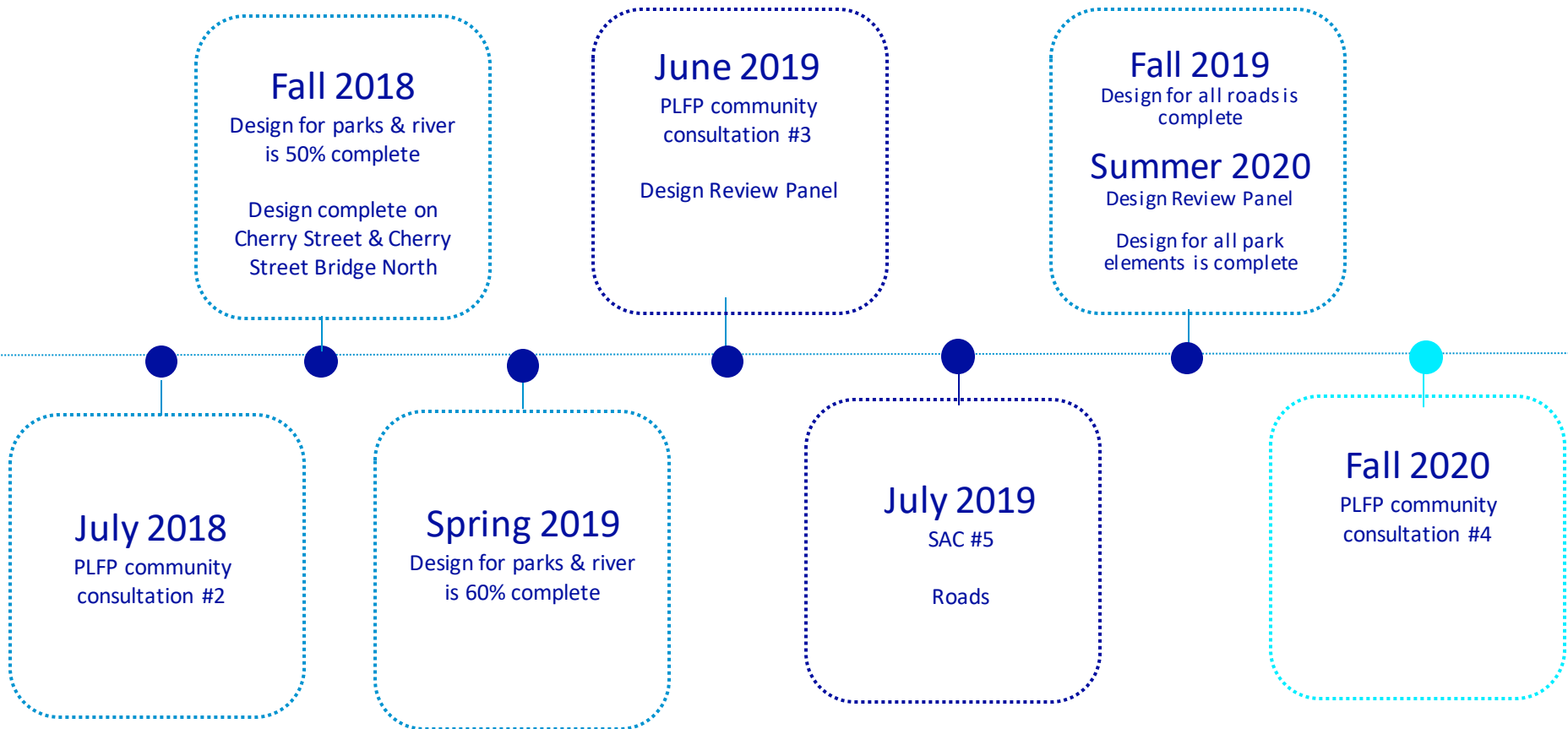

How will we meet online?

- Waterfront Toronto proposes a phased approach to introducing online public engagement for all existing and future projects during the COVID-19 pandemic.
- The three phases can be rolled out immediately and phased in over the next 2 to 8 months.
- **Phase 1:** *Continuity, Mitigation, Testing (<2 months)*
- **Phase 2:** *Advance Engagement (>2 months)*
- **Phase 3:** *Ongoing Engagement on New Projects (8+ months)*

Phase 1: Continuity, Mitigation, Testing

Timeframe: <2 months

Goal: Transition all existing stakeholder meetings online

- Ensure current standards for in-person engagement are retained
- Mitigate barriers to participation

Platform: Microsoft Teams

- Telephone call-in to Teams meeting (audio only)
- Captioning currently in Beta

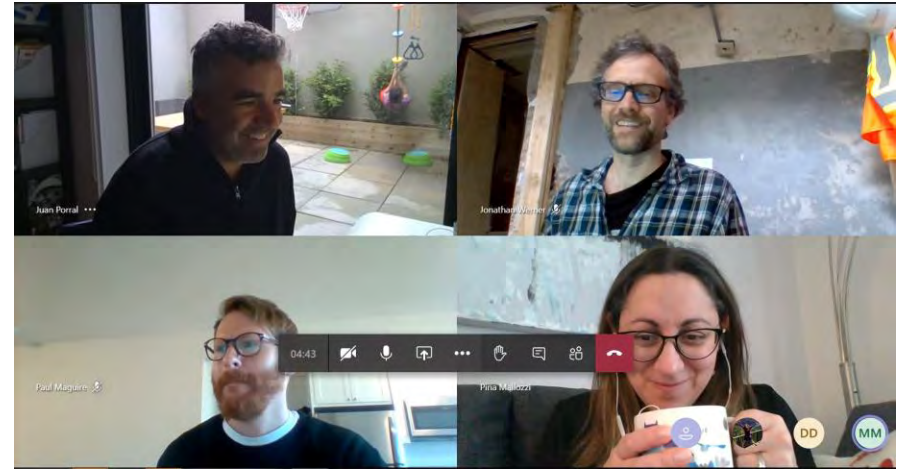

Phase 2: Advance Engagement

Timeframe: > 4 months

Goals: Building on Phase 1, introduce flexibility by letting participants engage with materials advance of scheduled meetings.

Platform: Microsoft Team (live meeting)

- Web browser
- Telephone
- Mobile application
- WT Project website houses materials

marine use strategy



[← return to explore projects](#)

Waterfront for Everyone: Updating the Marine Use Strategy

To take Toronto's waterfront to the next level of revitalization, Waterfront Toronto plans to build on the existing connections around the harbour. In collaboration with City of Toronto, Ports Toronto, Toronto and Regional Conservation Authority, we're updating the Marine Strategy and Implementation Plan for Toronto's waterfront.

The draft *Marine Use Strategy* was released over ten years ago. A lot has changed on the waterfront since then. As revitalization progresses, this update will ensure that Toronto's waterfront maintains a balance of commercial shipping, recreational boating and water-based recreation.

Once complete, the *Marine Use Strategy* will be used to guide the planning and design of shoreline developments.

How can you get involved?

This study is just getting started. We anticipate two public meetings as part of the process:

- **Public Information Centre #1:** February 3, 2020 (presentation, display boards and feedback form from the meeting are [here](#))
- **Public Information Centre #2:** Spring 2020*

** please note date subject to change*

Sign-up for the Waterfront Toronto newsletter to make sure you get updates about this project.

Questions? Email us at info@waterfronttoronto.ca.

quick facts

Location: A detailed review of existing opportunities and constraints is underway and is primarily focused on the marine users located in the Inner Harbour area.

Project Team: Waterfront Toronto, together with the City of Toronto, Ports Toronto, and Toronto and Region Conservation Authority.

Consultant Team: WSP Canada Group

related events

Public Information Centre
February 3, 2020
[VIEW DETAILS](#)

Related Documents

- Summary Report - Marine Strategy Update
Public Information Centre - February 3, 2020
- Presentation - Marine Use Strategy Update
Public Information Centre - February 3, 2020
- Display Boards - Marine Use Strategy Update
Public Information Centre - February 3, 2020
- Waterfront Toronto Rolling Five-Year Strategic Plan - 2020/21 - 2024/25

Phase 2: Advance Engagement

Opportunities for flexible forms of engagement

Available online two weeks in advance of scheduled live meetings:

- Presentation decks
- Related studies
- Recording of verbal presentations
- Online surveys linked to presentations

Live Meeting would include:

- Summary of longer presentation
- Focus on Q+A/receiving feedback
- Additional opportunity to fill out online survey

Phase 3: Continuous Engagement

Timeframe: 8+ months

Goals: Augment traditional approach delivered in Phase 1-2 to create more collaboration and flexibility.

- Ensure current standards for traditional engagement are retained
- Mitigate barriers to participation

Platform:

Community-driven online tool would include:

- Surveys
- Chat functions
- Mapping
- Form responses
- Quick polling
- Q+A

Appendix

Proximity of Dogs Off-Leash Area to Future Neighbourhood

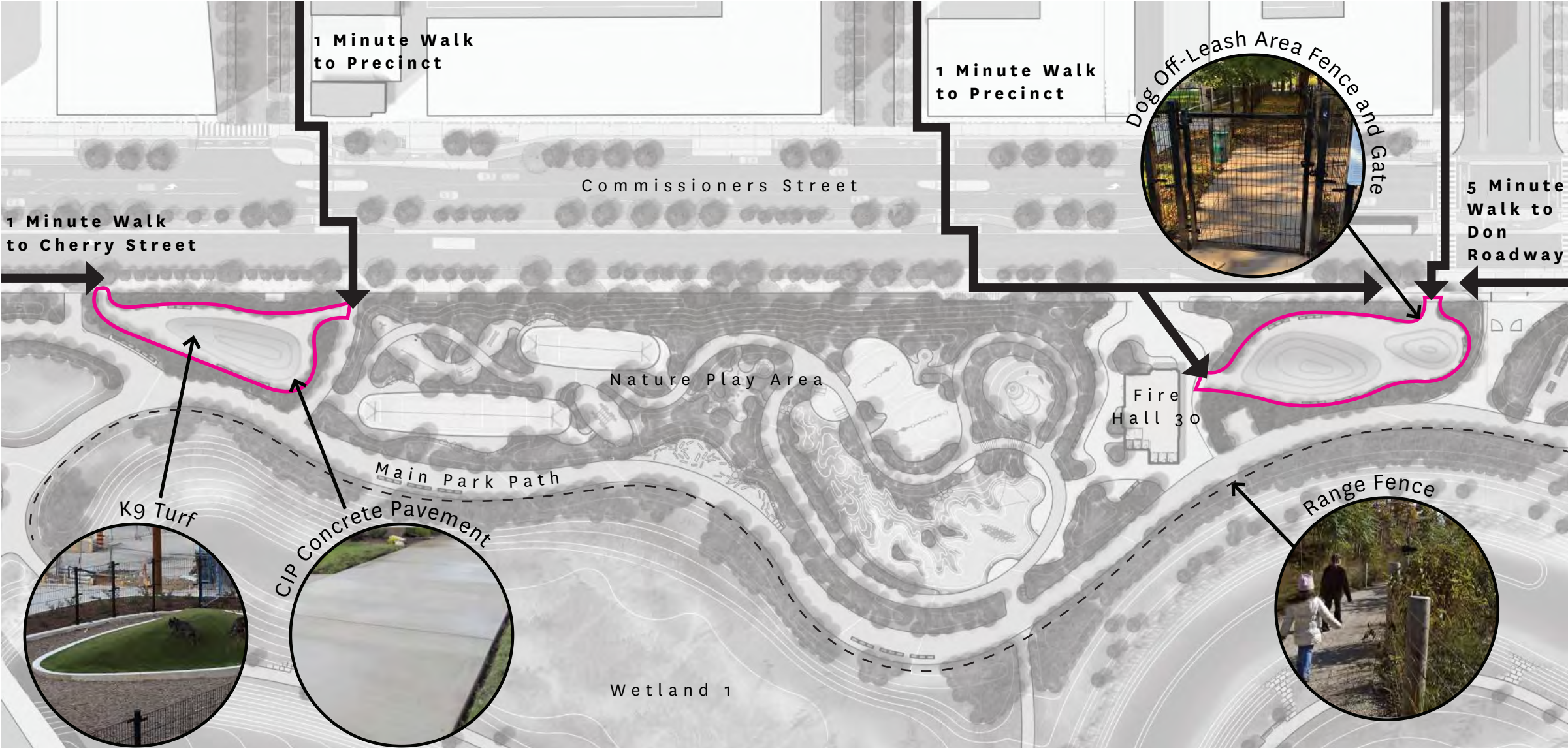

Full Vision



Event Lawn - Diagram

