

**PORT**

**2024**

**March 19, 2021**

# Port Lands Flood Protection LUAC #4

**LANDS**

Canada

 Ontario

 **TORONTO**

  
WATERFRONTToronto

# Agenda

- Introduction
- Project Updates
- Final Update: Design for PLFP roads
- Report back from Lake Shore Boulevard East public meeting

# **Introductions + Teams Instructions**

# Teams 101 – Joining on a Computer

- Turn your camera on if you're comfortable
- Click the microphone icon to mute yourself when you're not speaking
- Troubleshooting: use the chat window to note any issues
- "Raise your hand" to ask a question or make a comment

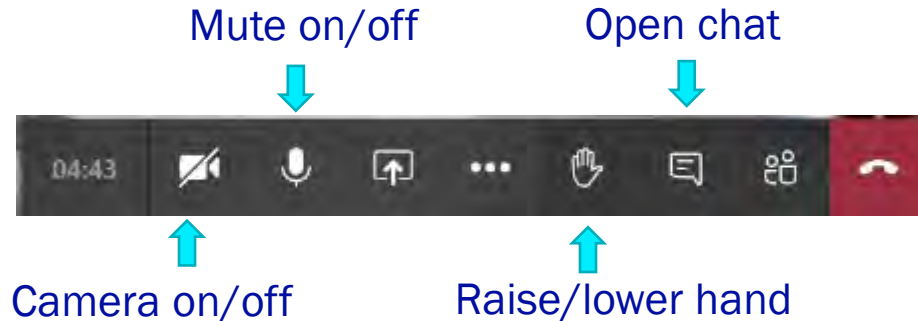



# Teams 101 – Joining via Telephone

- To mute/un-mute yourself, press \*6
- Mute yourself when you're not speaking
- Let us know if you can't hear or you can't tell which slide is being presented
- We'll open the floor to your questions/comments once all hands are down

# Introductions

- We'll go through the list of attendees (usually in alphabetical order)
- Please introduce yourself and the organization you represent

# **Construction Progress**

# Construction Progress



# Rocky Radar – Progress Reports via @TheRockRipper

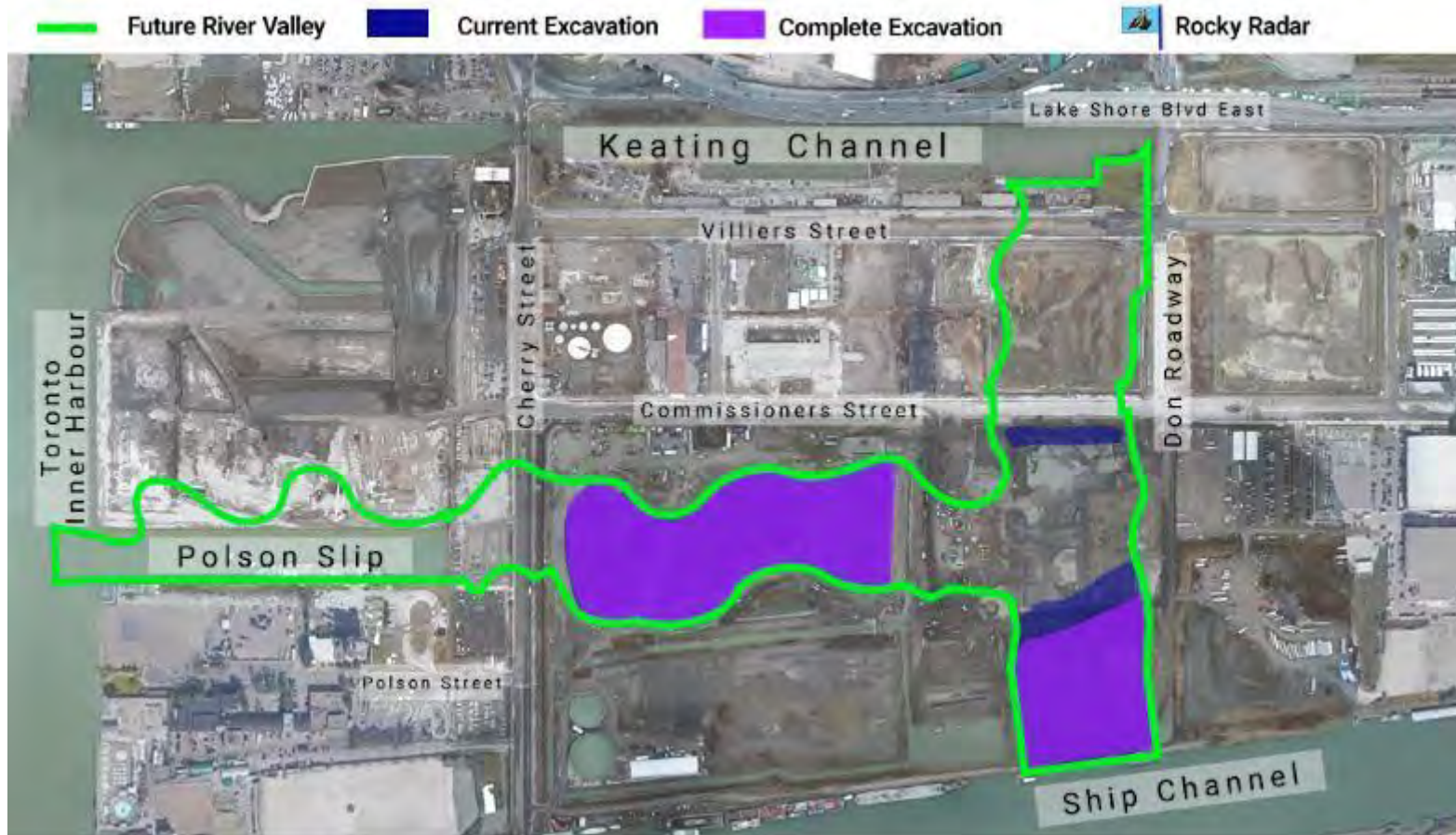

# Rocky Radar – Progress Reports via @TheRockRipper





# Aerial View

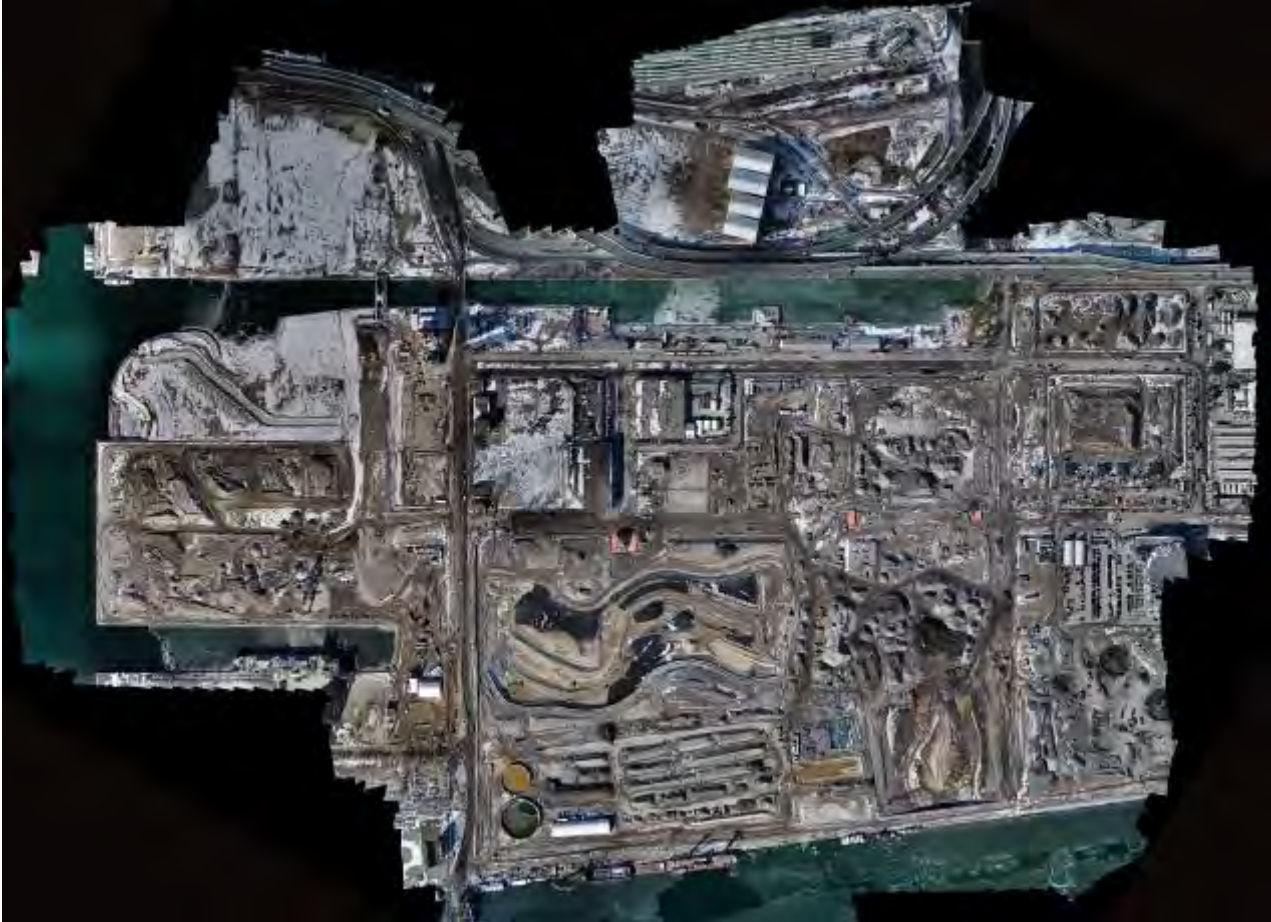

# Central River Valley Excavation Complete





# Central River Valley Reactive Treatment Layer



# Don Greenway/Spillway Excavation





# Cherry Street Fill and Surcharge



# Commissioners Street Fill and Surcharge





# Commissioners Street Bridge Foundations



# Diaphragm Wall Construction





## Port Lands Flood Protection: Reclaimed MT-35 Girders

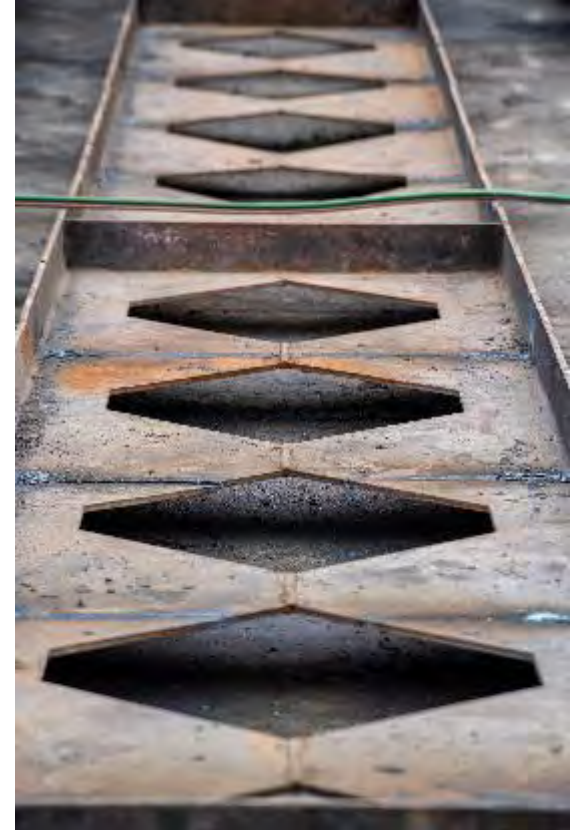

# Where are we now?

Fall 2018

Design for parks & river is  
50% complete

Design complete on  
Cherry Street & Cherry  
Street Bridge North

June 2019

community consultation  
#3

Fall/Winter  
2020

SAC #6

Design for all roads  
is complete

Oct./Nov. 2020

SAC #8 & 9  
LUAC #3  
Public Meeting #4

Spring 2019

Design for parks & river is  
60% complete

Summer 2019

SAC #5

Spring/Summer  
2020

SAC #7

Design for all park  
elements is complete

March 2021

SAC #10  
LUAC #4



# A New River Innovation Challenge

- **How do we collect and share environmental data** from these new ecosystems to encourage conservation and behavior change in the wider community?
- **Live Q & A Sessions** to inspire ideas for the challenge:
  - March 18, 7-8pm: **Earthworks and Geotechnical** (WT & Geosyntech)
  - March 23, 7-8pm: **Park Design** (MinoKamik & MVVA)
  - March 24, 7-8pm: **Water & Aquatic Species** (Interfluve & TRCA)

**See-Yin Lim, DTAH**

# THREE STREETS FOR THE PORT LANDS

Today's presentation will focus on adjustments made to **Cherry Street** and **Commissioners Street** to accommodate the deletion of the BRT lanes.





STREET CHARACTER

CHERRY STREET



Urban Street

COMMISSIONERS STREET



Park Street

DON ROADWAY



River Street



# CHERRY STREET | Comparing Plans

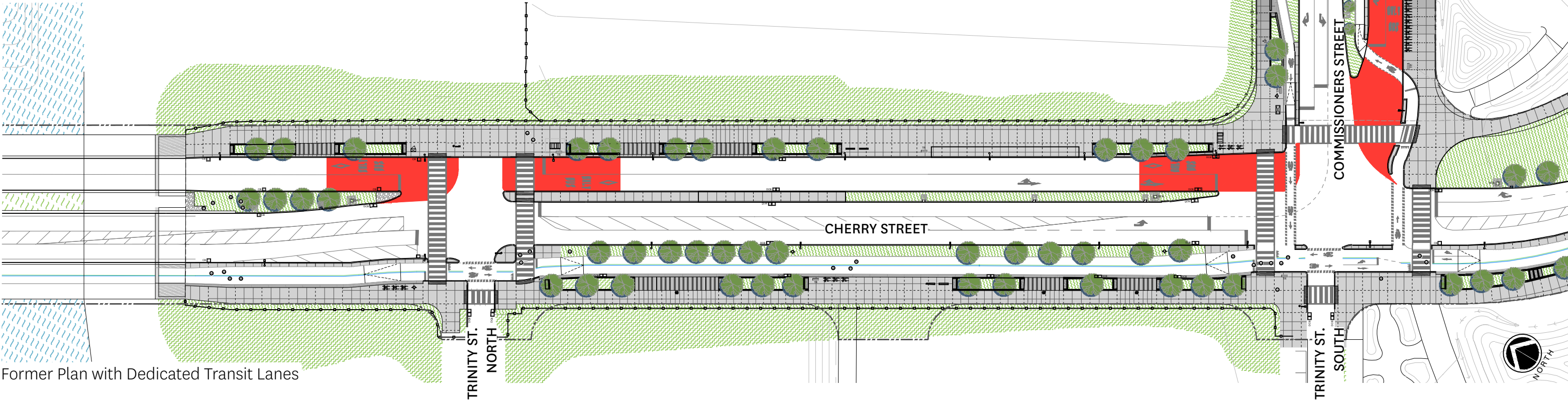

Former Plan with Dedicated Transit Lanes

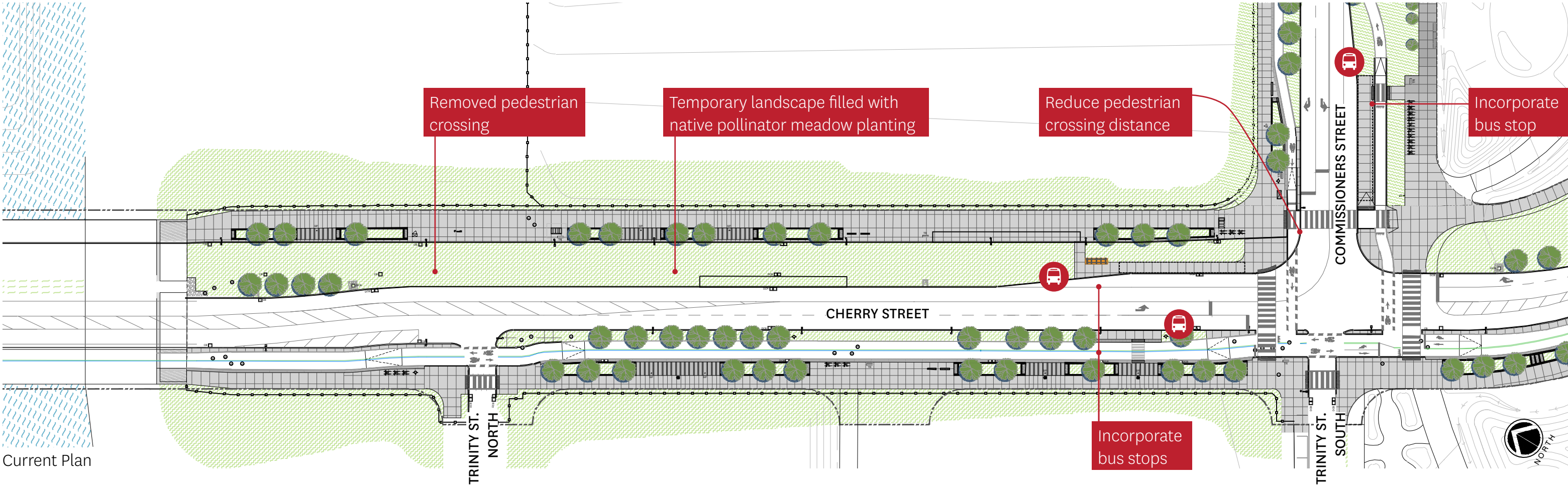

Current Plan



# COMMISSIONERS STREET | Comparing Plans

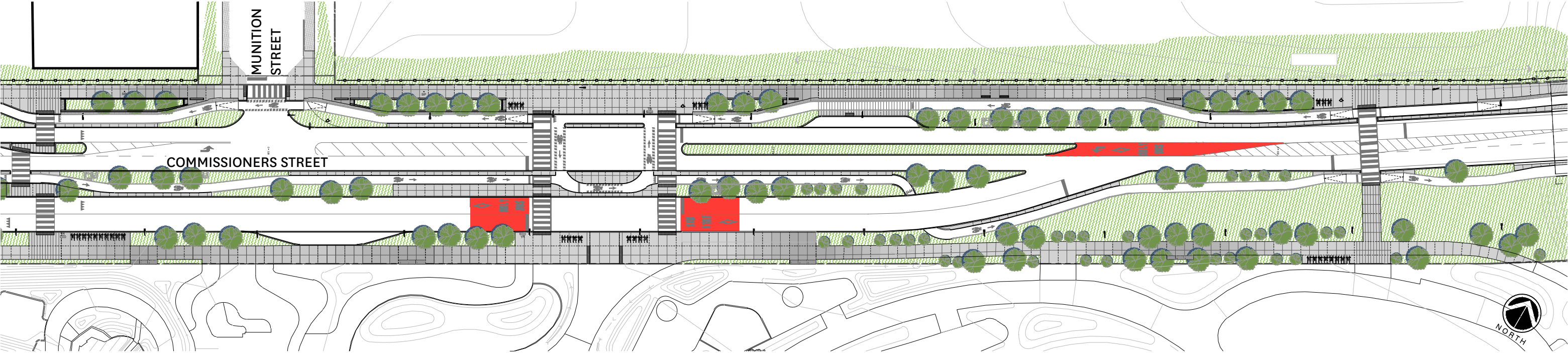

Former Plan with Dedicated Transit Lanes

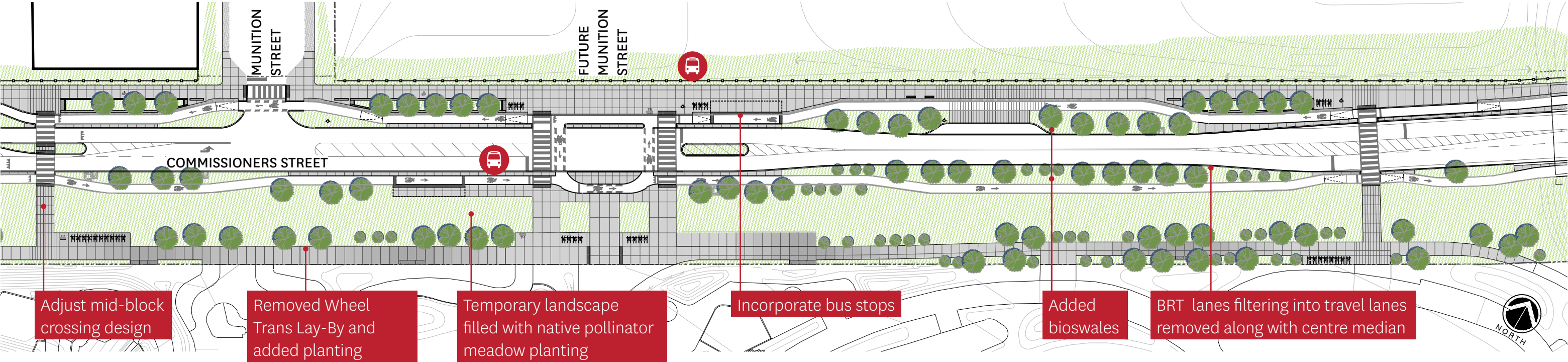

Current Plan



COMMISSIONERS STREET SECTION

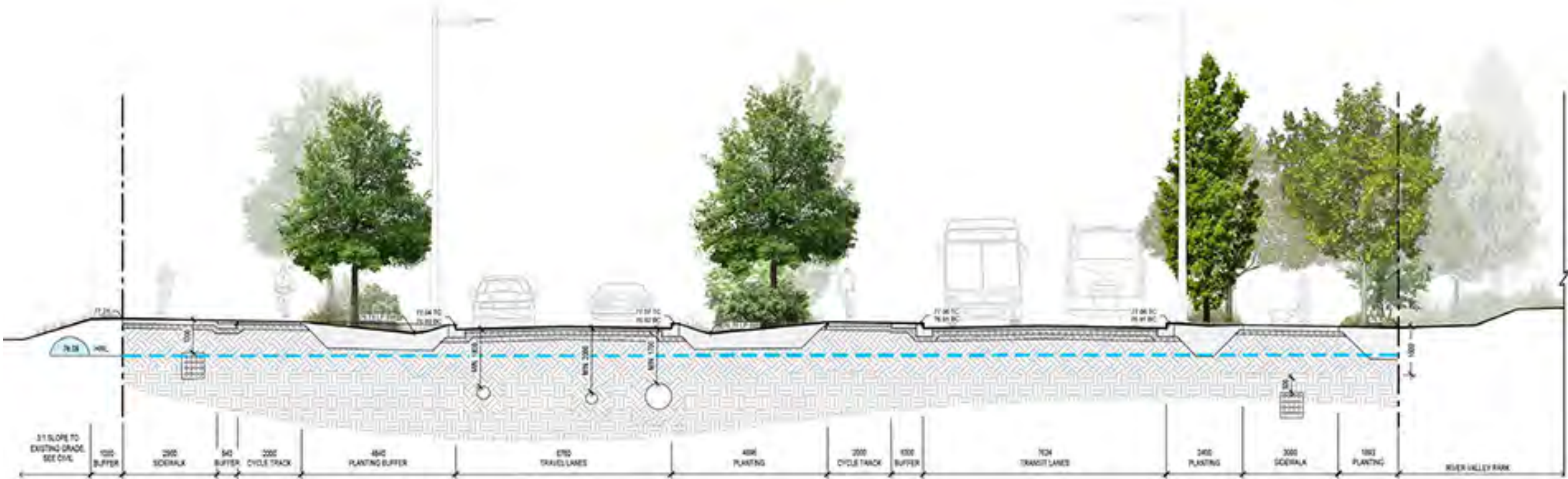

Former Section with Dedicated Transit Lanes

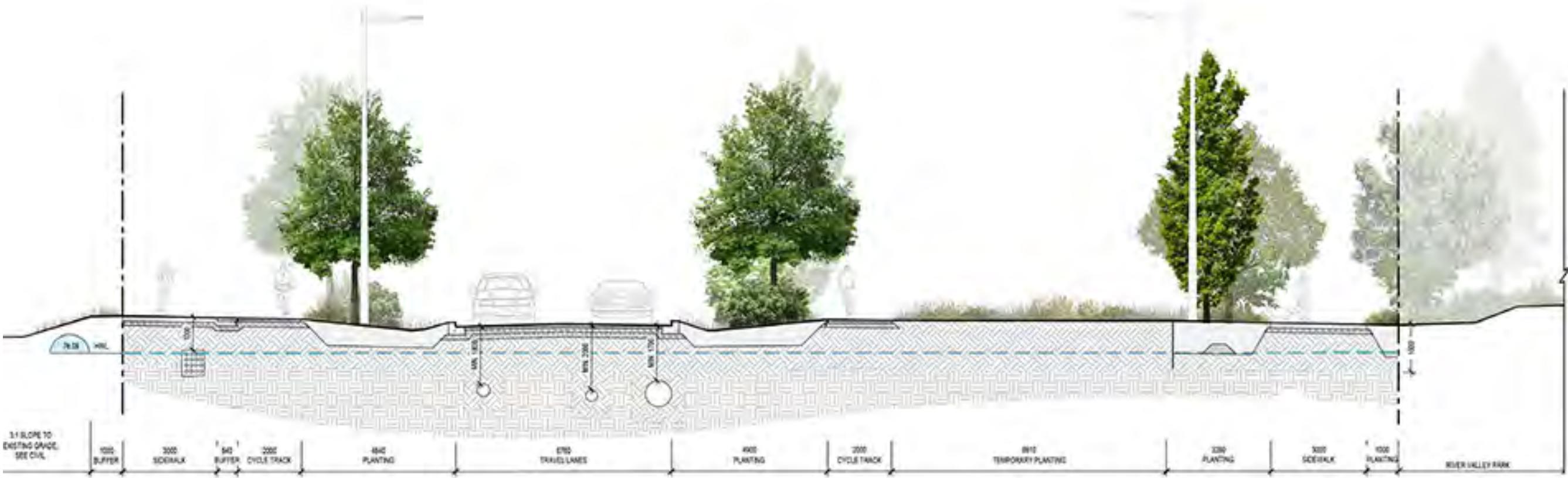

Current Section without Dedicated Transit Lanes



# CHERRY STREET & COMMISSIONERS STREET

Added southbound bus stop platform

One tree removed and minor adjustment to east edge of MGT trail to accomodate platform. Width of MGT remain at min. 4.0m.

No change to planter, paving and furnishings

Adjustment to curb to accomodate platform and bus movement

Shorter pedestrian crossing

Removed lay-by to accomodate platform. Moved trees (and added 1 tree) where platform is located to this location.

Added eastbound bus stop platform

Shorter pedestrian crossing. Adjustment to cycle track alignment

Added westbound bus stop platform

Adjustment to curb to accomodate platform and bus movement. 5 columnar trees removed

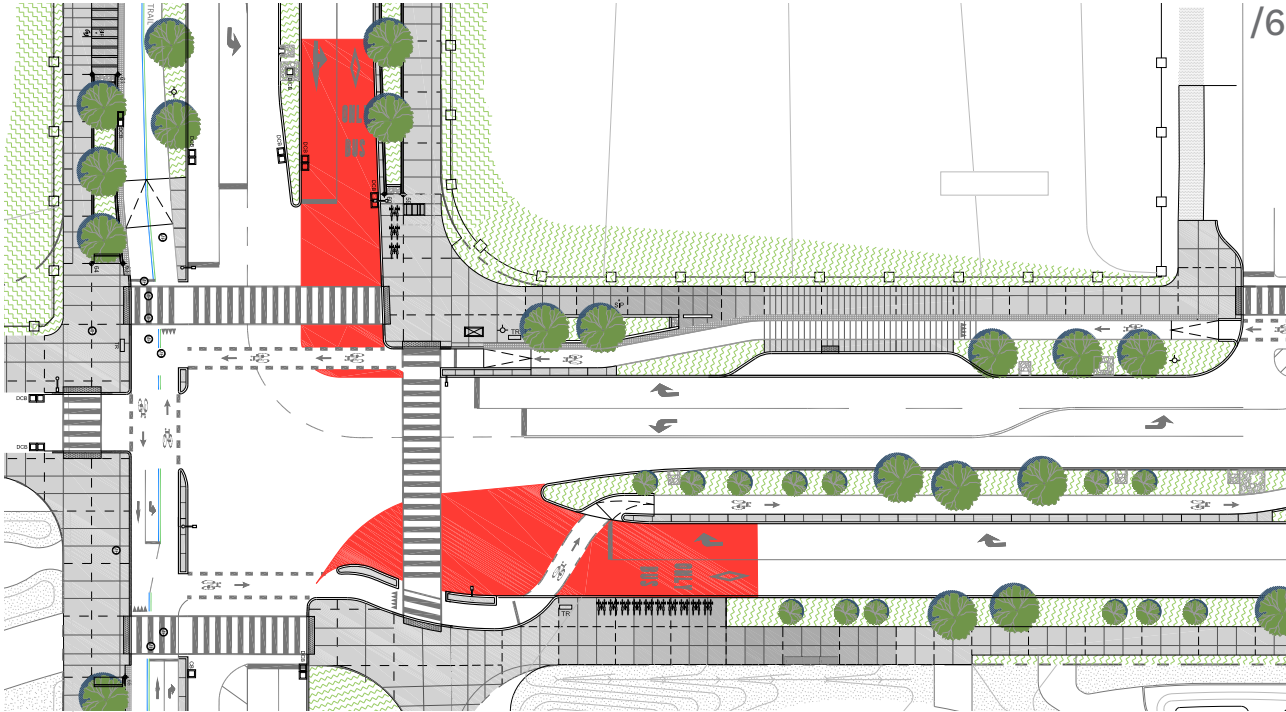

Former Plan

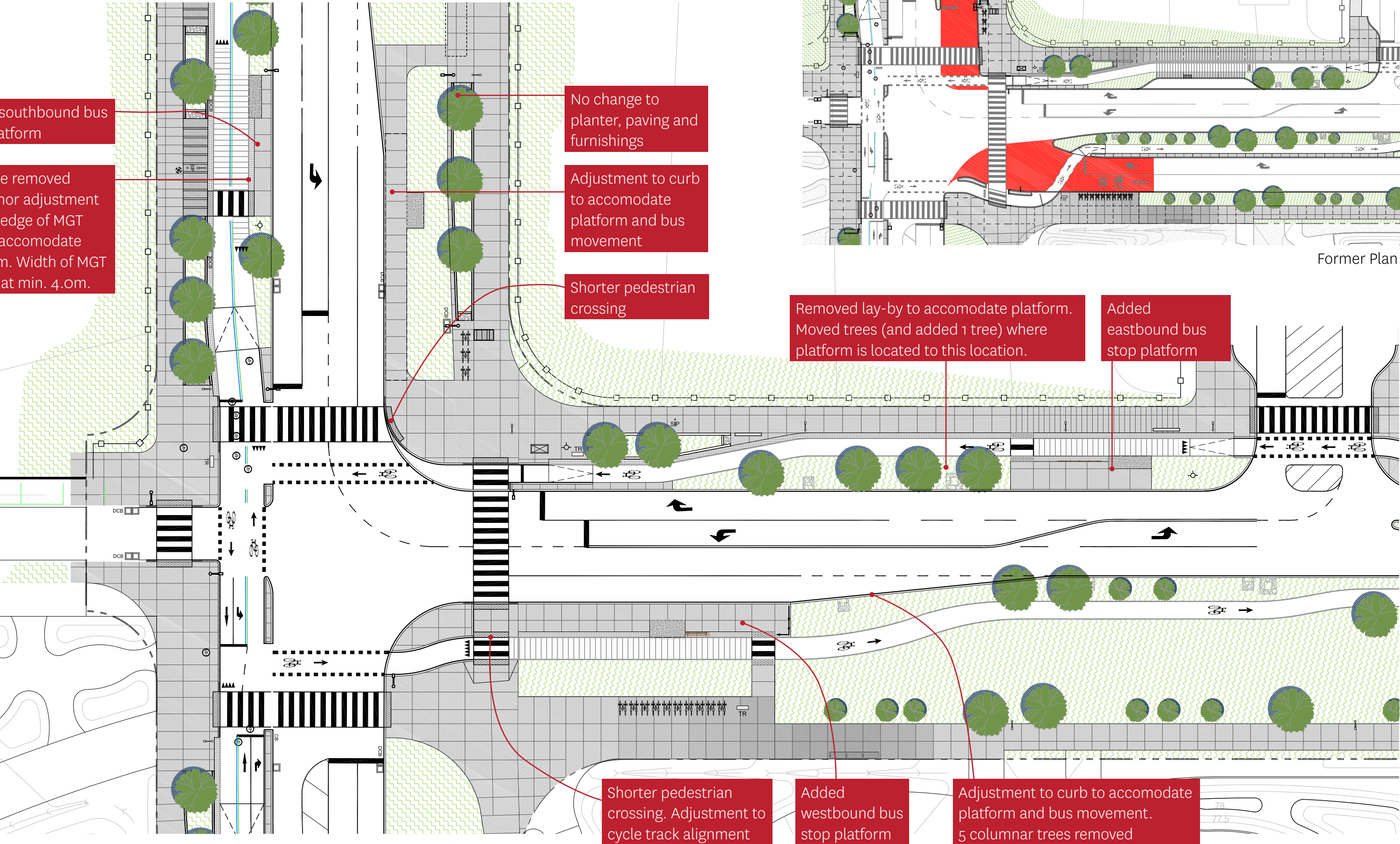



# COMMISSIONERS STREET & FUTURE MUNITION STREET

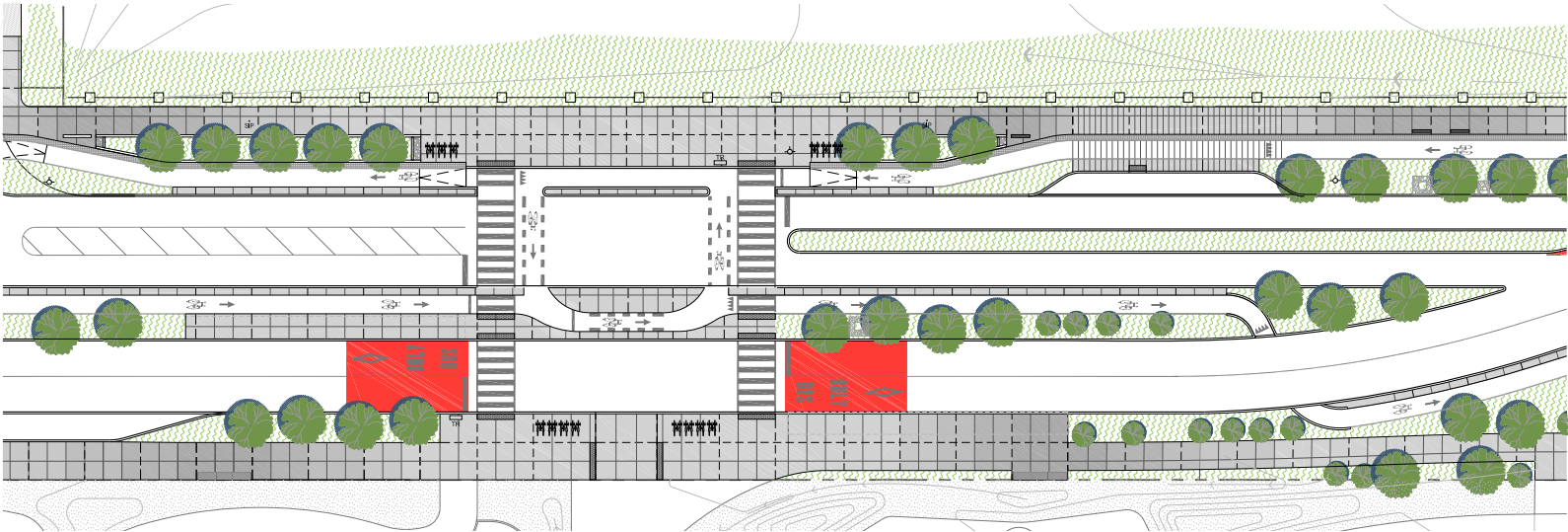

Former Plan

Added westbound bus stop platform

Removed planter and adjusted cycle alignment to accomodate platform and bus movement

Removed island, reduced curb-to-curb width, and added bioswales

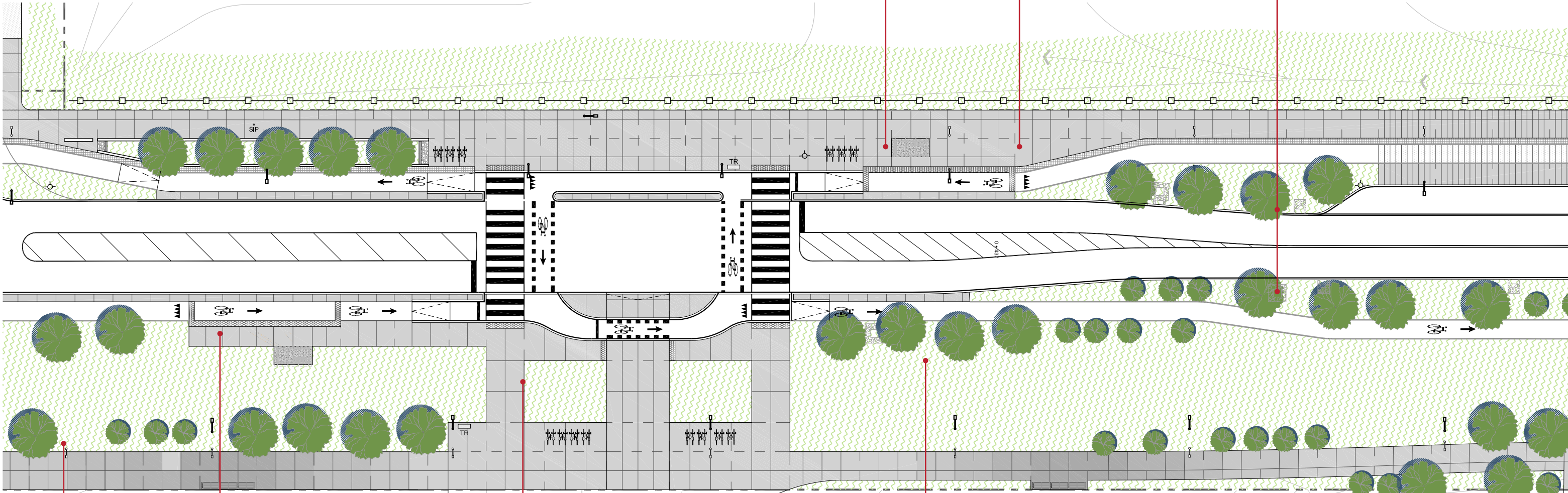

No change to planting, paving and furnishings

Added eastbound bus stop platform

Added paving to provide access into Park

Removed curbs and added root barrier to protect for future construction



MID-BLOCK CROSSING

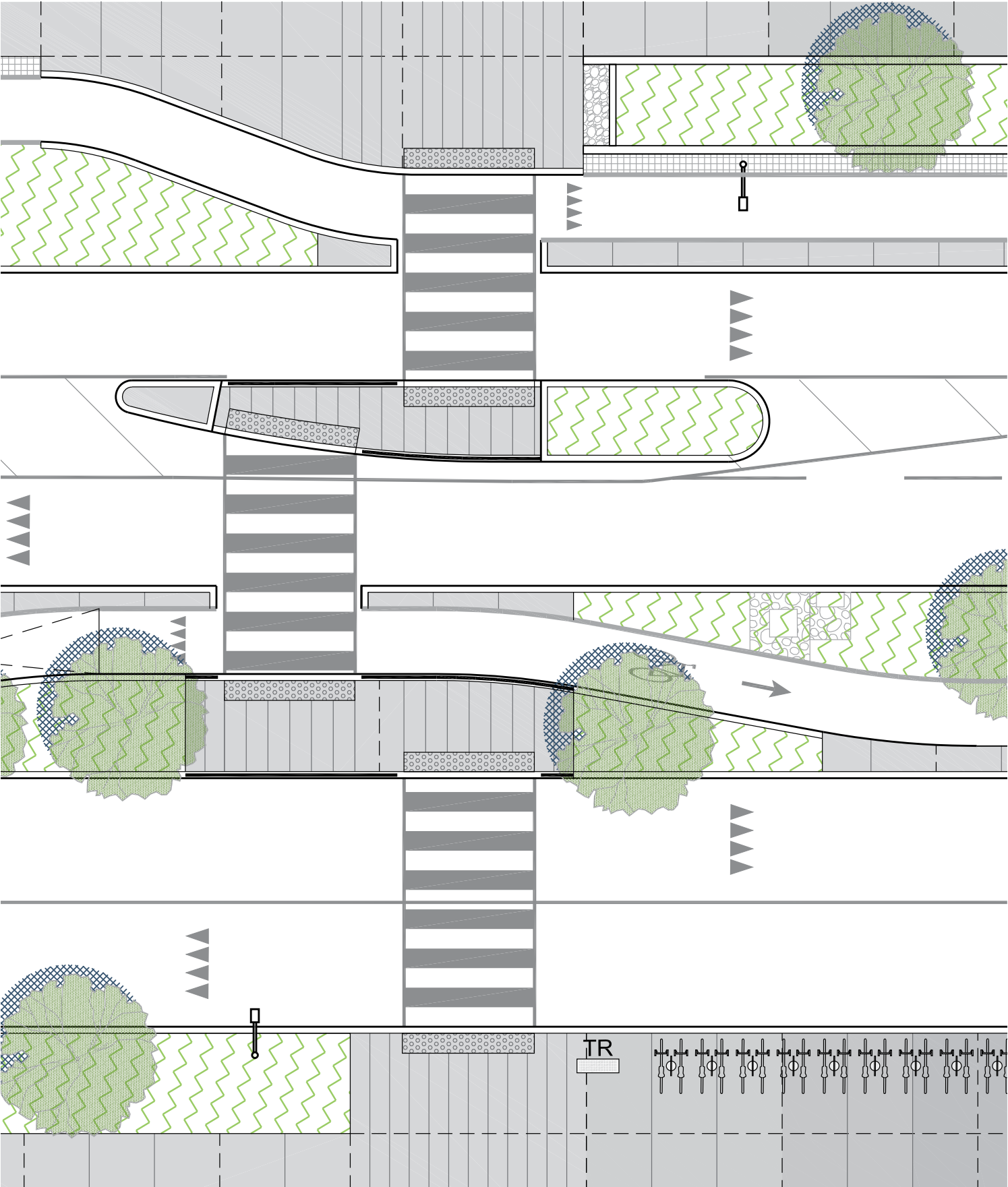

FORMER PLAN

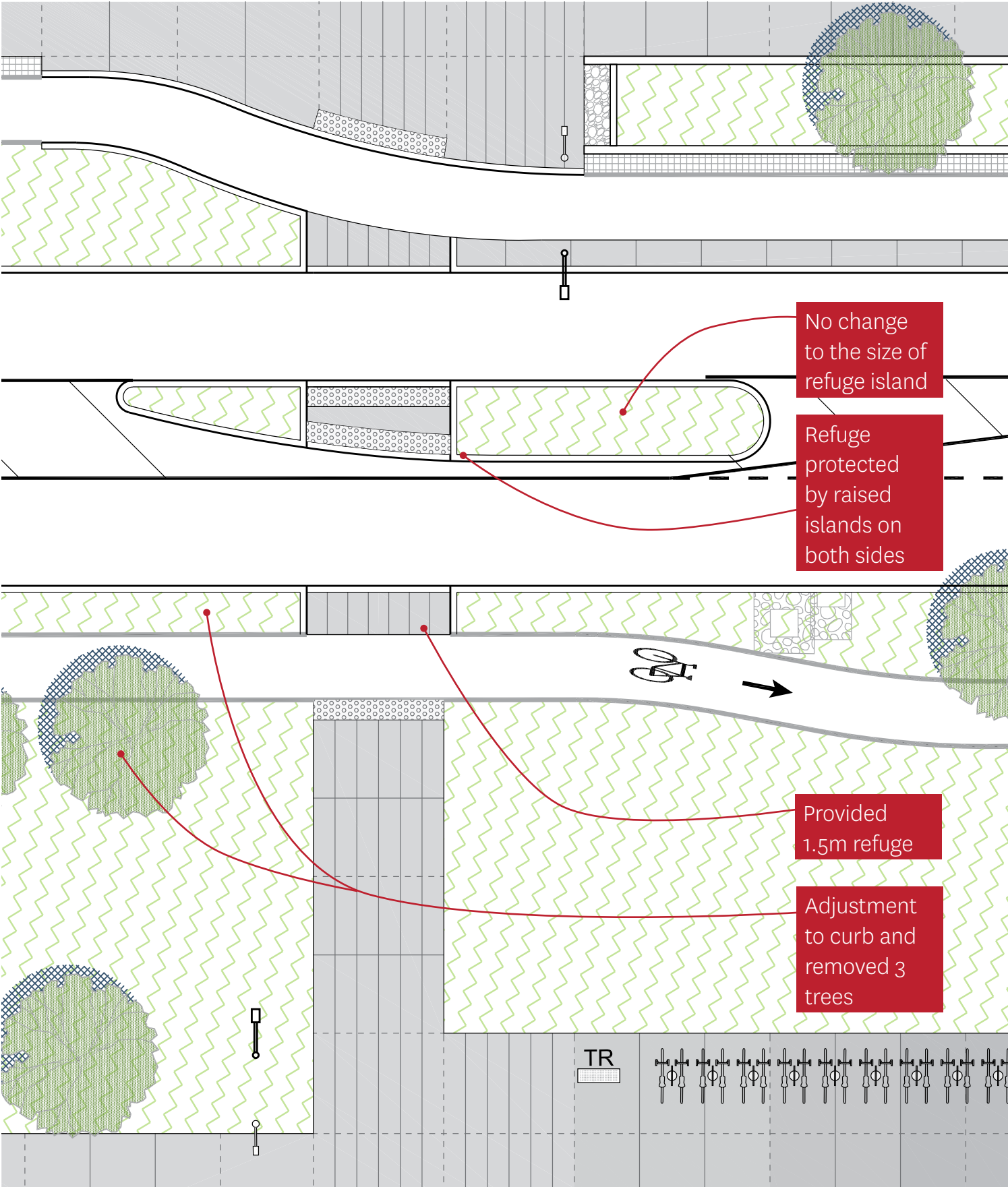

CURRENT PLAN

**Liam Mahoney, West 8**  
**Michael Ormston-Holloway,**  
**Planning Partnership**

# Where are we now?

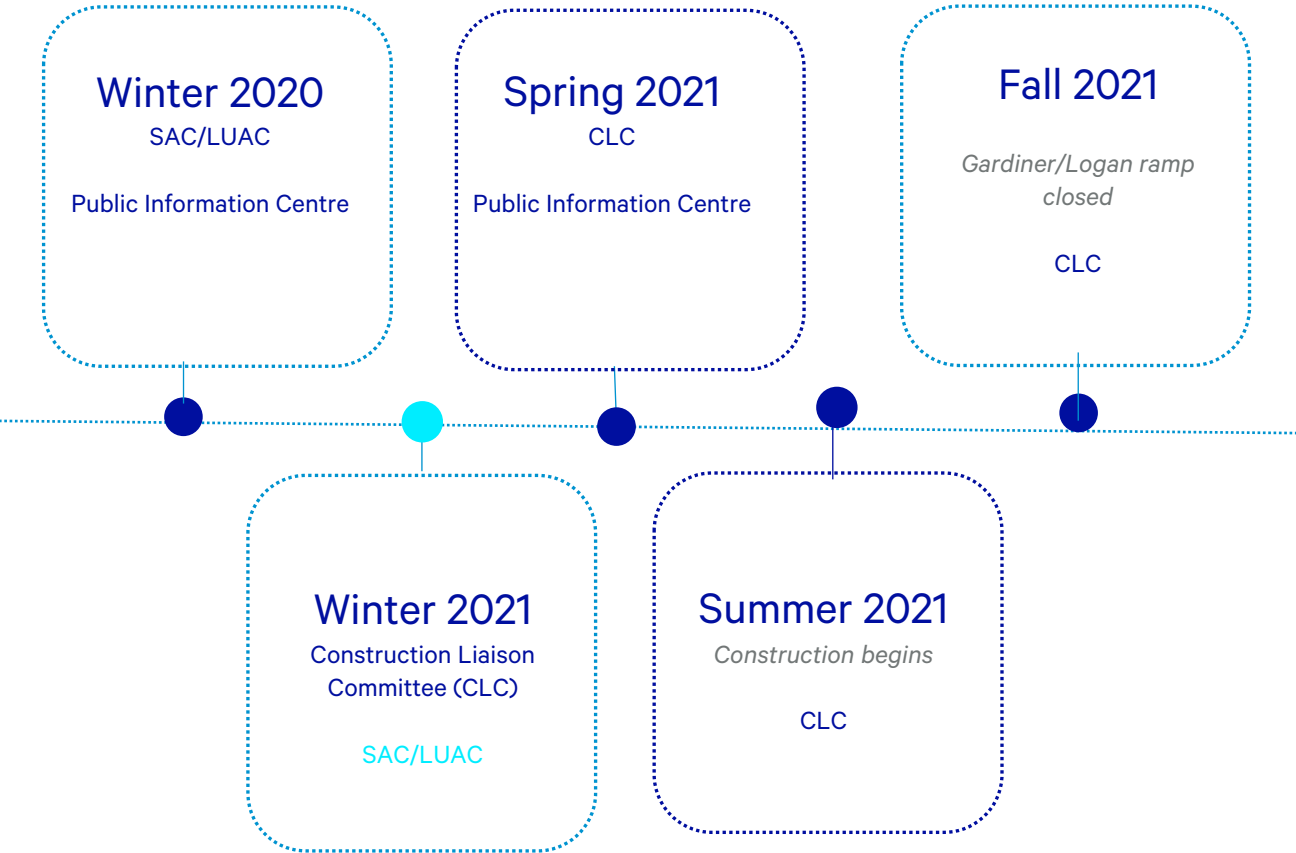

- Opening Lake Shore Bridge eastbound: Spring 2023
- Opening Lake Shore Bridge westbound
- Construction complete: Winter 2024

# Lake Shore Boulevard East Public Meeting Feedback

- People liked the approach to planting/landscaping
- Emphasis on safety for pedestrians and cyclists
- Support for infrastructure like water fountains, bike rings
- Aesthetic suggestions
- Design for all times of day and seasons
- ‘Future-proof’ for higher usage in future



# Lake Shore Boulevard East Public Realm - Don River to Carlaw Avenue SAC Presentation Update

March 12, 2021

# Agenda

**1. Project Context**

**2. Public Realm Design Updates**

**3. Planting Updates**

# Project Context



# Project Area: Lake Shore Boulevard East Bridge and Public Realm



# Lake Shore Boulevard Public Realm Design Vision - Objectives

- 1 Design an **urban civic boulevard** with a distinct **continuous landscape identity**
- 2 Prioritize **traffic calming** measures and **enhance public realm experience and safety**
- 3 Improve **East-West connectivity** through rebalanced multimodal mobility
- 4 Improve **North-South connectivity** through enhanced intersections
- 5 Design for **sustainable operations and maintenance** for public realm

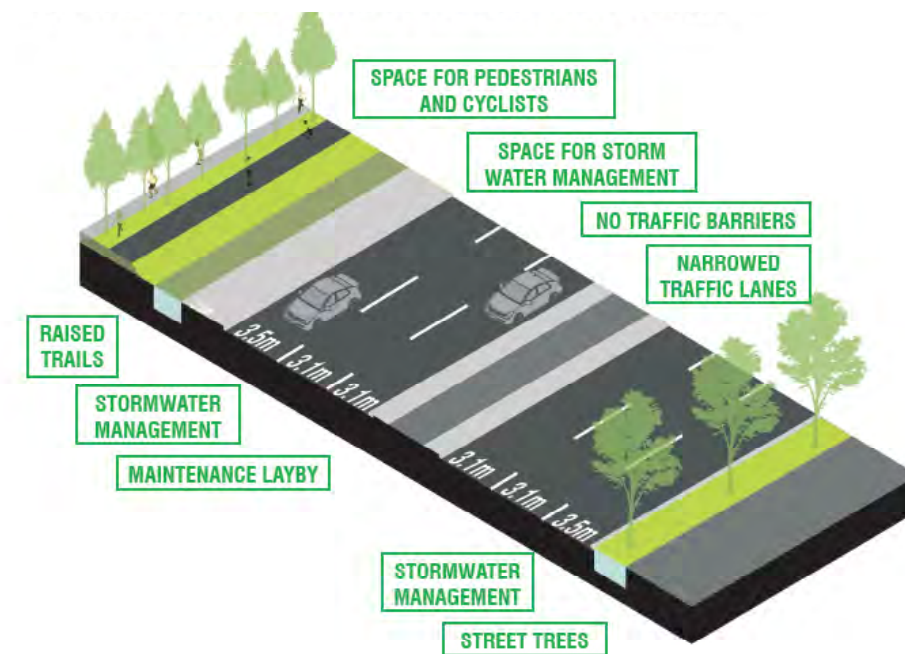
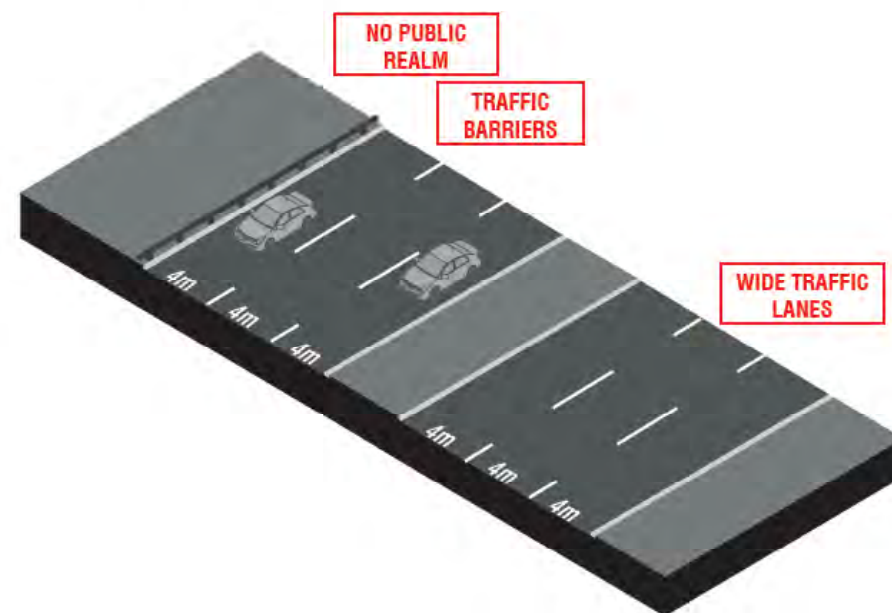

## **Project Context:**

**The Gardiner and Lake Shore Boulevard design has been shaped by:**

- 1. The approved Gardiner Expressway and Lake Shore Boulevard Reconfiguration EA and Urban Design Study (2017)**
- 2. Lake Shore Boulevard East Public Realm Vision, Phasing and Implementation Plan (2020)**
- 3. Ongoing detailed design work**
- 4. October 21 DRP Presentation, November 9th SAC Presentation, November 13th LUAC Presentation, December 4th PIC Presentation**



# Public Realm Design

# Project Overview

## Updated Areas

**Area 1** - Lake Shore  
Boulevard Bridge

**Area 5** - Logan Avenue to  
Carlaw Avenue



 Future Improvement Zone  
- Setbacks Adjacent to  
New Development

# Area 1 - Lake Shore Boulevard Bridge

## Expanded Public Realm

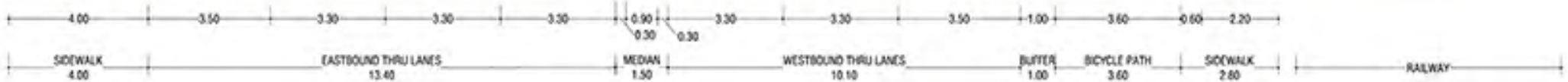
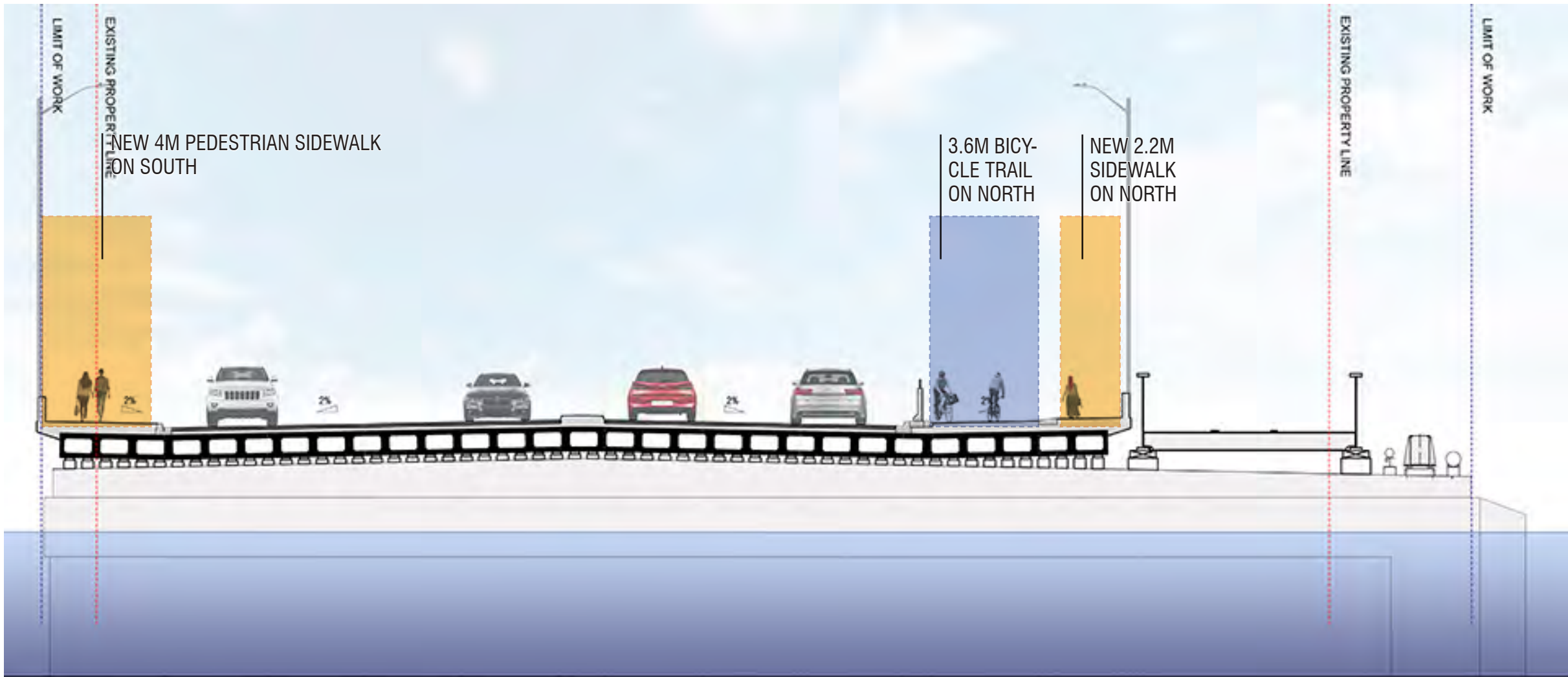



# Area 1 - Lake Shore Boulevard Bridge

## Expanded Public Realm - Updated

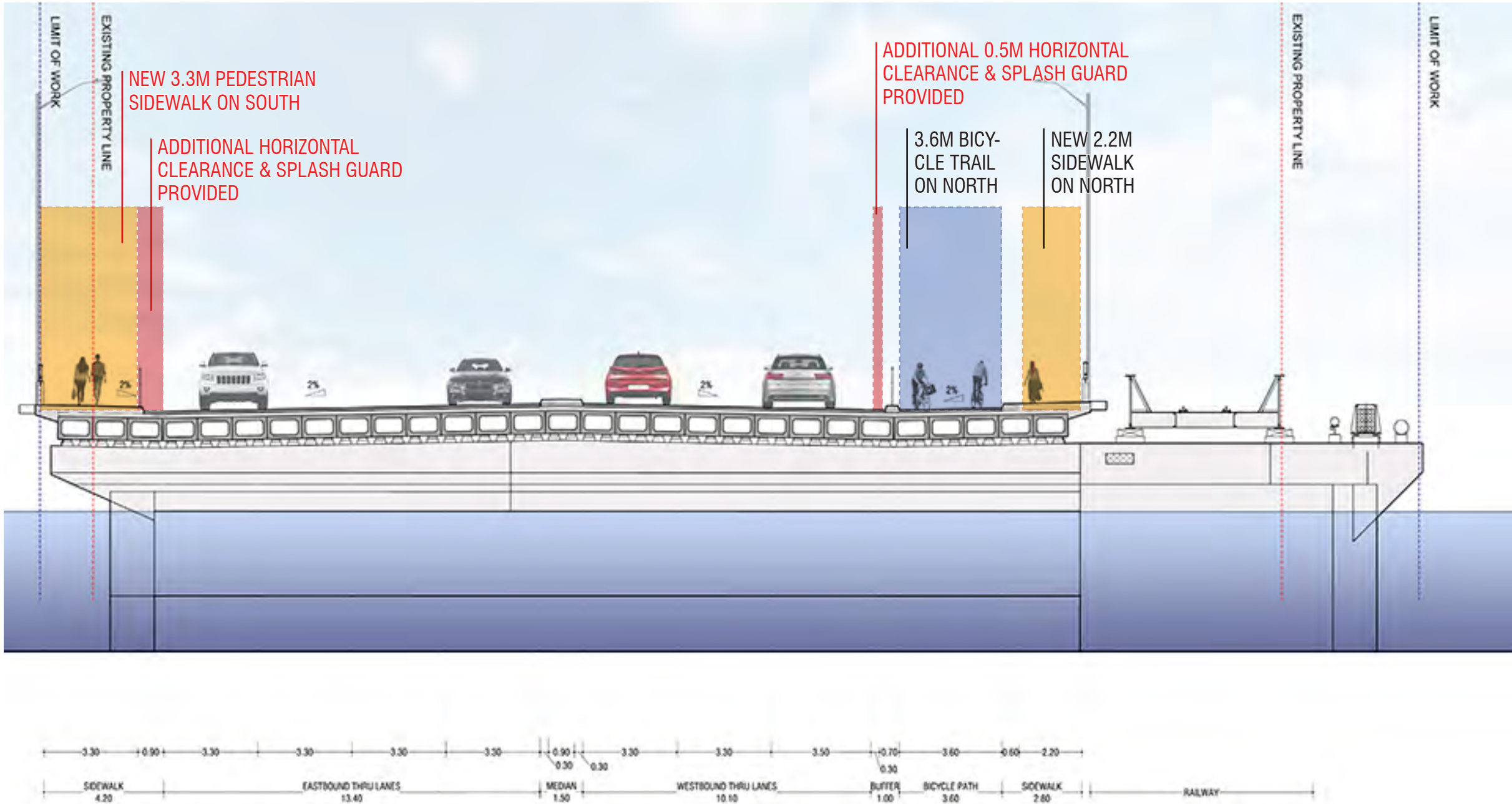

# Area 5 - Logan Avenue to Carlaw Avenue

## Protected and Side by Side Trails

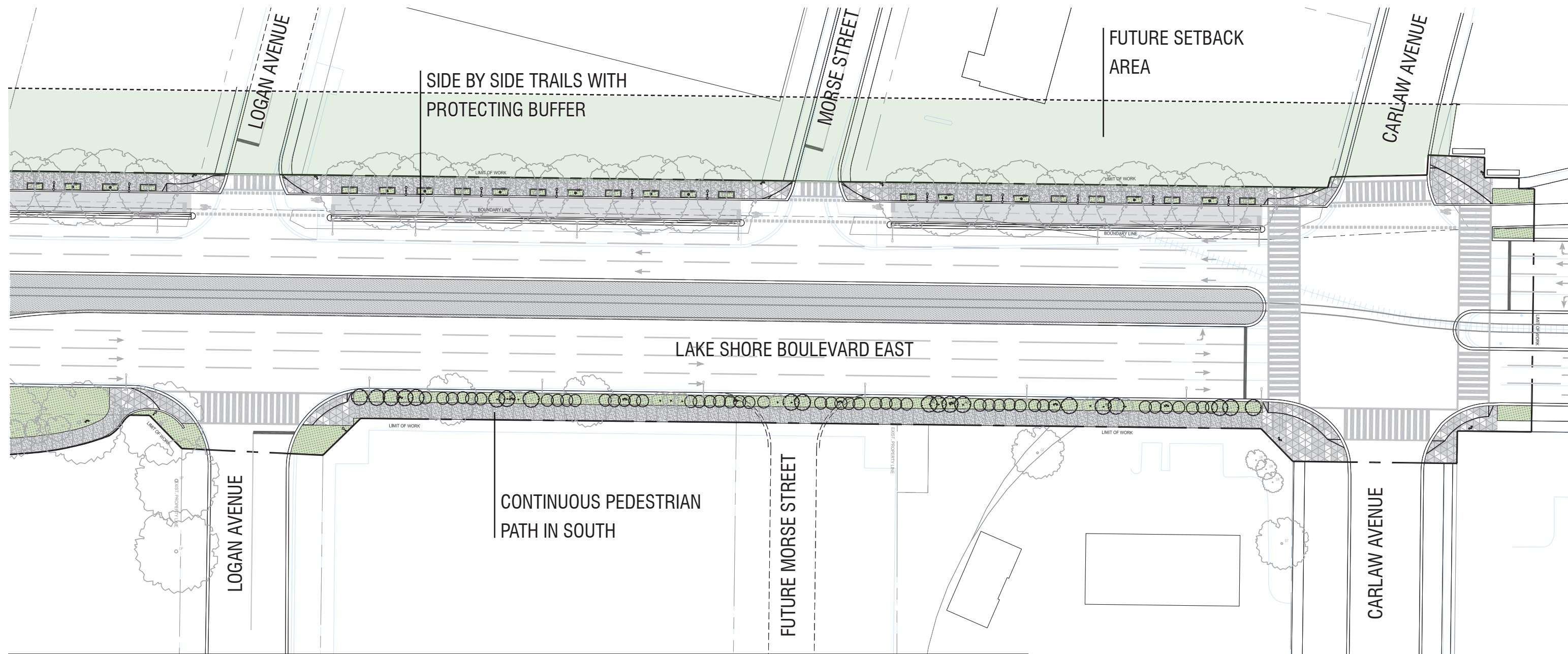

LEGEND					
<b>MATERIALS - SOUTH SIDE BOULEVARD</b>		<b>MATERIALS - NORTH SIDE TRAIL</b>		<b>MATERIALS - INTERSECTIONS AND ROAD</b>	
PERMEABLE UNIT PAVERS		ASPHALT BICYCLE PATH		PAVING PATTERN - 3 TYPES OF CONCRETE FINISH	
<b>MATERIALS - MEDIANS</b>		CIP CONCRETE PAVING WITH BROOM FINISH		THERMOPLASTIC WHITE ROAD MARKINGS	
ROUGH STONE TYPE 1 AGGREGATE, 2-4CM DIAMETER ON BRIDGE ONLY		ROUGH STONE TYPE 1 AGGREGATE, 2-4CM DIAMETER		<b>PROPOSED LIGHTING</b>	
STORMWATER / PLANTING				LIGHTPOLE TYPE III	
				<b>EXISTING SURVEY</b>	
				SURVEY OF EXISTING CONDITIONS - EXISTING CURBS IN DARK BLUE	
				<b>FUTURE DEVELOPEMENT</b>	
				DESIGN OF FUTURE BROADVIEW AVENUE	
				<b>PLANTING - REFER TO L-500 SERIES</b>	
				PROPOSED PLANTING AREA	
				<b>LEGEND - PLANTING</b>	
				PROPOSED NEW TREE	
				EXISTING TREE	



# Area 5 - Logan Avenue to Carlaw Avenue

## Protected and Side by Side Trails - Updated

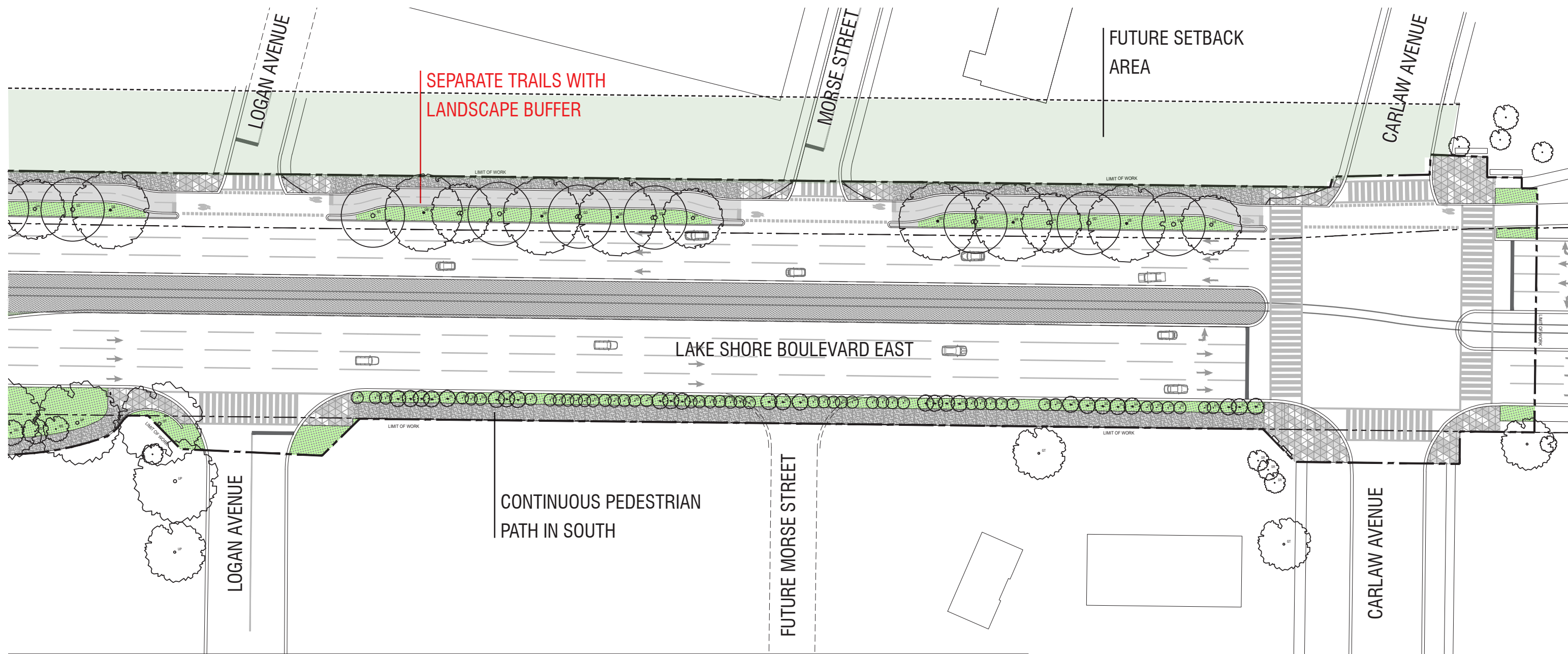

LEGEND					
<b>MATERIALS - SOUTH SIDE BOULEVARD</b>		<b>MATERIALS - NORTH SIDE TRAIL</b>		<b>MATERIALS - INTERSECTIONS AND ROAD</b>	
PERMEABLE UNIT PAVERS		ASPHALT BICYCLE PATH		PAVING PATTERN - 3 TYPES OF CONCRETE FINISH	
<b>MATERIALS - MEDIANS</b>		CIP CONCRETE PAVING WITH BROOM FINISH		THERMOPLASTIC WHITE ROAD MARKINGS	
ROUGH STONE TYPE 1 AGGREGATE, 2-4CM DIAMETER ON BRIDGE ONLY		ROUGH STONE TYPE 1 AGGREGATE, 2-4CM DIAMETER		LIGHTPOLE TYPE III	
STORMWATER / PLANTING				SURVEY OF EXISTING CONDITIONS - EXISTING CURBS IN DARK BLUE	
				DESIGN OF FUTURE BROADVIEW AVENUE	
				PLANTING - REFER TO L-500 SERIES	
				PROPOSED NEW TREE	
				EXISTING TREE	

# Area 5 - Logan Avenue to Carlaw Avenue

## Protected and Side by Side Trails

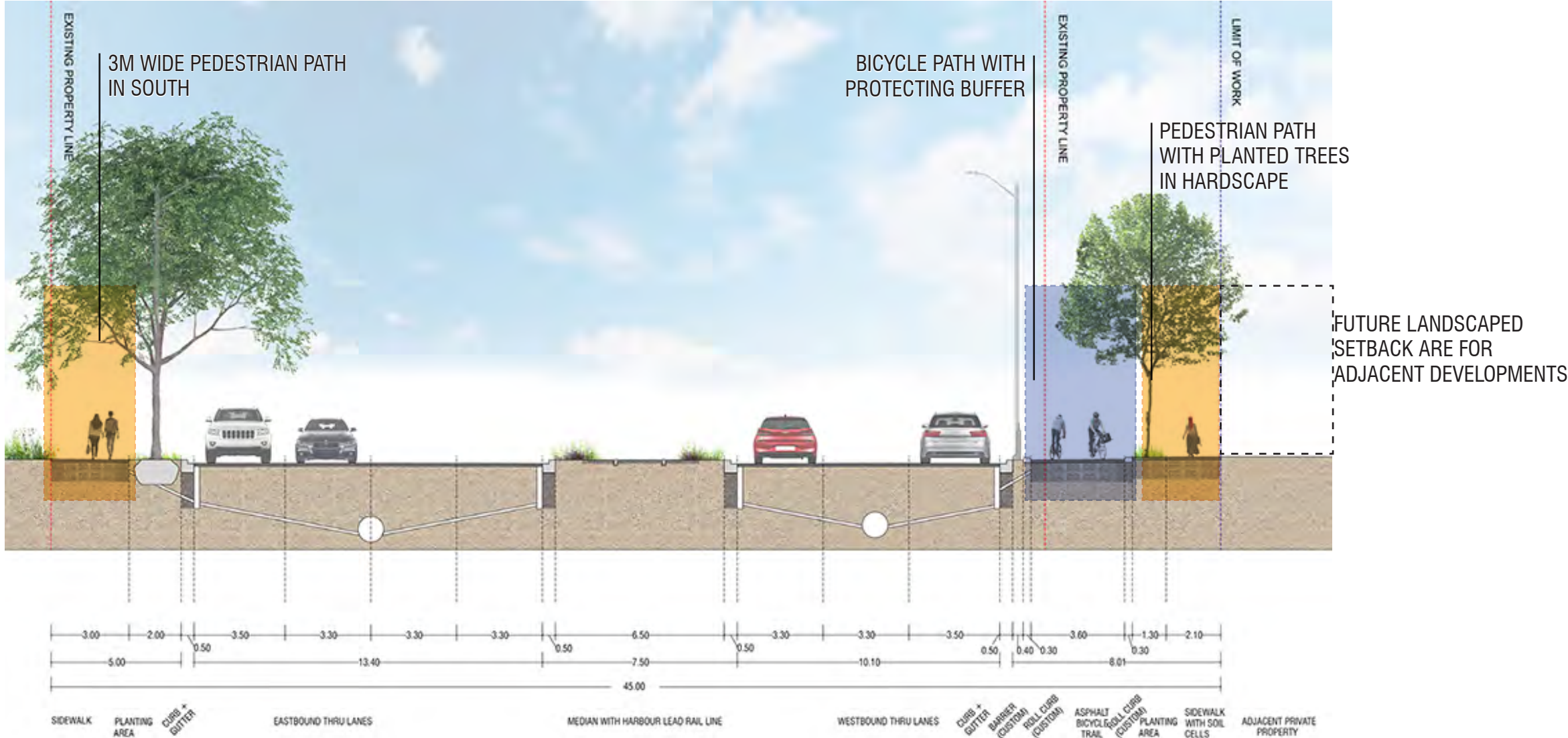



# Area 5 - Logan Avenue to Carlaw Avenue

Protected and Side by Side Trails - Updated

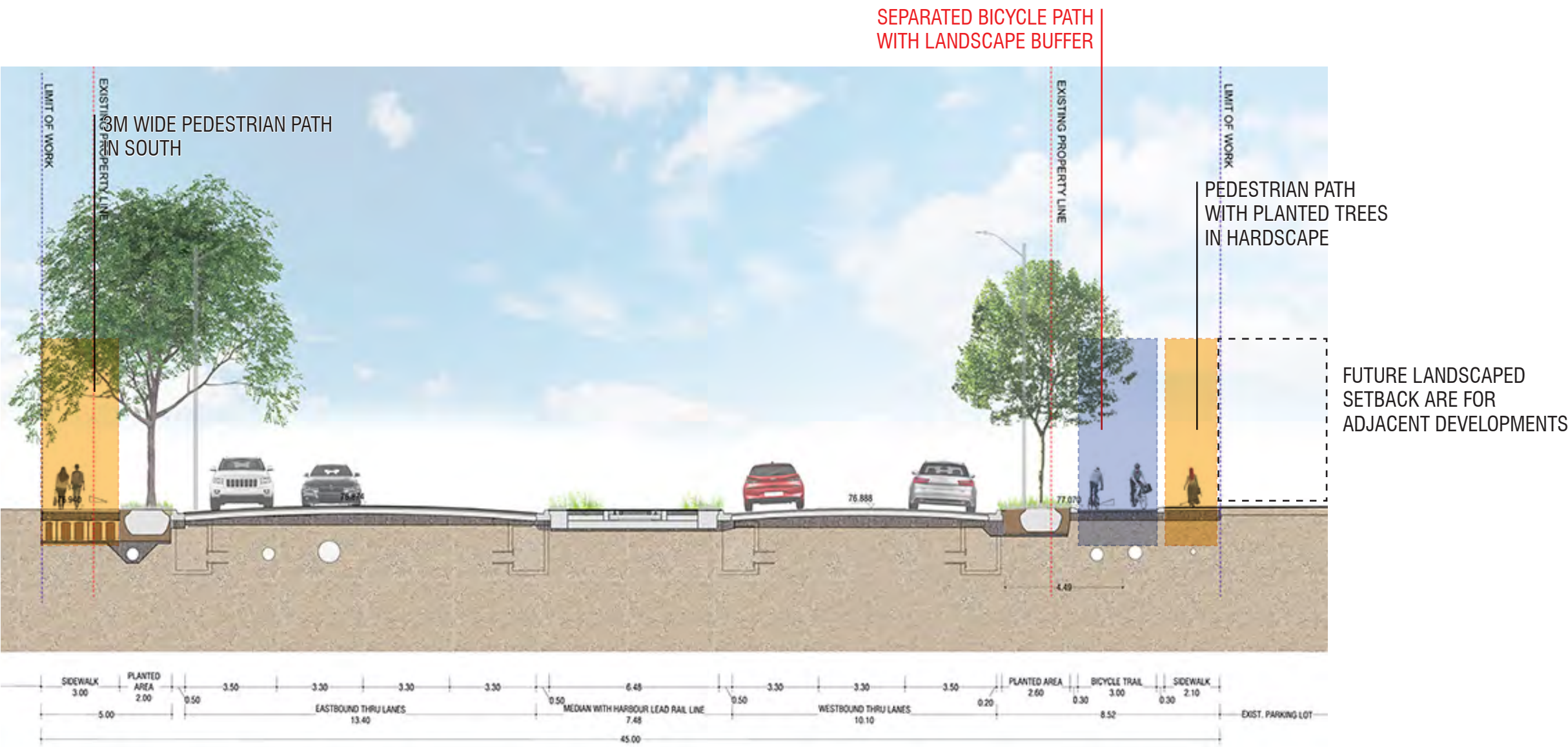



# Public Realm Design

## Resting Area “Pocket Parks”

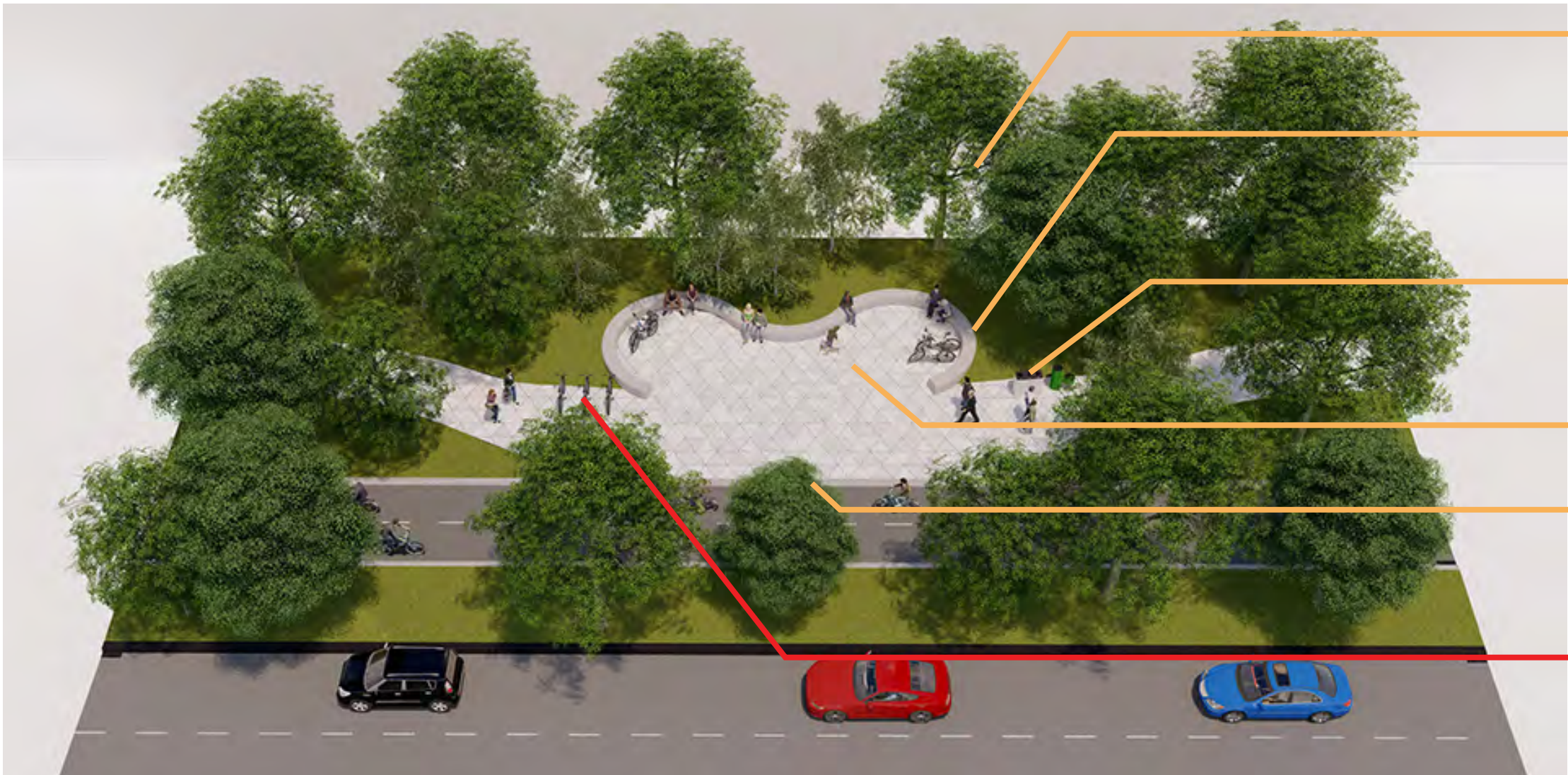

- Raised Planting Bed for Trees and Shrubs
- Concrete Social Seating Circle
- Drinking fountain & Waste Receptacles
- Special Paving at Pocket Park Matches Intersection Corners
- Rolled Curb at Bicycle Path: cyclists stop and dismount to use rest area
- Bicycle Parking Racks Added



# Public Realm Design

## Additional Seating Areas

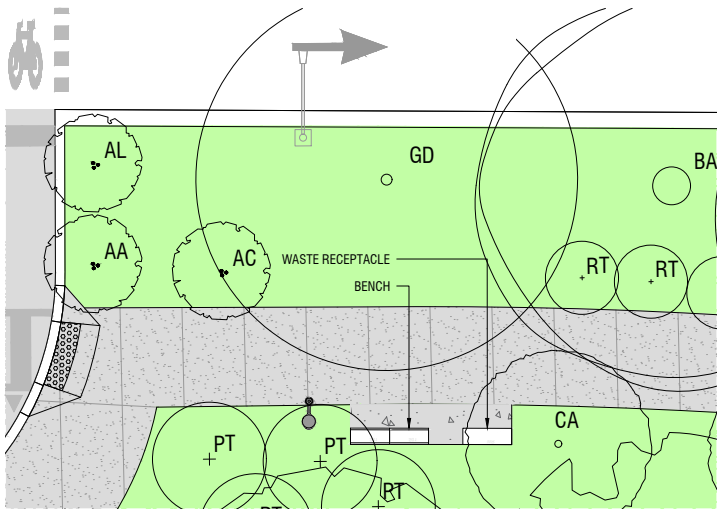

Don Roadway

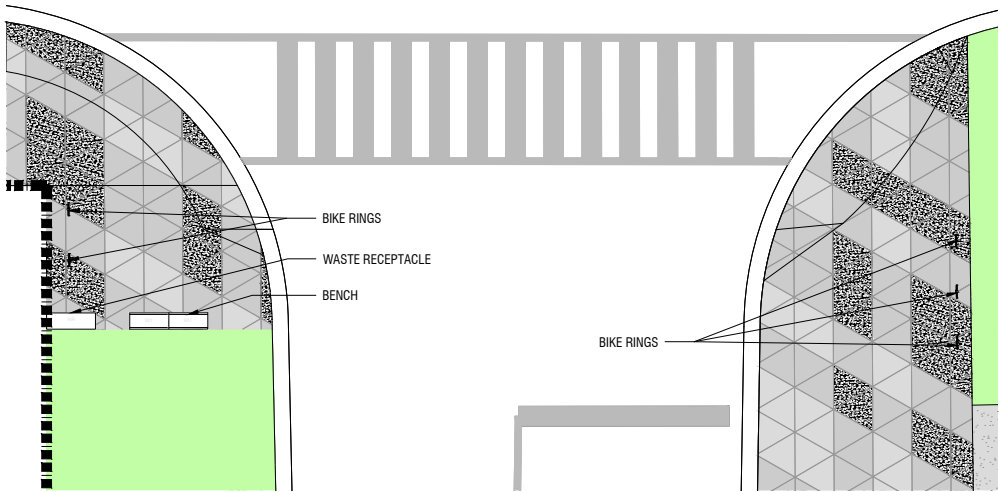

Bouchette St

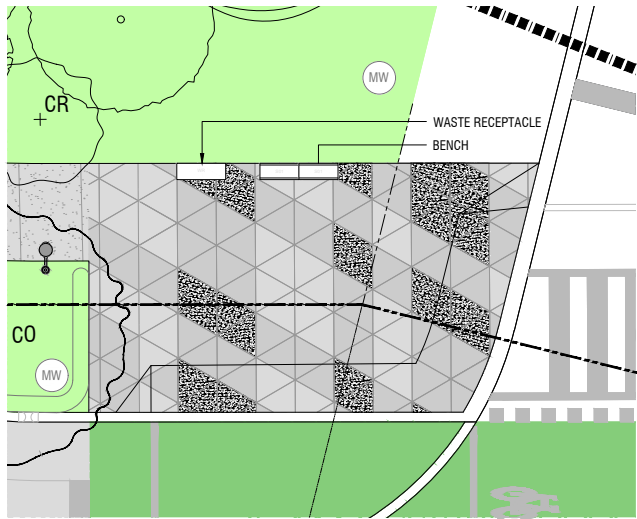

Booth Ave

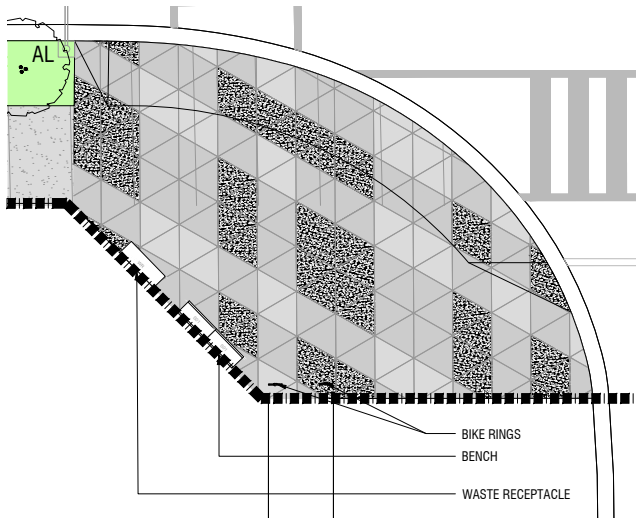

Carlaw Ave

# Planting Updates



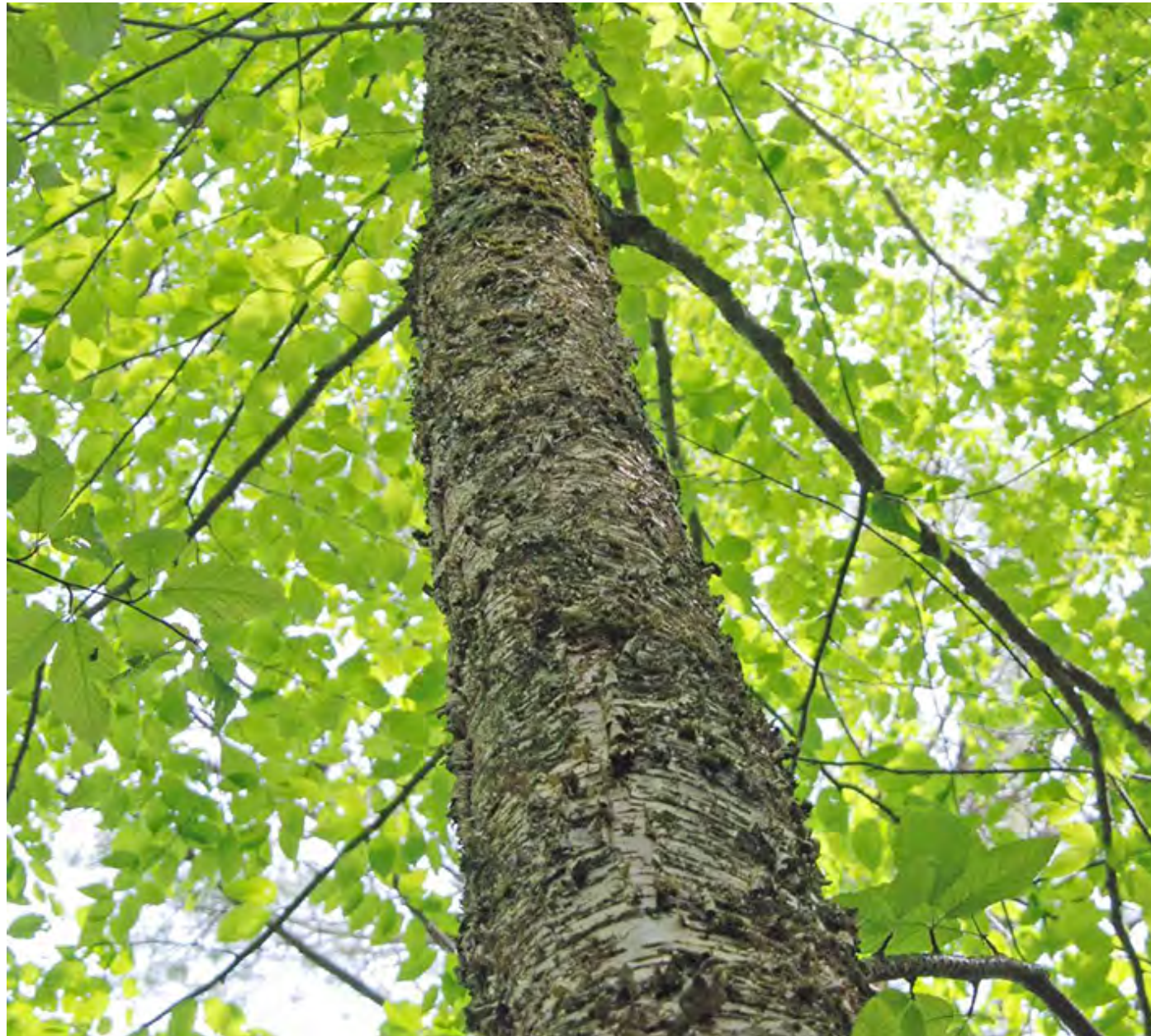

- **Black Alder (*Alnus glutinosa*) removed from plant list**
- **Yellow Birch (*Betula allagheniensis*) removed from boulevard**
- **Additional species added for pollinators, seasonal colour**
- **Swale species added, tolerant of varied moisture conditions**



# Planting Palette Expansion for Native Species, Pollinators & Seasonal Colour



*Achillea millefolium*



*Achillea millefolium* 'Lilac Beauty'



*Anaphalis margaritacea*



*Asclepias incarnata*



*Campanula rotundifolia*



*Fragaria virginiana*



*Geum Triflorum*



*Solidago flexicaulis*



*Solidago sphacelata* 'Golden Fleece'

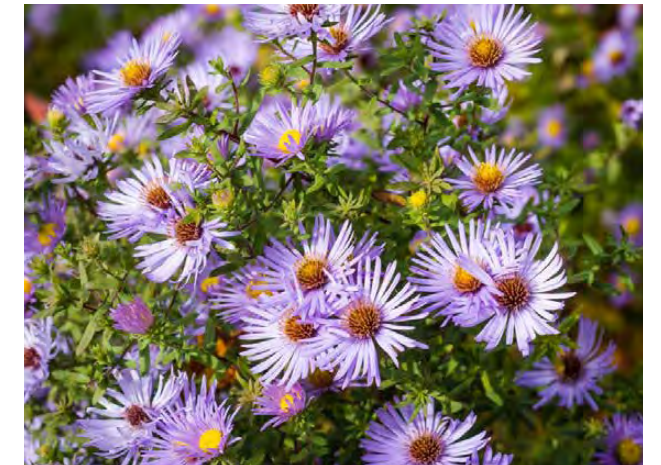

*Symphyotrichum oblongifolium*  
'October Skies'



*Viola sororia*



# Tier 2 - Additions to Swale Planting Palette



*Anemone canadensis*



*Carex eburnea*



*Carex pensylvanica*



*Chelone glabra*



*Hierochloa odorata*



*Iris versicolor*



*Lobelia cardinalis*



*Lobelia siphilitica*



*Schizachyrium scoparium* 'Prairie Blues'



# Discussion