

**PORT**

**2024**

**March 12, 2021**

# Port Lands Flood Protection SAC #10

**LANDS**

Canada

Ontario

Toronto



# Agenda

- Introduction
- Project Updates
- Final Update: Design for PLFP roads
- Report back from Lake Shore Boulevard East public meeting
- Design Update: Sediment and Debris Management Area, Keating Channel
- Indigenous Design Progress

# **Introductions + Teams Instructions**

# Teams 101 – Joining on a Computer

- Turn your camera on if you're comfortable
- Click the microphone icon to mute yourself when you're not speaking
- Troubleshooting: use the chat window to note any issues
- "Raise your hand" to ask a question or make a comment

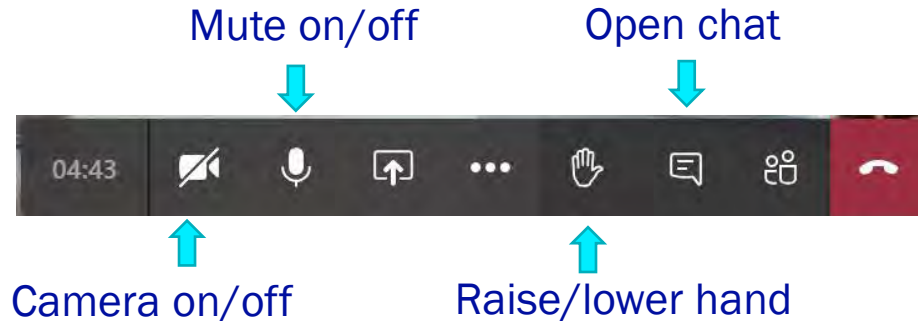



# Teams 101 – Joining via Telephone

- To mute/un-mute yourself, press \*6
- Mute yourself when you're not speaking
- Let us know if you can't hear or you can't tell which slide is being presented
- We'll open the floor to your questions/comments once all hands are down

# Introductions

- We'll go through the list of attendees (usually in alphabetical order)
- Please introduce yourself and the organization you represent

# **Construction Progress**

# Construction Progress



# Rocky Radar – Progress Reports via @TheRockRipper

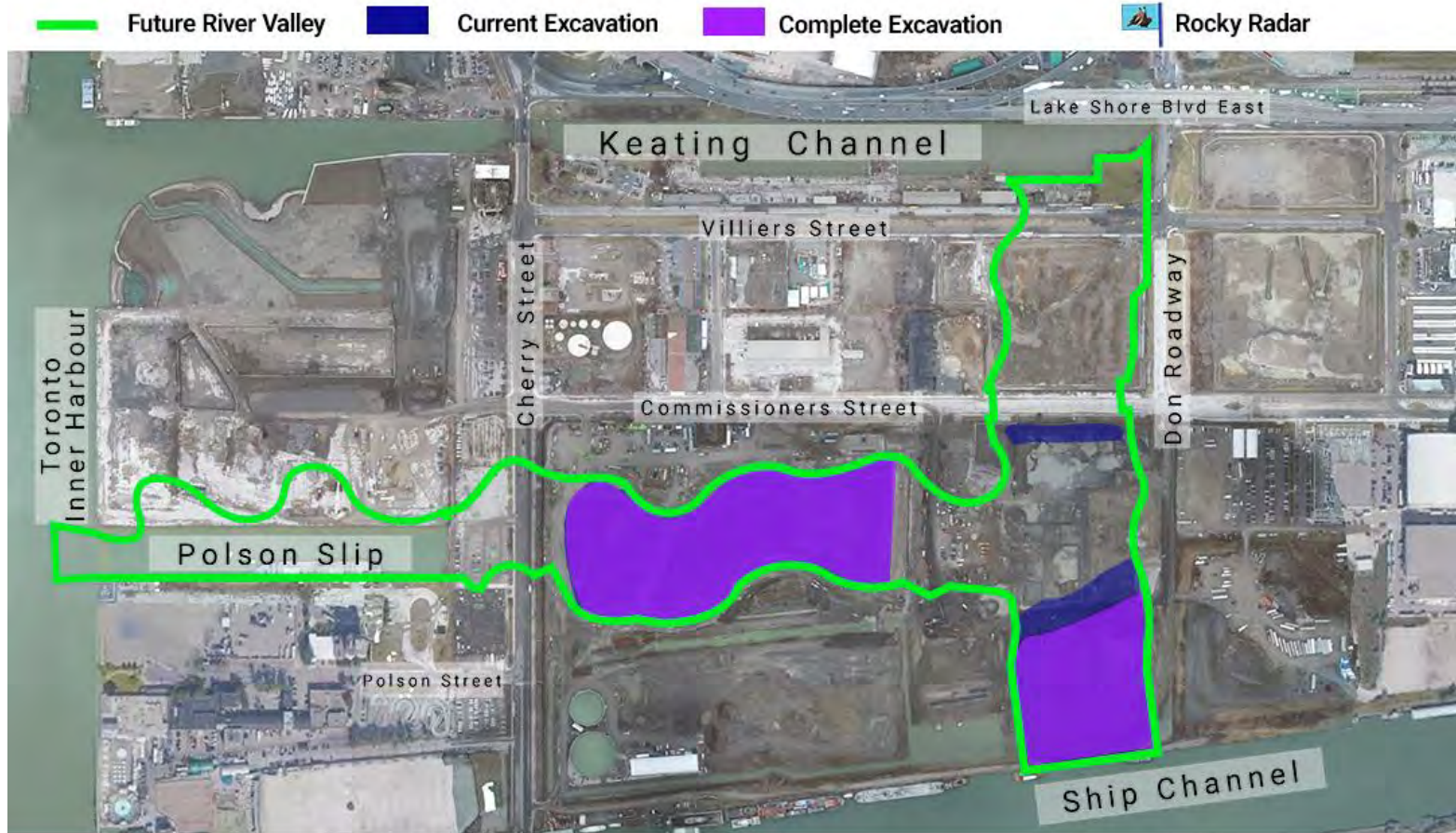



# Rocky Radar – Progress Reports via @TheRockRipper



# Aerial View

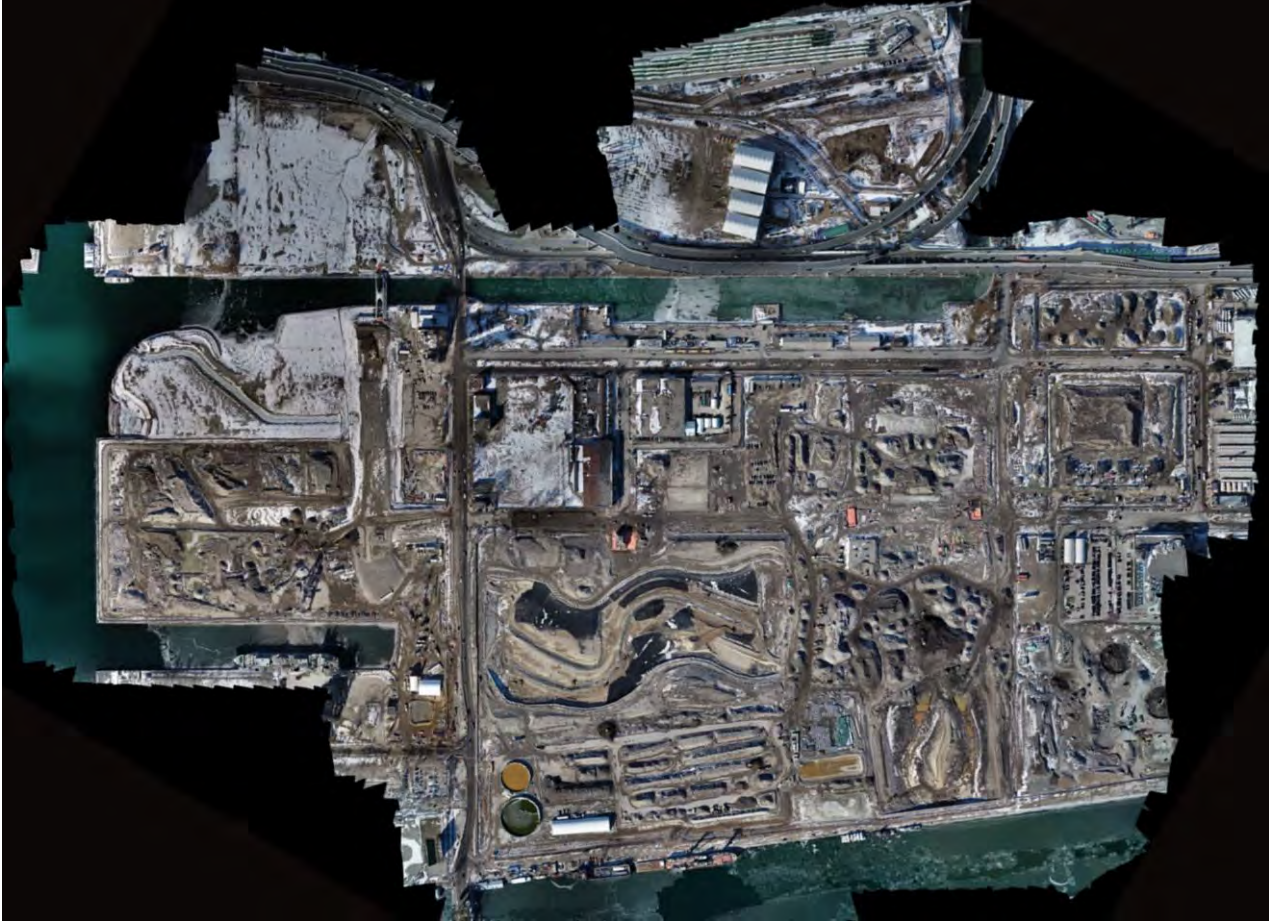



# Central River Valley Excavation Complete





# Central River Valley Reactive Treatment Layer





# Don Greenway/Spillway Excavation





# Cherry Street Fill and Surcharge





# Commissioners Street Fill and Surcharge





# Commissioners Street Bridge Foundations





# Diaphragm Wall Construction





# Port Lands Flood Protection: Reclaimed MT-35 Girders

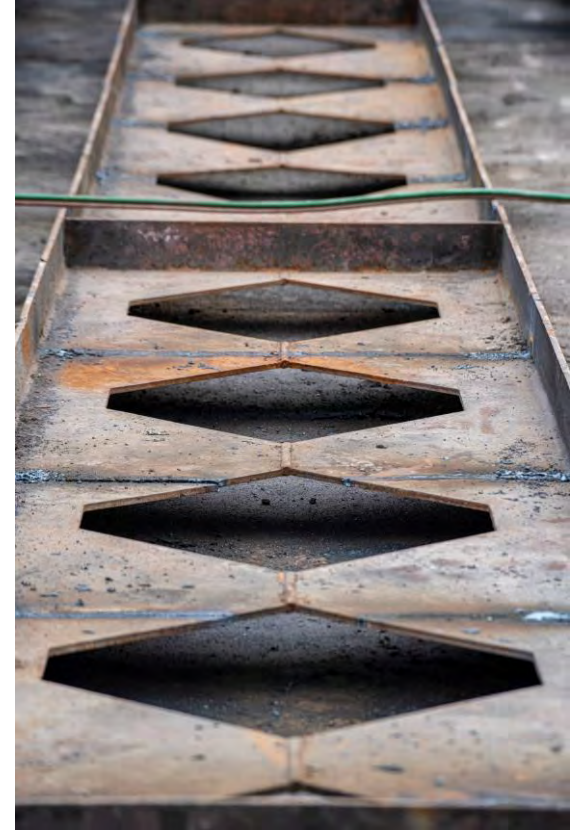

# A New River Innovation Challenge

- **How do we collect and share environmental data** from these new ecosystems to encourage conservation and behavior change in the wider community?
- **Live Q & A Sessions** to inspire ideas for the challenge:
  - March 18, 7-8pm: **Earthworks and Geotechnical** (WT & Geosyntech)
  - March 23, 7-8pm: **Park Design** (MinoKamik & MVVA)
  - March 24, 7-8pm: **Water & Aquatic Species** (Interfluve & TRCA)



# Where are we now?

Fall 2018

Design for parks & river is  
50% complete

Design complete on  
Cherry Street & Cherry  
Street Bridge North

June 2019

community consultation  
#3

Fall/Winter  
2020

SAC #6

Design for all roads  
is complete

Oct./Nov. 2020

SAC #8 & 9

Public Meeting #4

Spring 2019

Design for parks & river is  
60% complete

Summer 2019

SAC #5

Spring/Summer  
2020

SAC #7

Design for all park  
elements is complete

March 2021

SAC #10

**See-Yin Lim, DTAH**

# THREE STREETS FOR THE PORT LANDS

Today's presentation will focus on adjustments made to **Cherry Street** and **Commissioners Street** to accommodate the deletion of the BRT lanes.





STREET CHARACTER

CHERRY STREET



Urban Street

COMMISSIONERS STREET



Park Street

DON ROADWAY



River Street



# CHERRY STREET | Comparing Plans

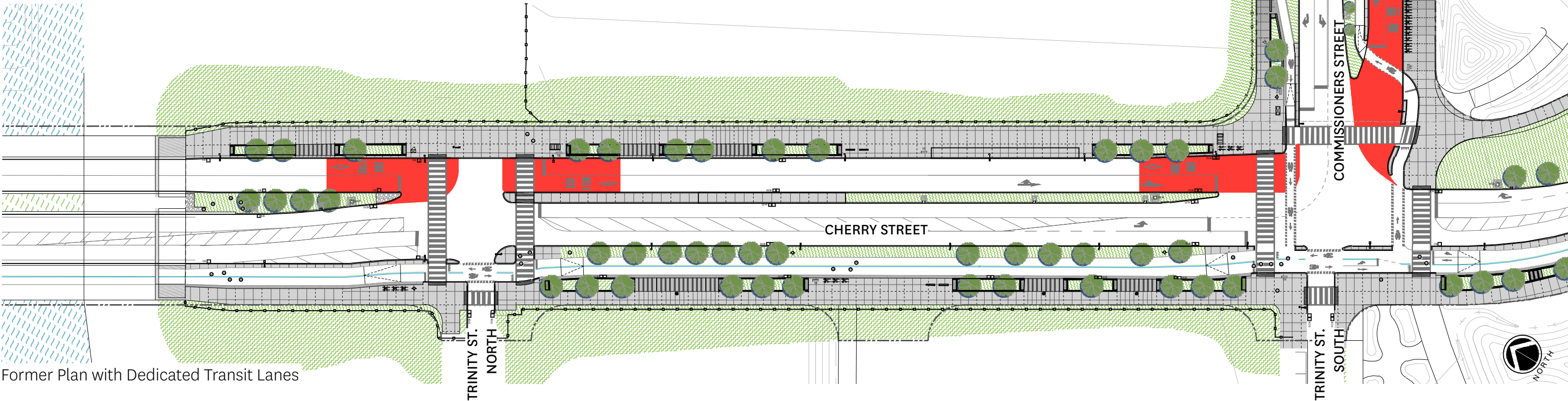

Former Plan with Dedicated Transit Lanes

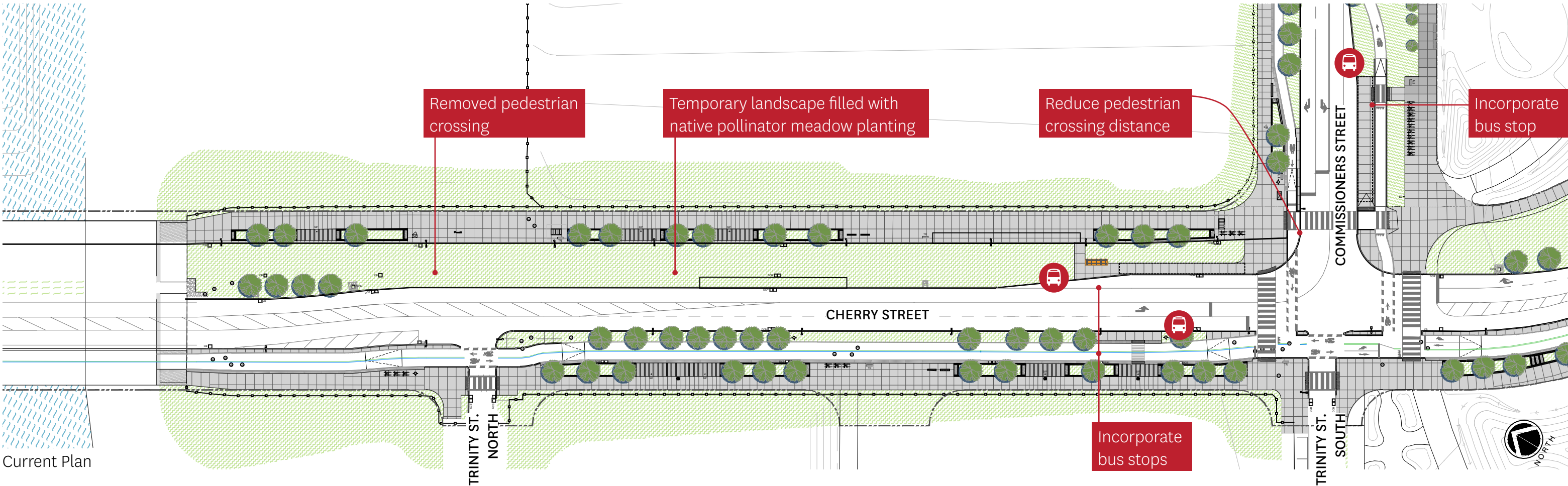

Current Plan



# COMMISSIONERS STREET | Comparing Plans

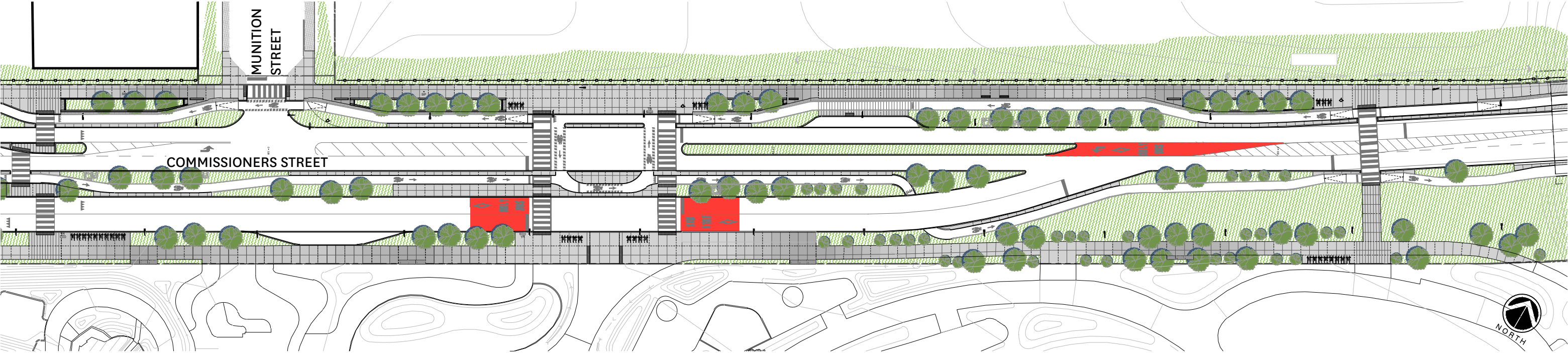

Former Plan with Dedicated Transit Lanes

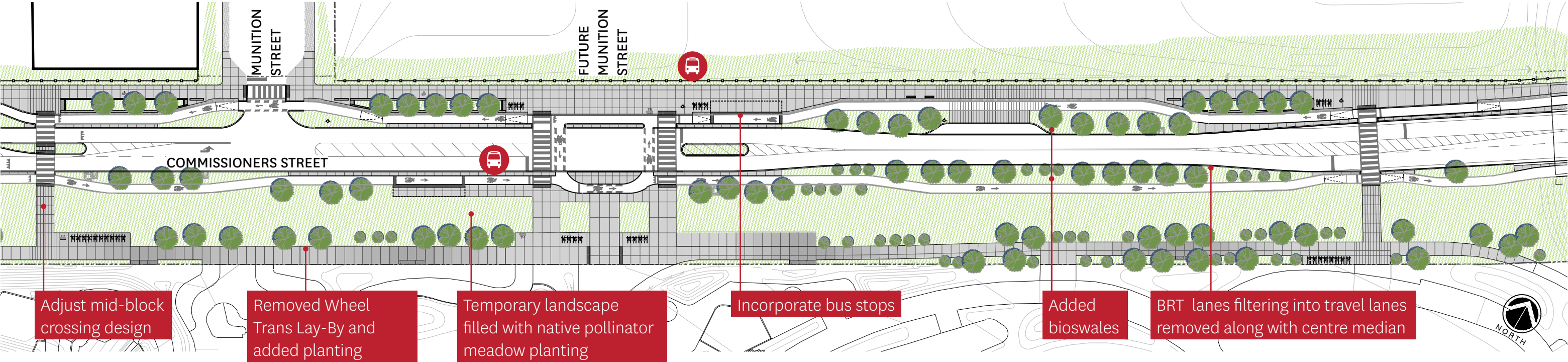

Current Plan



COMMISSIONERS STREET SECTION

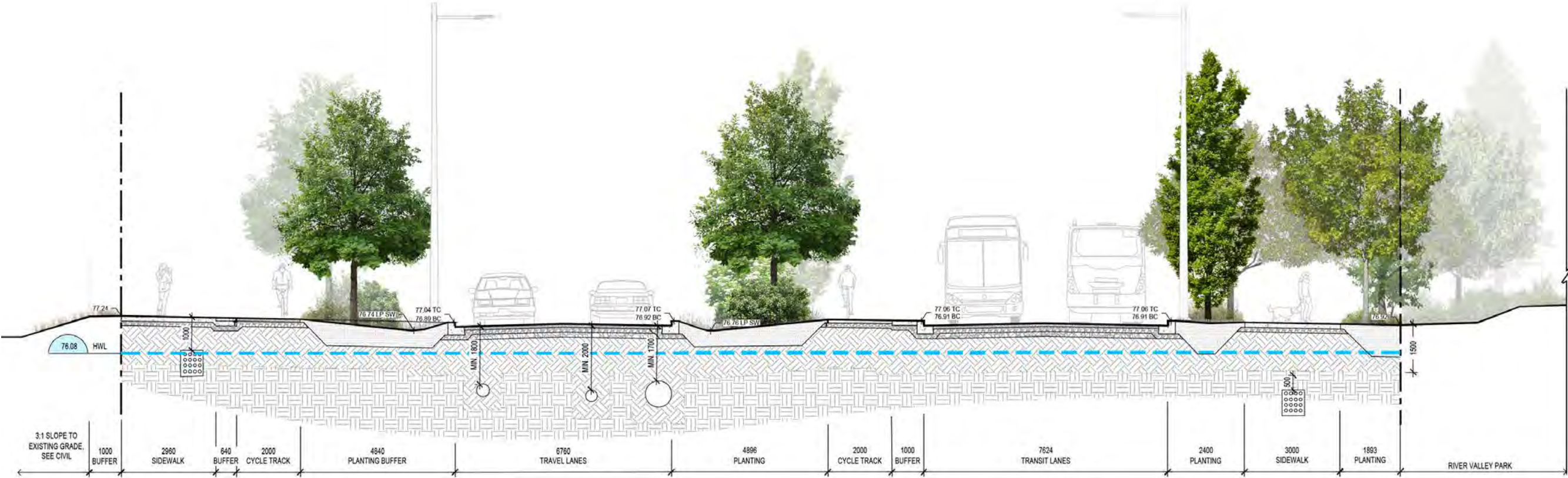

Former Section with Dedicated Transit Lanes

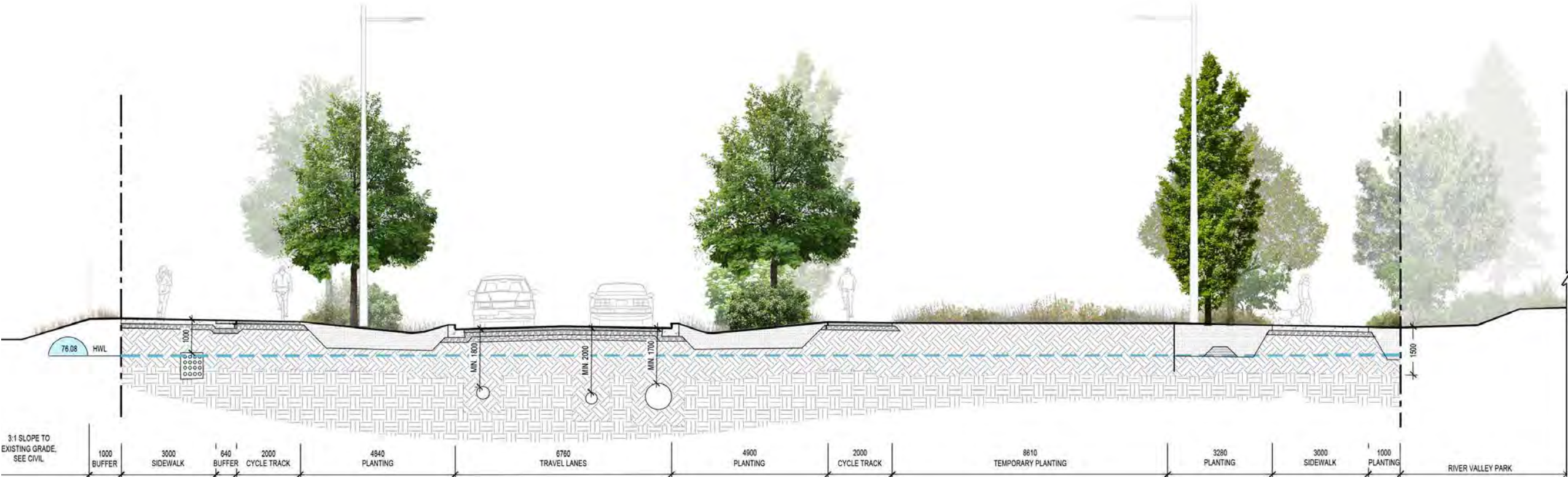

Current Section without Dedicated Transit Lanes



# CHERRY STREET & COMMISSIONERS STREET

Added southbound bus stop platform

One tree removed and minor adjustment to east edge of MGT trail to accomodate platform. Width of MGT remain at min. 4.0m.

No change to planter, paving and furnishings

Adjustment to curb to accomodate platform and bus movement

Shorter pedestrian crossing

Removed lay-by to accomodate platform. Moved trees (and added 1 tree) where platform is located to this location.

Added eastbound bus stop platform

Shorter pedestrian crossing. Adjustment to cycle track alignment

Added westbound bus stop platform

Adjustment to curb to accomodate platform and bus movement. 5 columnar trees removed

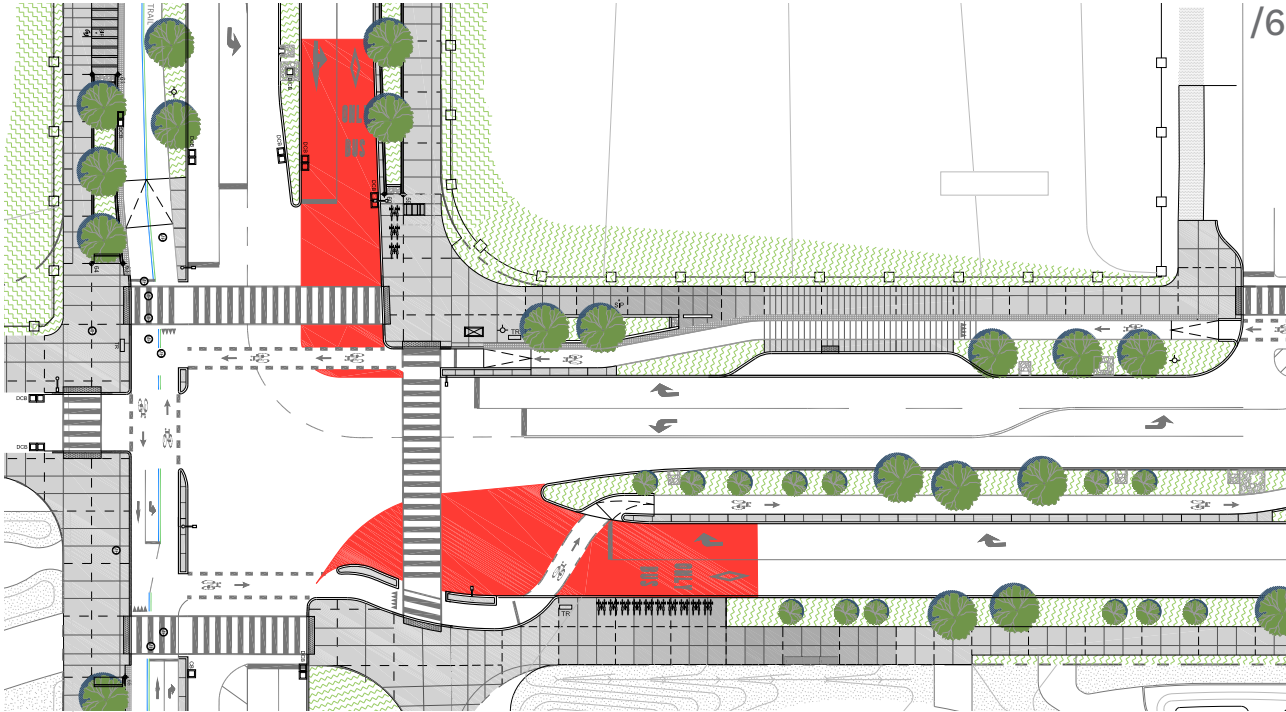

Former Plan

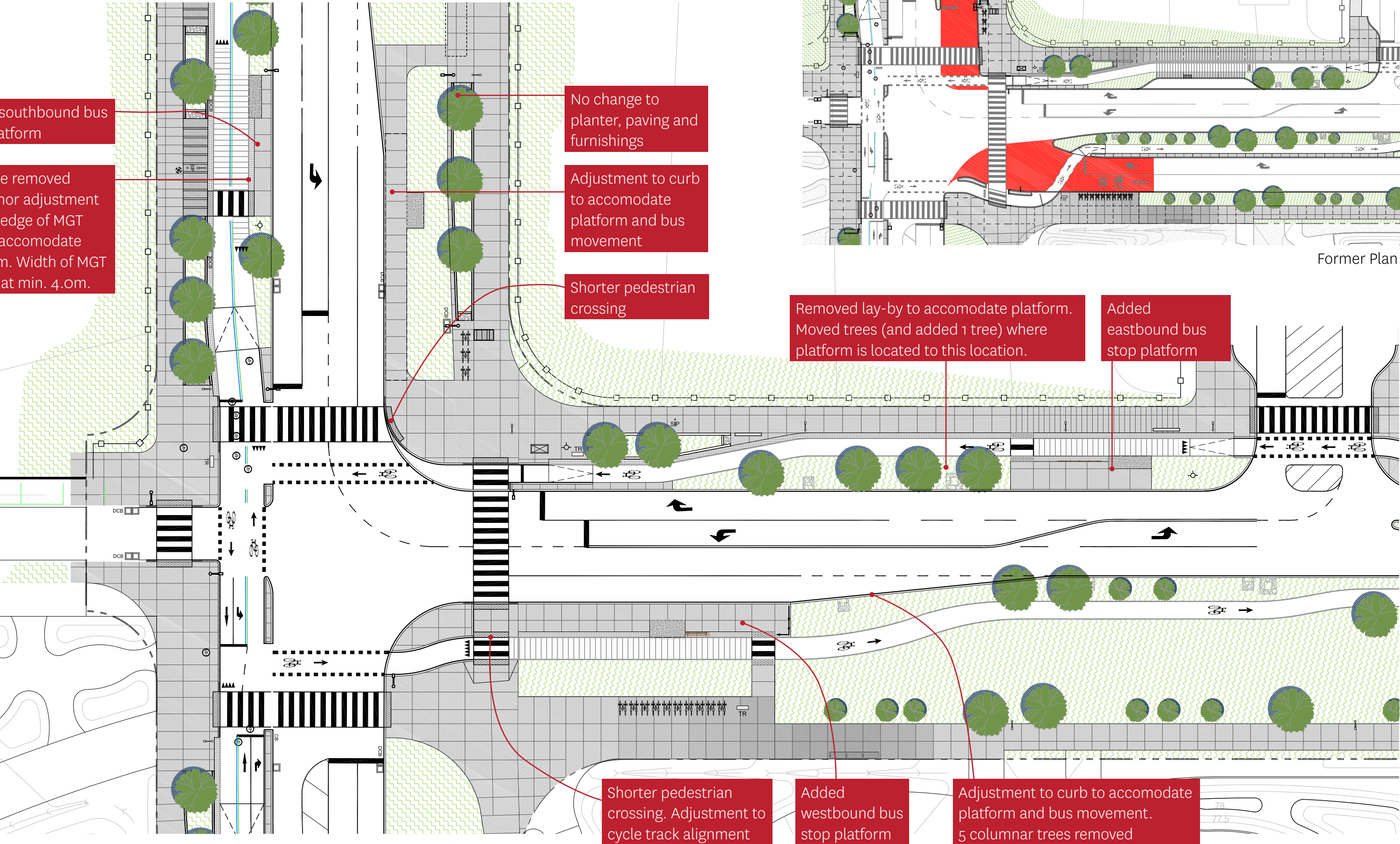



# COMMISSIONERS STREET & FUTURE MUNITION STREET

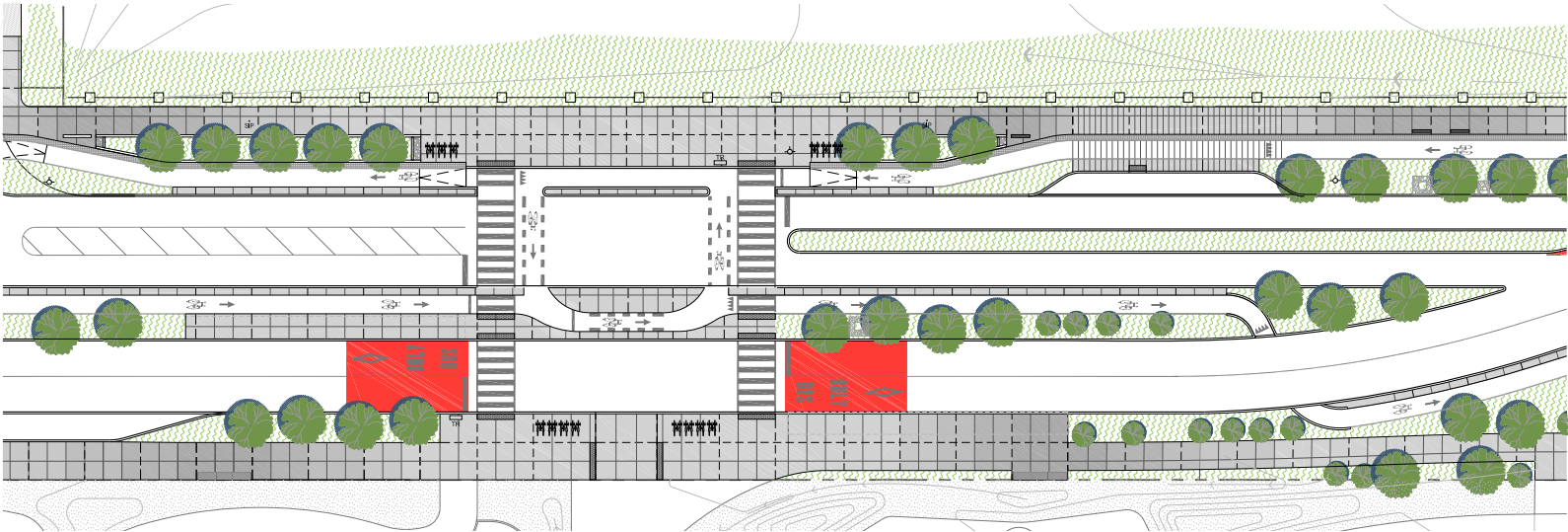

Former Plan

Added westbound bus stop platform

Removed planter and adjusted cycle alignment to accomodate platform and bus movement

Removed island, reduced curb-to-curb width, and added bioswales

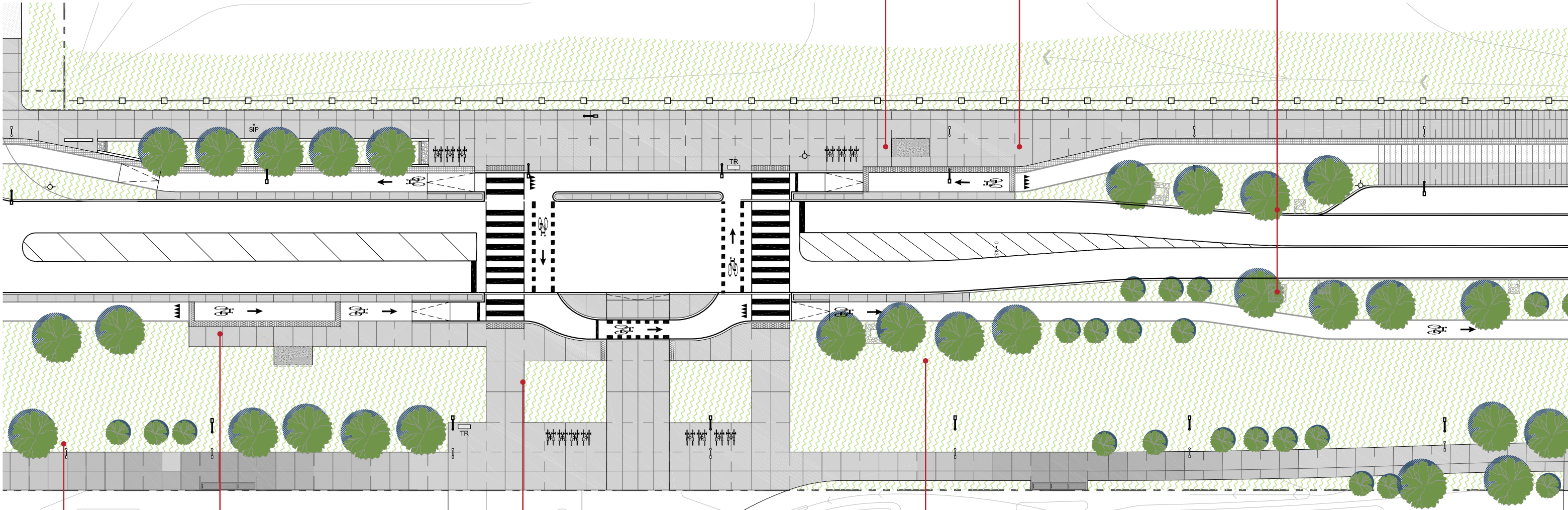

No change to planting, paving and furnishings

Added eastbound bus stop platform

Added paving to provide access into Park

Removed curbs and added root barrier to protect for future construction



MID-BLOCK CROSSING

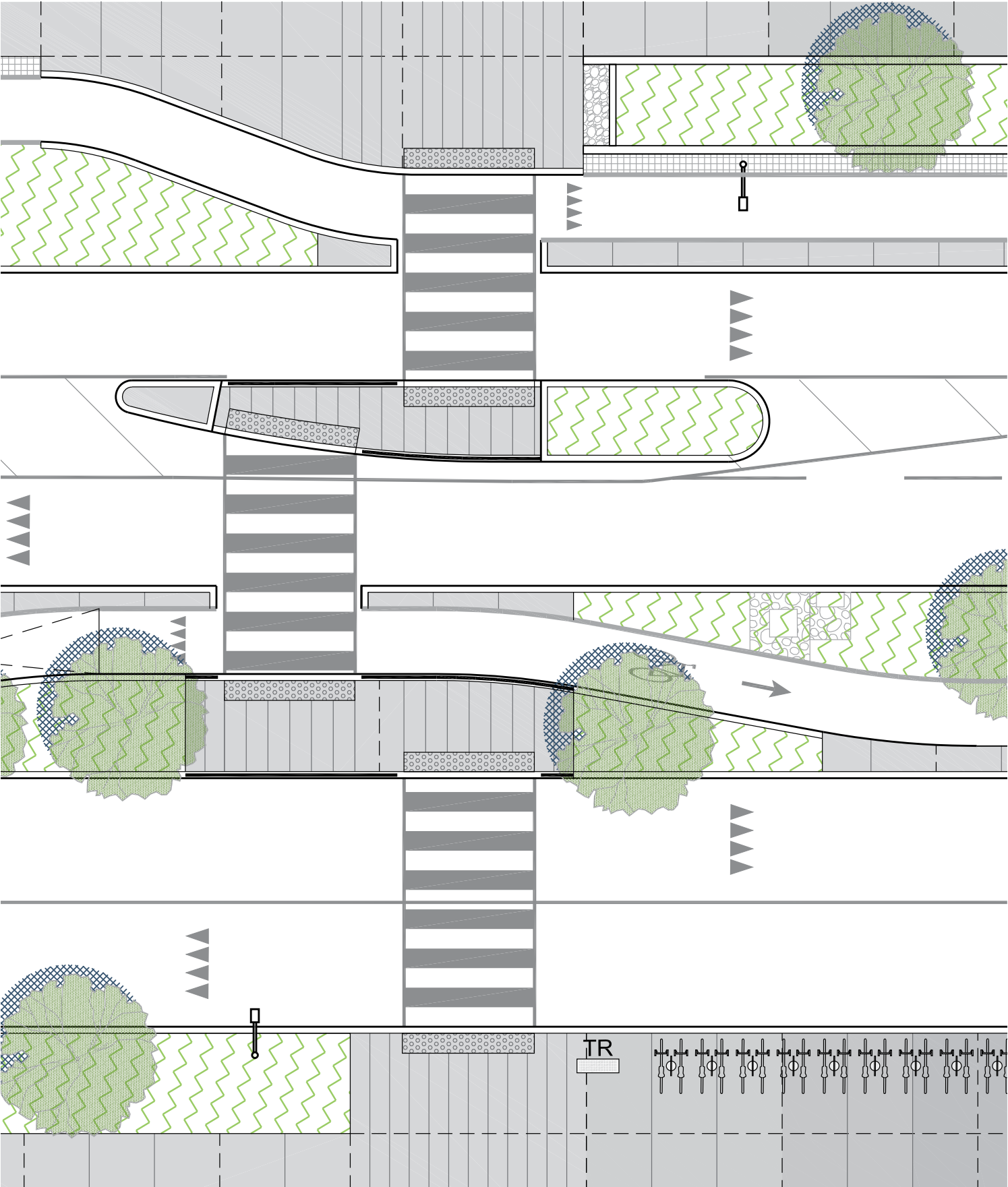

FORMER PLAN

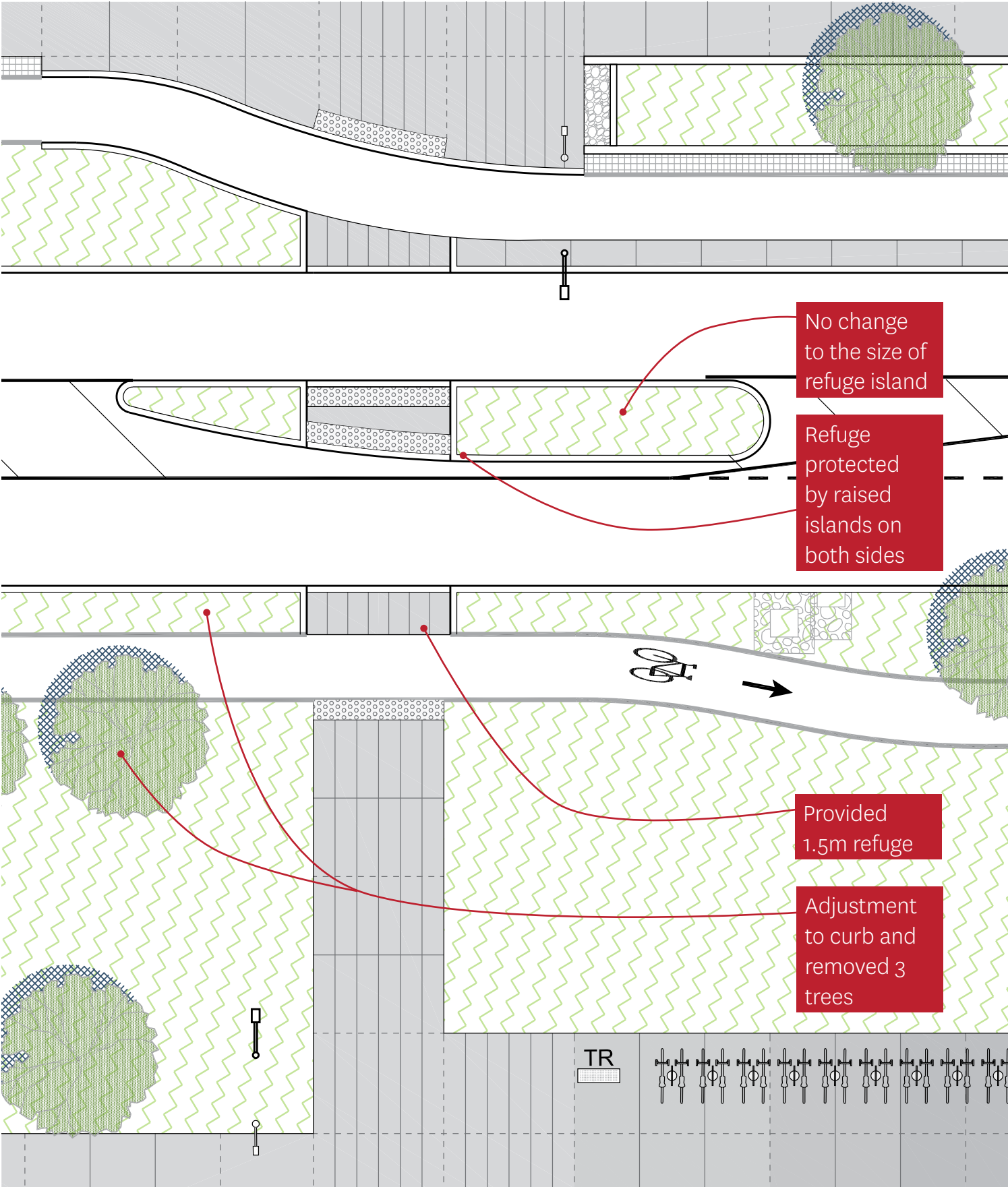

CURRENT PLAN

**Liam Mahoney, West 8**  
**Michael Ormston-Holloway,**  
**Planning Partnership**

# Where are we now?

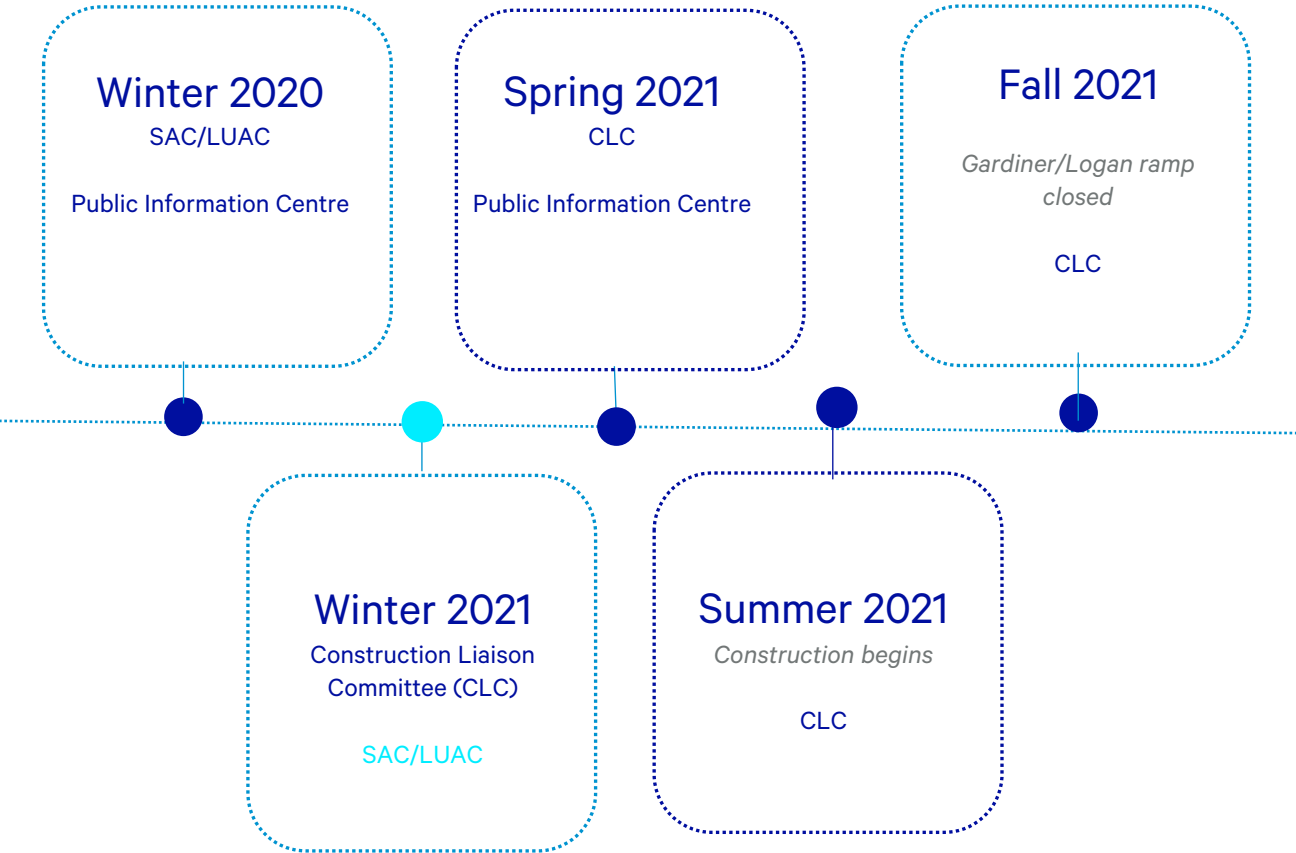

- Opening Lake Shore Bridge eastbound: Spring 2023
- Opening Lake Shore Bridge westbound
- Construction complete: Winter 2024

# Lake Shore Boulevard East Public Meeting Feedback

- People liked the approach to planting/landscaping
- Emphasis on safety for pedestrians and cyclists
- Support for infrastructure like water fountains, bike rings
- Aesthetic suggestions
- Design for all times of day and seasons
- ‘Future-proof’ for higher usage in future





# Lake Shore Boulevard East Public Realm - Don River to Carlaw Avenue SAC Presentation Update

March 12, 2021

# Agenda

**1. Project Context**

**2. Public Realm Design Updates**

**3. Planting Updates**

# Project Context



# Project Area: Lake Shore Boulevard East Bridge and Public Realm



# Lake Shore Boulevard Public Realm Design Vision - Objectives

- 1 Design an **urban civic boulevard** with a distinct **continuous landscape identity**
- 2 Prioritize **traffic calming** measures and **enhance public realm experience and safety**
- 3 Improve **East-West connectivity** through rebalanced multimodal mobility
- 4 Improve **North-South connectivity** through enhanced intersections
- 5 Design for **sustainable operations and maintenance** for public realm

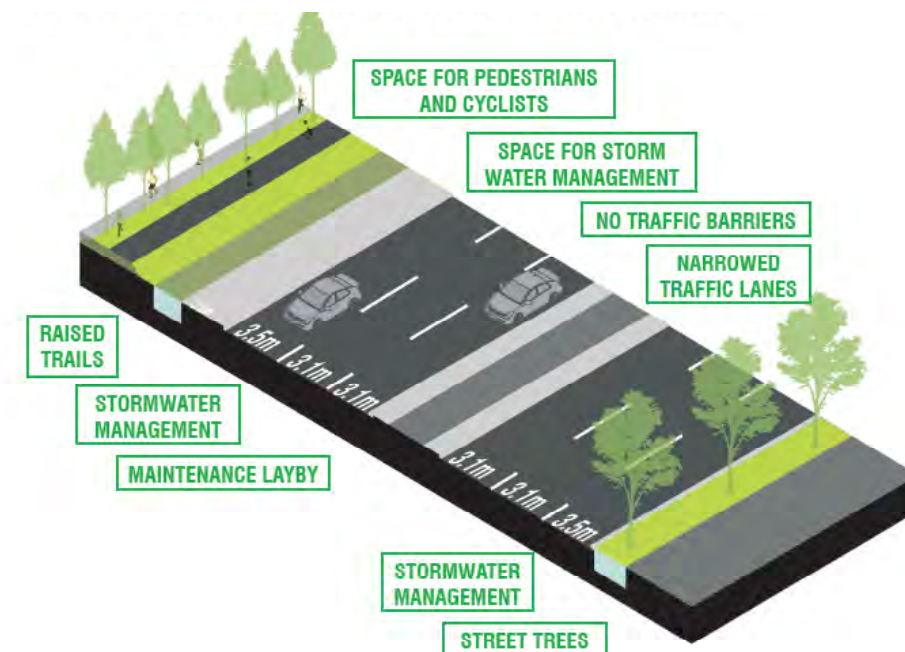
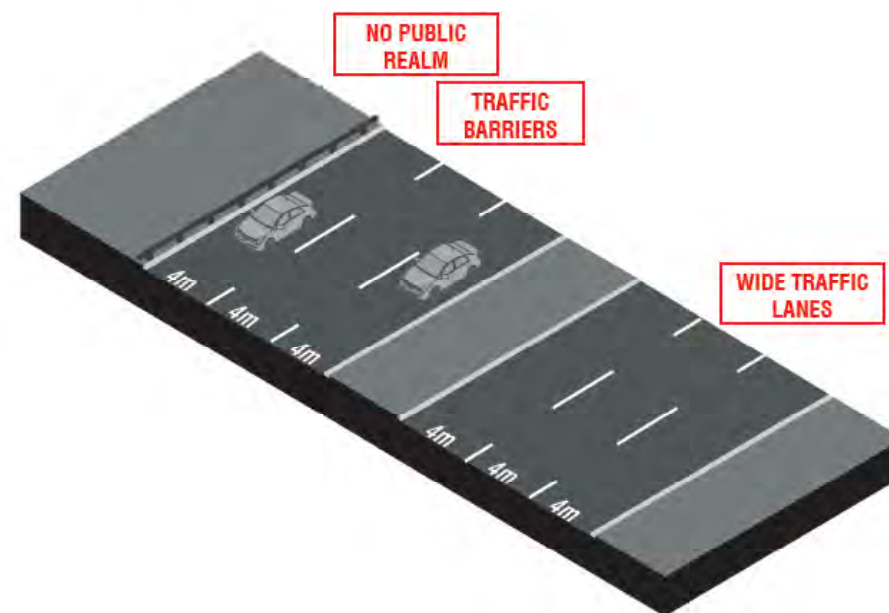



## **Project Context:**

**The Gardiner and Lake Shore Boulevard design has been shaped by:**

- 1. The approved Gardiner Expressway and Lake Shore Boulevard Reconfiguration EA and Urban Design Study (2017)**
- 2. Lake Shore Boulevard East Public Realm Vision, Phasing and Implementation Plan (2020)**
- 3. Ongoing detailed design work**
- 4. October 21 DRP Presentation, November 9th SAC Presentation, November 13th LUAC Presentation, December 4th PIC Presentation**

# Public Realm Design

# Project Overview

## Updated Areas

**Area 1** - Lake Shore  
Boulevard Bridge

**Area 5** - Logan Avenue to  
Carlaw Avenue



Future Improvement Zone  
- Setbacks Adjacent to  
New Development





# Area 1 - Lake Shore Boulevard Bridge

## Expanded Public Realm - Updated

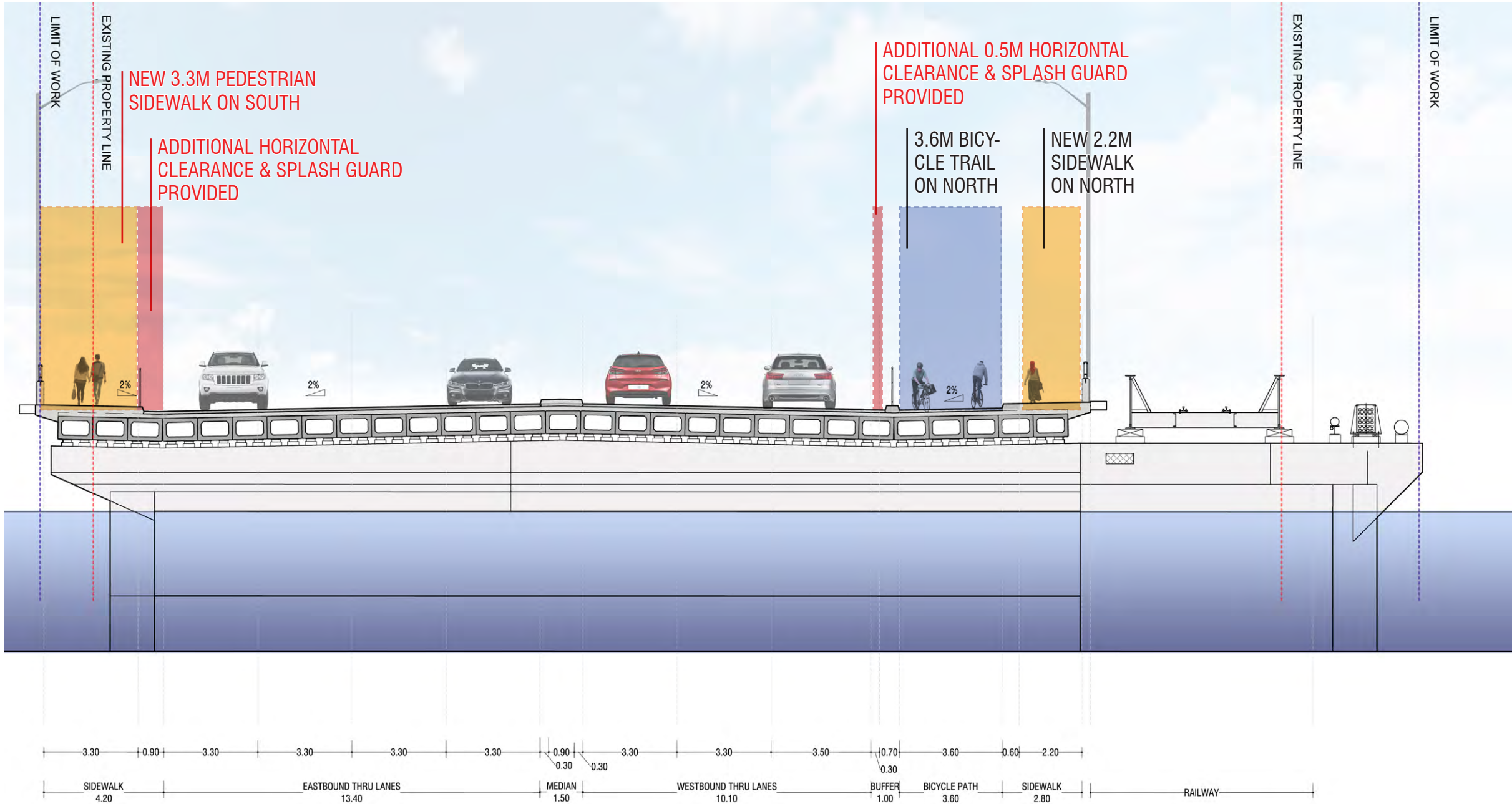



# Area 5 - Logan Avenue to Carlaw Avenue

## Protected and Side by Side Trails

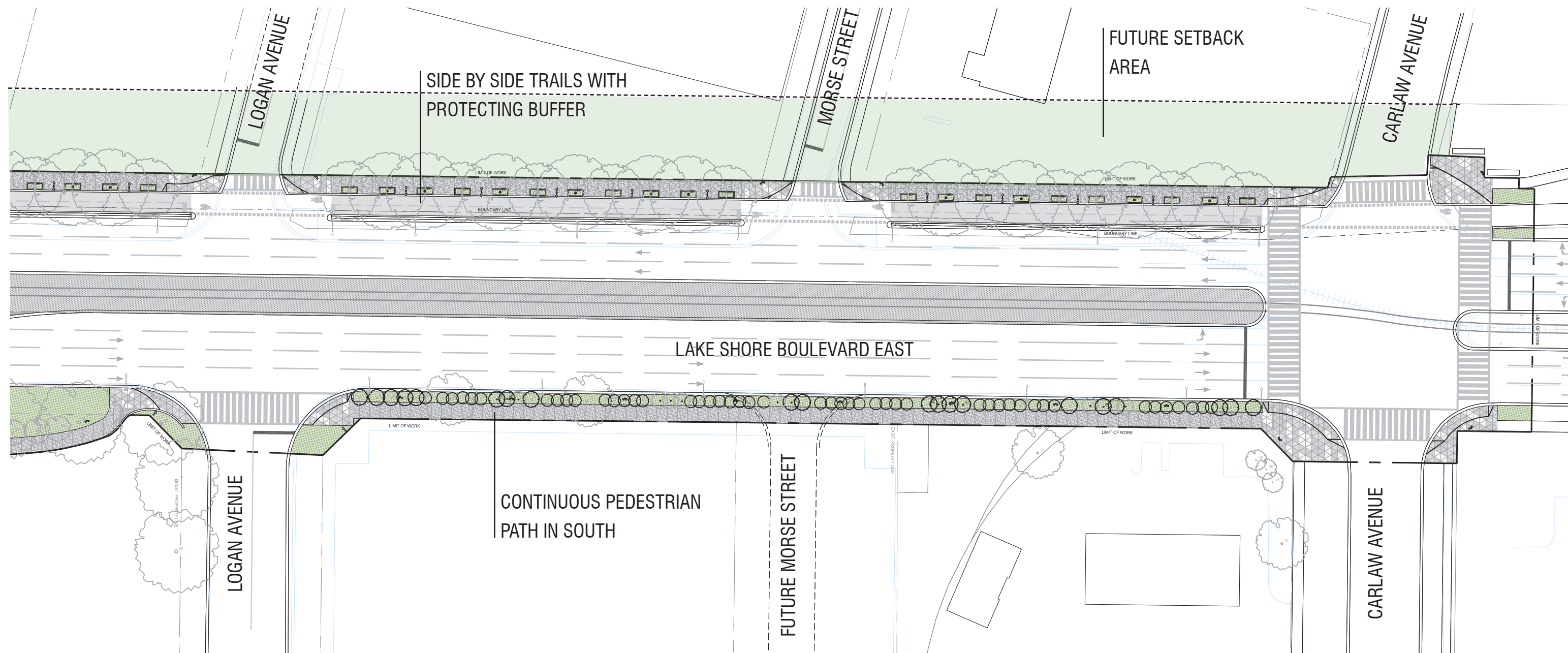

<b>LEGEND</b>					
<b>MATERIALS - SOUTH SIDE BOULEVARD</b>	<b>MATERIALS - NORTH SIDE TRAIL</b>	<b>MATERIALS - INTERSECTIONS AND ROAD</b>	<b>PROPOSED LIGHTING</b>	<b>FUTURE DEVELOPEMENT</b>	<b>LEGEND - PLANTING</b>
PERMEABLE UNIT PAVERS	ASPHALT BICYCLE PATH	PAVING PATTERN - 3 TYPES OF CONCRETE FINISH	LIGHTPOLE TYPE III	DESIGN OF FUTURE BROADVIEW AVENUE	PROPOSED NEW TREE EXISTING TREE
<b>MATERIALS - MEDIANS</b>	CIP CONCRETE PAVING WITH BROOM FINISH	THERMOPLASTIC WHITE ROAD MARKINGS	<b>EXISTING SURVEY</b>	<b>PLANTING - REFER TO L-500 SERIES</b>	
ROUGH STONE TYPE 1 AGGREGATE, 2-4CM DIAMETER ON BRIDGE ONLY STORMWATER / PLANTING	ROUGH STONE TYPE 1 AGGREGATE, 2-4CM DIAMETER	SURVEY OF EXISTING CONDITIONS - EXISTING CURBS IN DARK BLUE	PROPOSED PLANTING AREA		



# Area 5 - Logan Avenue to Carlaw Avenue

## Protected and Side by Side Trails - Updated

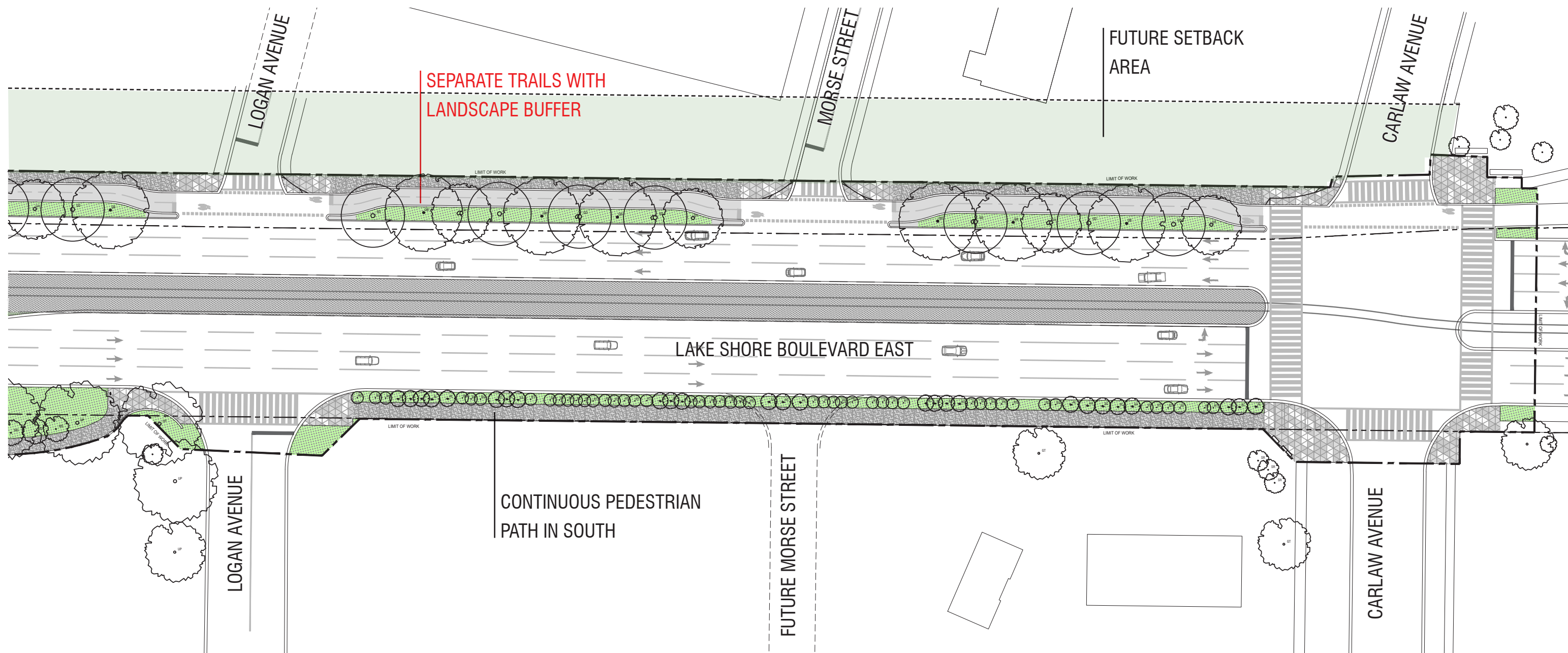

LEGEND					
<b>MATERIALS - SOUTH SIDE BOULEVARD</b>		<b>MATERIALS - NORTH SIDE TRAIL</b>		<b>MATERIALS - INTERSECTIONS AND ROAD</b>	
	PERMEABLE UNIT PAVERS		ASPHALT BICYCLE PATH		PAVING PATTERN - 3 TYPES OF CONCRETE FINISH
<b>MATERIALS - MEDIANS</b>					
	ROUGH STONE TYPE 1 AGGREGATE, 2-4CM DIAMETER ON BRIDGE ONLY		CIP CONCRETE PAVING WITH BROOM FINISH	THERMOPLASTIC WHITE ROAD MARKINGS	
	STORMWATER / PLANTING		ROUGH STONE TYPE 1 AGGREGATE, 2-4CM DIAMETER		
<b>PROPOSED LIGHTING</b>		<b>FUTURE DEVELOPEMENT</b>		<b>LEGEND - PLANTING</b>	
<b>EXISTING SURVEY</b>		<b>PLANTING - REFER TO L-500 SERIES</b>			



# Area 5 - Logan Avenue to Carlaw Avenue

## Protected and Side by Side Trails

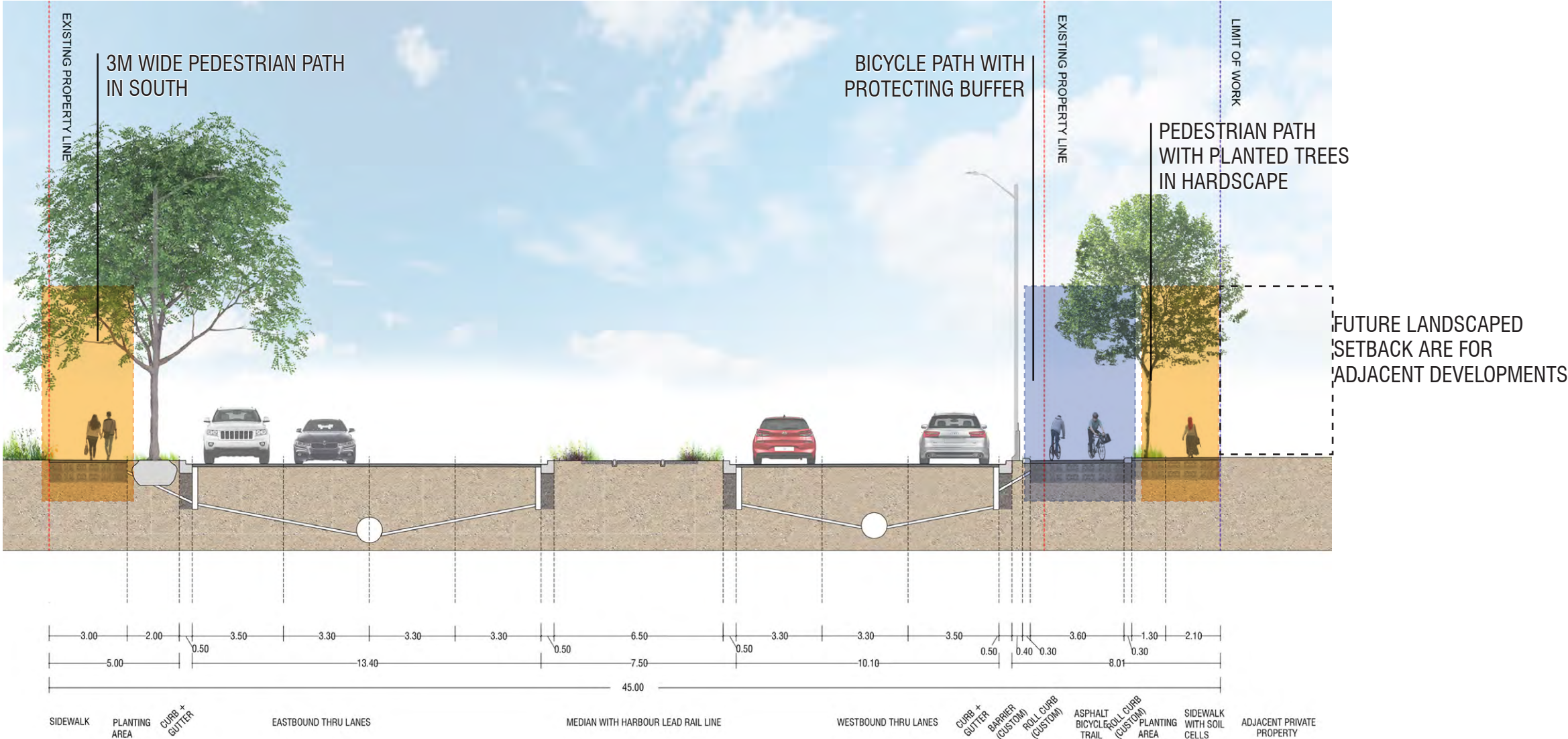



# Area 5 - Logan Avenue to Carlaw Avenue

Protected and Side by Side Trails - Updated

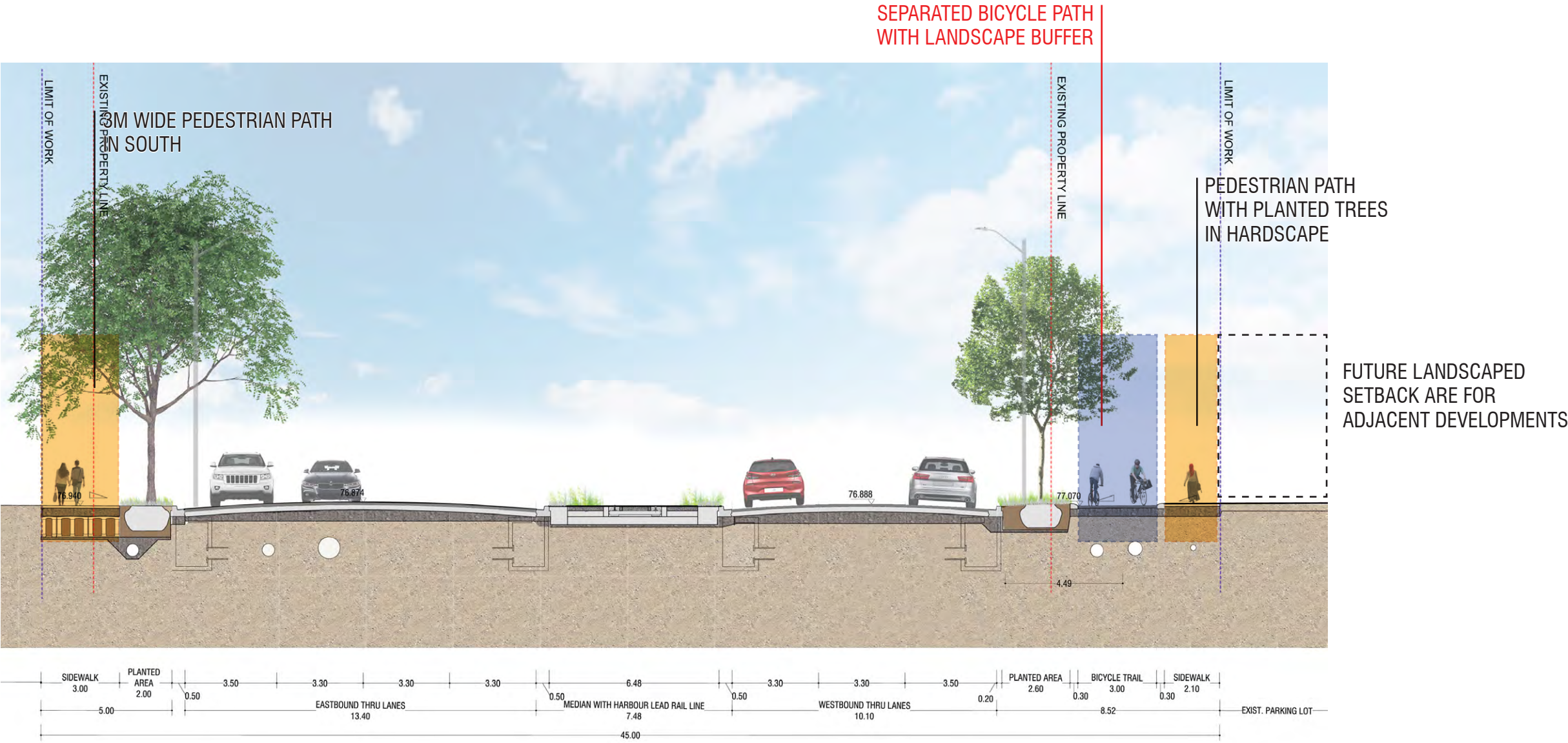



# Public Realm Design

## Resting Area “Pocket Parks”

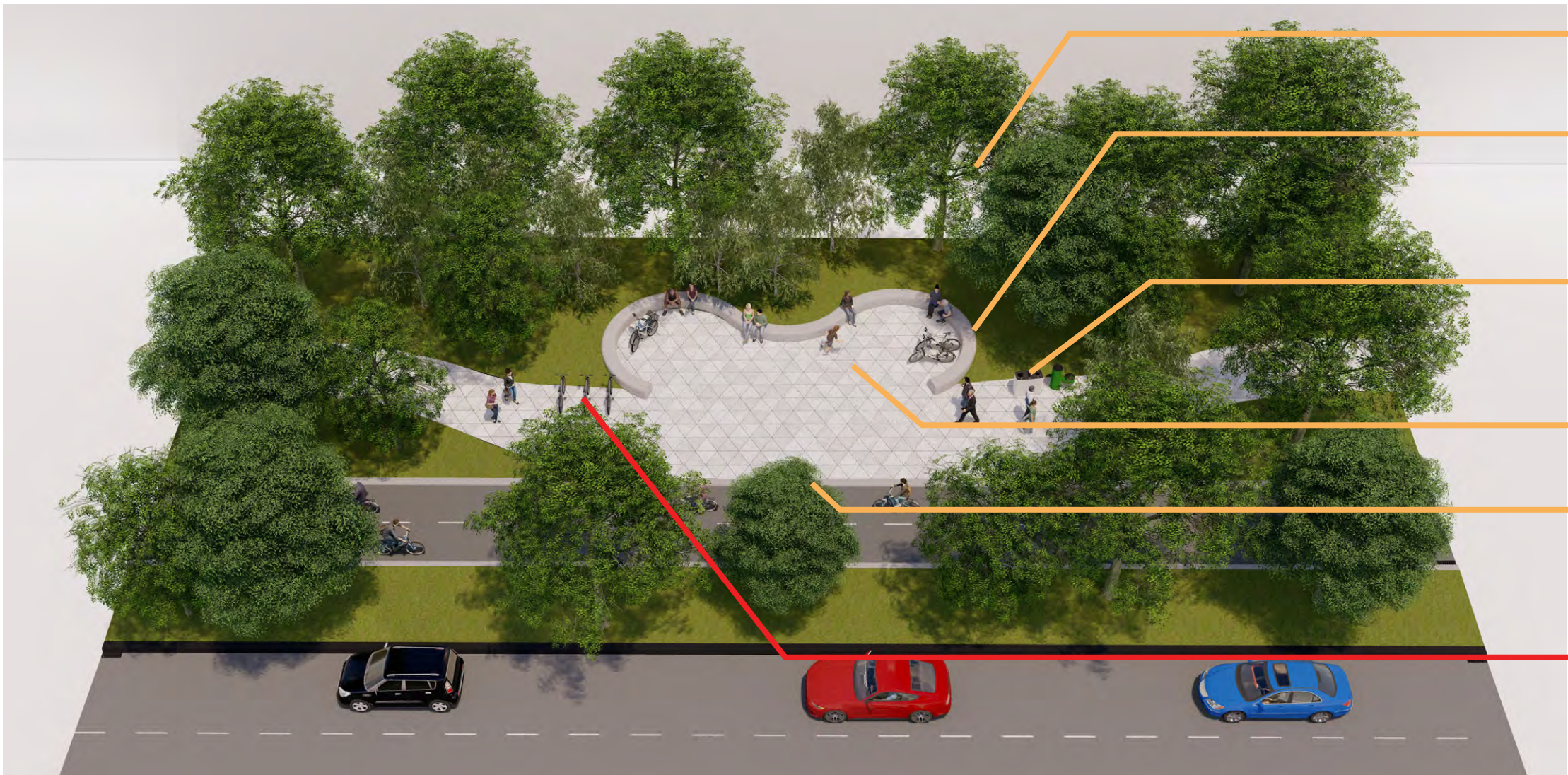

- Raised Planting Bed for Trees and Shrubs
- Concrete Social Seating Circle
- Drinking fountain & Waste Receptacles
- Special Paving at Pocket Park Matches Intersection Corners
- Rolled Curb at Bicycle Path: cyclists stop and dismount to use rest area
- Bicycle Parking Racks Added



# Public Realm Design

## Additional Seating Areas

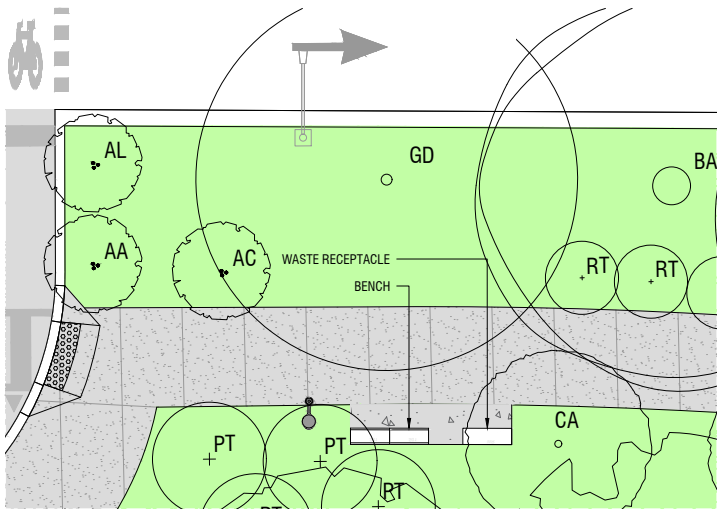
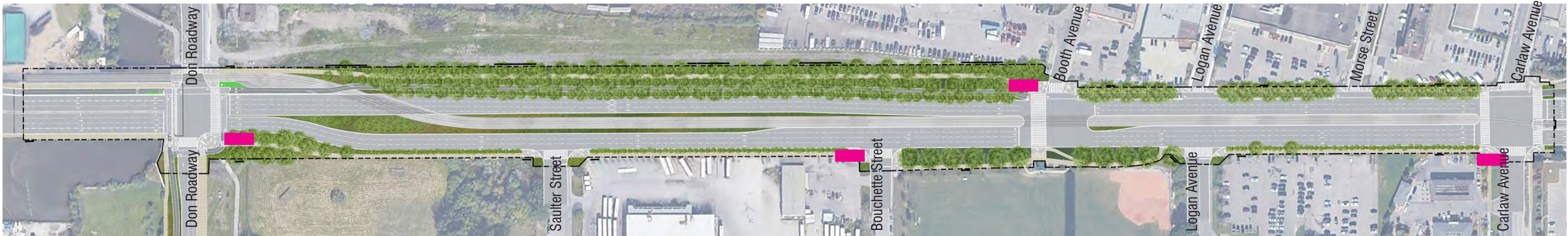

Don Roadway

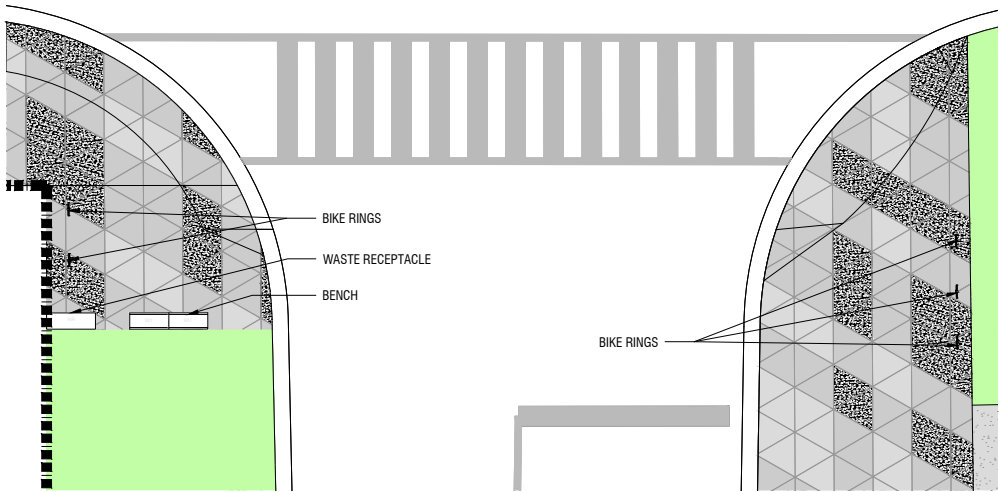

Bouchette St

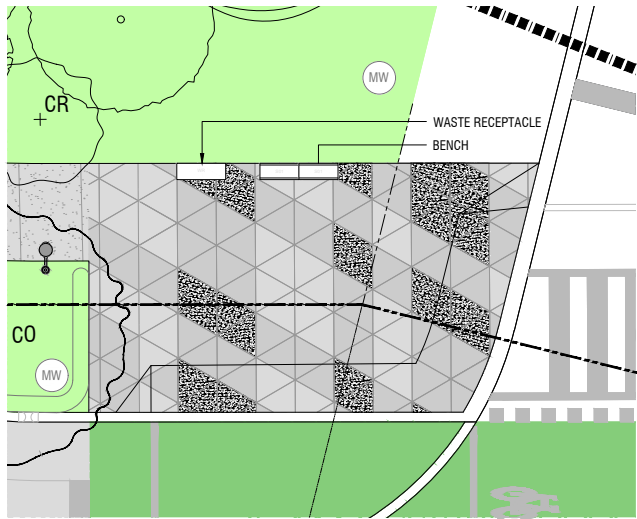

Booth Ave

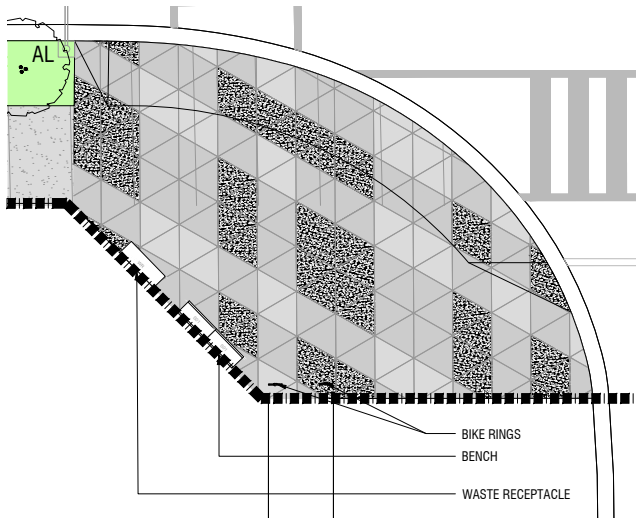

Carlaw Ave

# Planting Updates



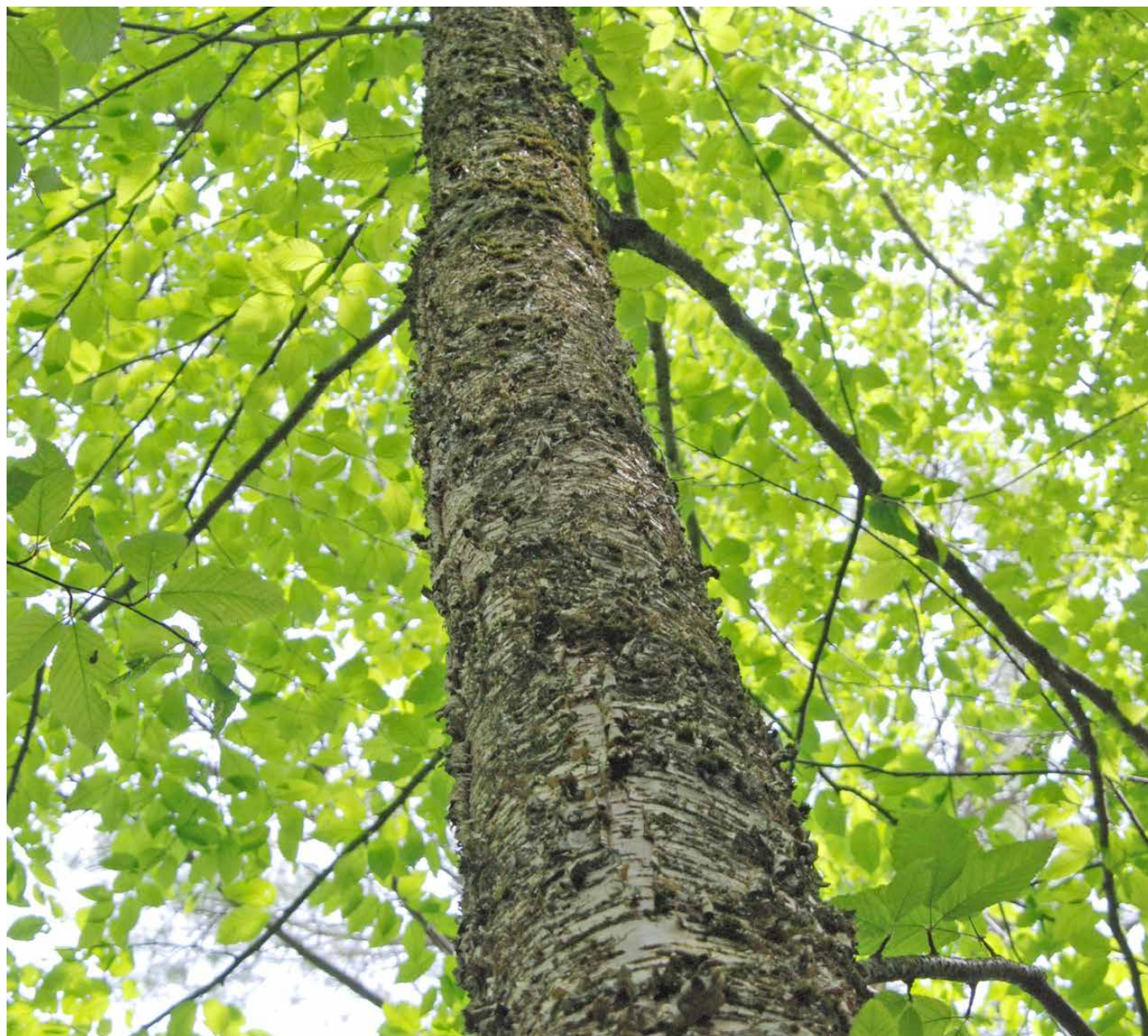

- **Black Alder (*Alnus glutinosa*) removed from plant list**
- **Yellow Birch (*Betula allagheniensis*) removed from boulevard**
- **Additional species added for pollinators, seasonal colour**
- **Swale species added, tolerant of varied moisture conditions**



# Planting Palette Expansion for Native Species, Pollinators & Seasonal Colour



*Achillea millefolium*



*Achillea millefolium* 'Lilac Beauty'



*Anaphalis margaritacea*



*Asclepias incarnata*



*Campanula rotundifolia*



*Fragaria virginiana*



*Geum Triflorum*



*Solidago flexicaulis*



*Solidago sphacelata* 'Golden Fleece'

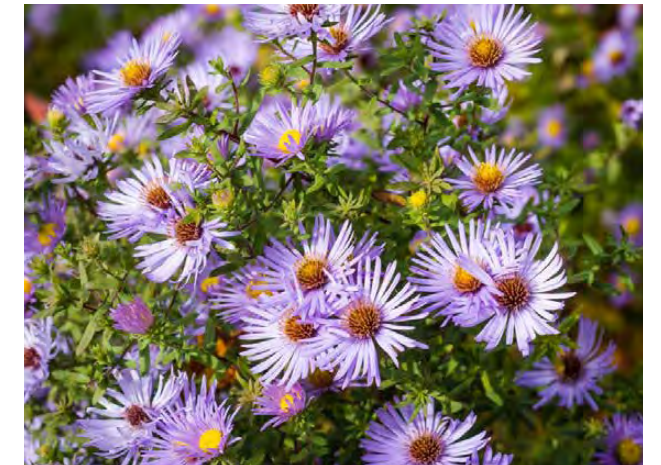

*Symphyotrichum oblongifolium*  
'October Skies'



*Viola sororia*



# Tier 2 - Additions to Swale Planting Palette



*Anemone canadensis*



*Carex eburnea*



*Carex pensylvanica*



*Chelone glabra*



*Hierochloa odorata*



*Iris versicolor*



*Lobelia cardinalis*



*Lobelia siphilitica*



*Schizachyrium scoparium* 'Prairie Blues'



**Sean Decloux & Ken Dion,  
Waterfront Toronto**

# Design in Vicinity of the Lake Shore Bridge

No.	Considerations / Components
1	Sediment Trap
2	Potential Sediment Trap Extension
3	Reserved Area for Sediment and Debris Management and Operations
4	Debris Boom
5	Proposed Secondary Debris Boom
6	Barge Dock
7	Service Road
8	Don Valley Trail Extension Concept
9	Sediment Hydraulic Conveyance – Potential Connections
10	Adjustable Upstream Weir
11	Sideflow Weir
12	Potential Location for CSO Shafts
13	Lengthening of the Lake Shore Boulevard Bridge
14	Removal of the Pedestrian Bridge
15	Removal of the Hydro One bridge



Per Original EA



Proposed Modification



Approved EA, Ref: Chapter 6, Pg. 6-20

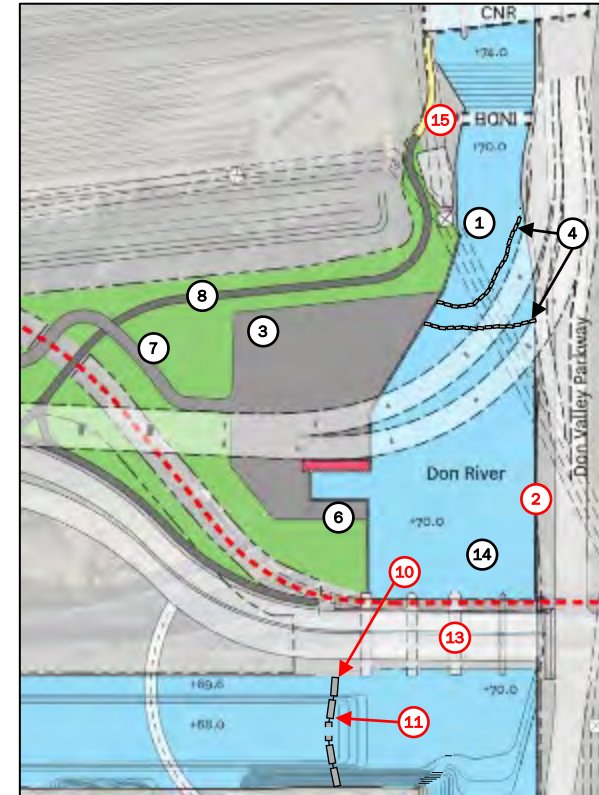

Current Design

DMNP EA, 6-20: The final layout of the Sediment and Debris Management Area, including existing recreational facilities, will be determined during detailed design



# Design in Vicinity of the Lake Shore Bridge

The following design is being advanced in the vicinity of the Lake Shore Bridge (starting from the north):

- ⑮ The Hydro One Bridge will remain in place
- ② The river upstream will match the length of the Lake Shore Bridge, and will be ~98m wide
- ⑬ The Lake Shore Bridge will be 4 bays (~98m) instead of 5 bays (~120m)
- ⑩ ⑪ A detachable flow curtain will be installed in the Keating Channel

These change will not impact Regulatory flood conveyance nor sediment management operations north of the Lake Shore Bridge



# Design in Vicinity of the Keating Channel

The following design is being advanced in the vicinity of the Keating Channel:

- ① 2-3 habitat shoals will be provided immediately (pending dredging)
- ② Localized revetment along dockwall will be provided immediately

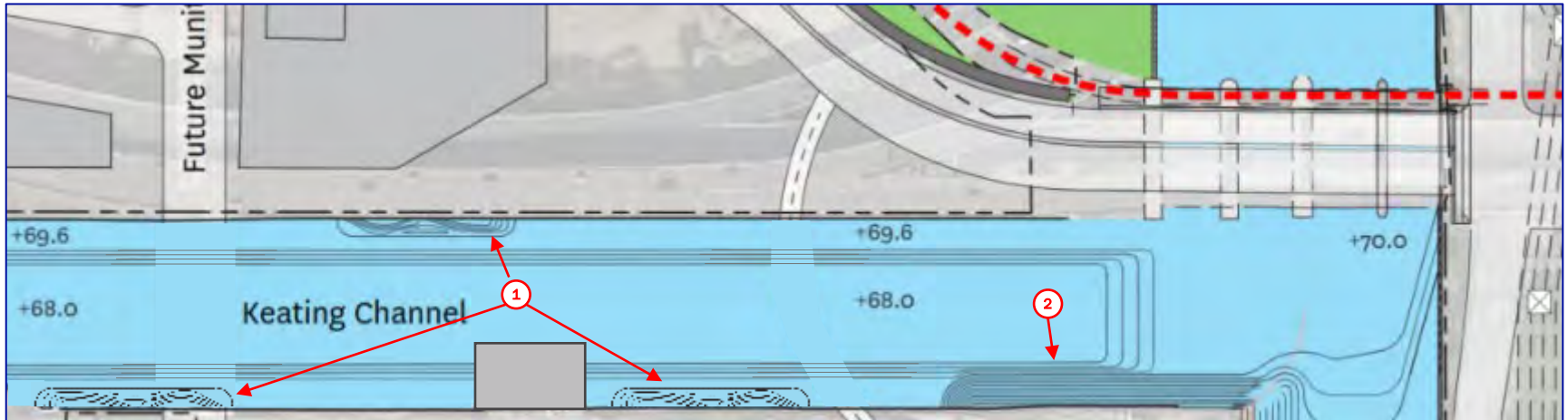

*Keating Channel Proposed Revetment and Habitat Shoals*  
*\*Flow Curtain not Shown*



**Herb Sweeney, MVVA**

# **Port Lands Flood Protection & Enabling Infrastructure Stakeholder Advisory Committee Meeting #10**

Prepared for Waterfront Toronto  
March 12, 2021



## Parks Design Schedule

- January 23, 2020 - 100% Design (IFC) Submission (River)
- July 2020 – Indigenous Advisory & Design Consultant Engaged as part of MVVA Team
- October 2020 - January 2021 – Indigenous Community Consultation Meetings
- February 11, 2021 – 90% Design (IFT) Submission (Parks)
- **March 12, 2021 – SAC Meeting #10**
- June 1, 2021 – 100% Design (IFC) Submission (Parks)
- December 2023 – Construction Complete

# The Port Lands - 2024





# Indigenous Design Consultation Process

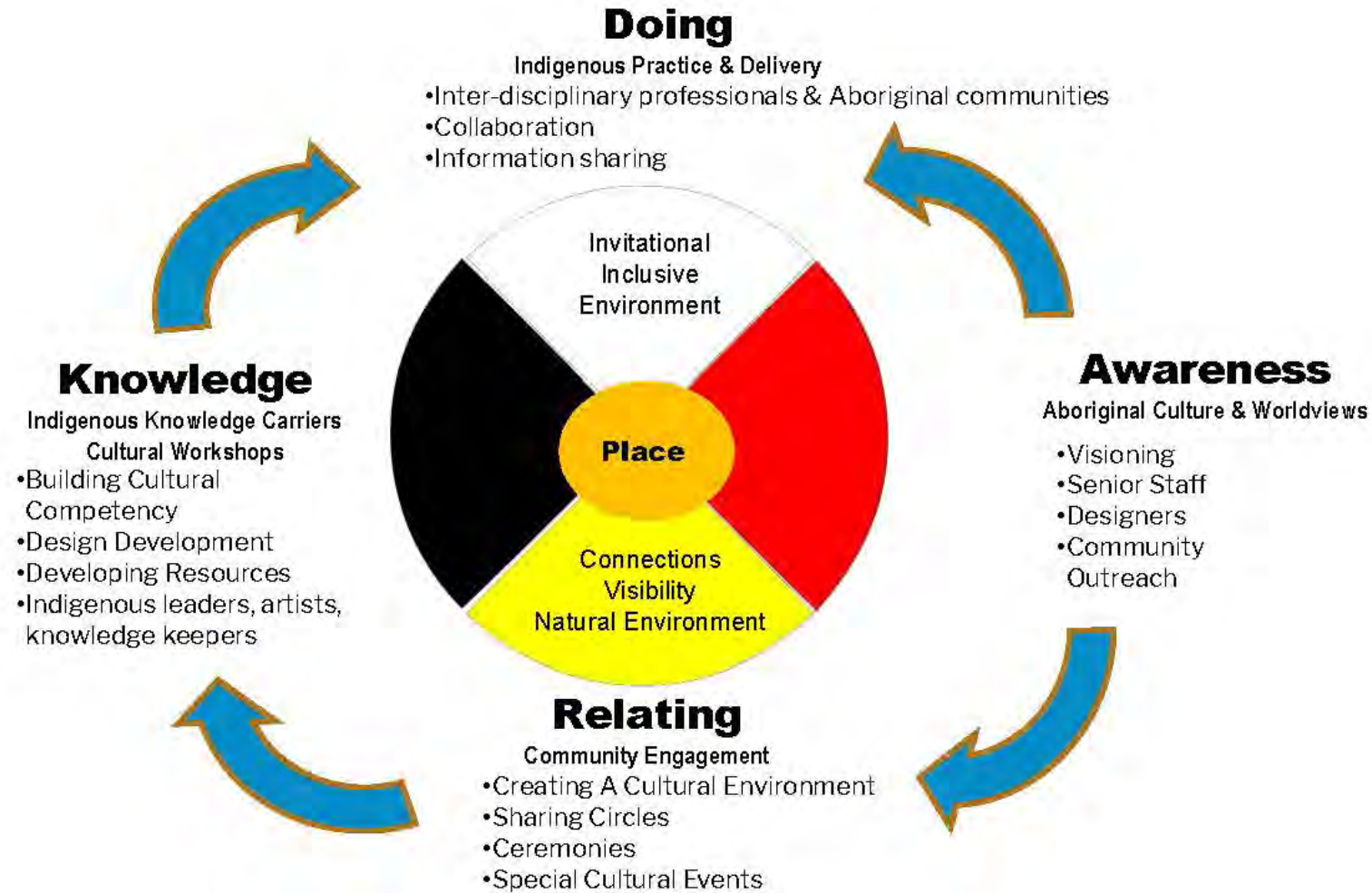

Four Directional Cultural Framework

## Community Engagement Schedule

### First Nation Groups:

- Rama
- Beausoleil/ChiMnissing
- Georgina Island
- Huron/Wendat
- Alderville
- Scugog
- Curve Lake

### Urban Indigenous Organizations:

- NCCT/City of Toronto
- MiziweBiik/Toronto York Metis Council

8/25 Site Visit

9/11 Cultural Safety Training

9/8, 9/9, 9/16, 10/21, 11/18, 11/25, 1/6 Community Meetings



MinoKamik Collective, WT and ED at PLFP Site

# Community Engagement Questions

- 1. Historical Information** - What major historical events or milestones could be included throughout the site or at specific areas?
- 2. Cultural Markers in the Landscape** - What creative/artistic work would you recommend in relation to a contemporary land acknowledgement (visual examples of cultural markers will be provided)?
- 3. Community Celebration Spaces** - What type of gathering spaces could be incorporated into the project?
- 4. Indigenous Plants** - Are there specific Indigenous plants that you think could be restored/included?
- 5. Animal Life** - What animals would you like to see incorporated into the overall artistic and creative vision of the project?  
I.E. Clan symbols? Sculptures?
- 6. Landscape Features** - Can you recommend public inclusive spaces that would highlight water, stone features? What would that look like?
- 7. Indigenous Languages/Narratives** - What do you think might be incorporated?



# Initial Community Engagement Feedback

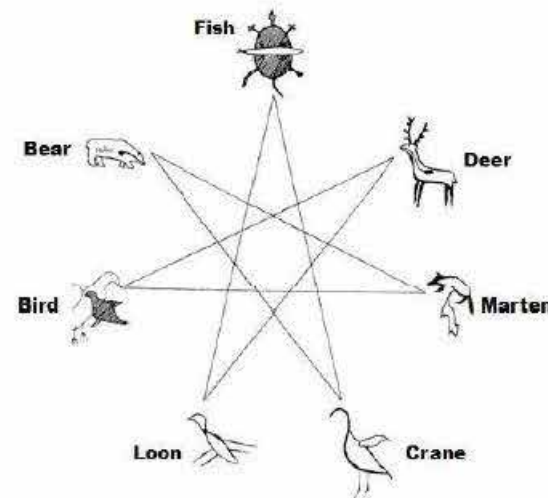
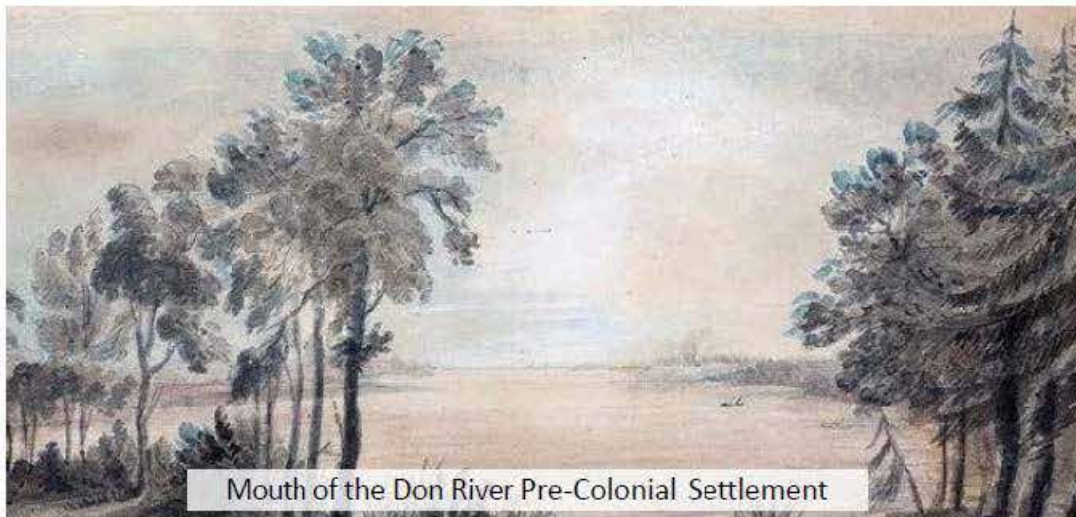

## HISTORY:

- The Great Migration Story
- Turtle Island Story
- Ashbridges Marsh and Cherry Spit as major historical gathering and fishing sites.
- Toronto Purchase and Treaty History.

## IDENTITY:

- Clan Based Family Structure
- Multiple Languages
- Sacred Symbols
- Cultural Narratives

## STEWARDSHIP:

- Renewing of the land, water and wildlife
- Medicinal and culturally significant plants

## INCLUSION:

- Indigenous ceremonies shared w/public (Powwow's, Moon, Sunrise, Water)
- Access to water's edge

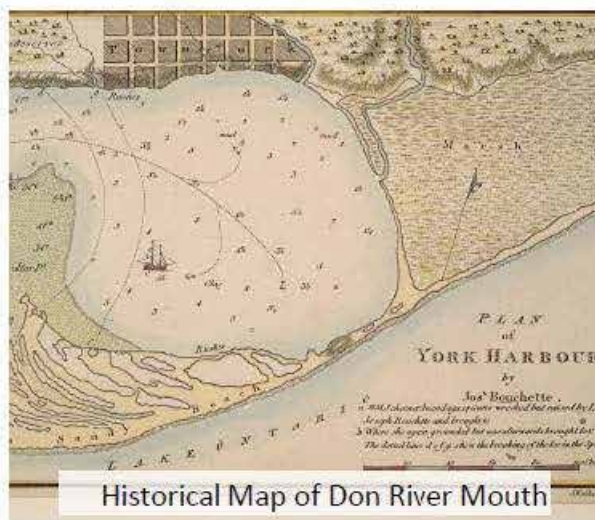



# Initial Design Approaches





## Parks and River Indigenous Design Opportunities

- **Indigenous Plantings** - Plants are proposed that have medicinal and cultural significance for the First Nation communities throughout the entire PLFP project. Within the play areas, plant identification/education could be highlighted.
- **Events and Ceremonies** - The Promontory Park South event lawn and River Valley Park North picnic lawn are being considered for smaller/larger pow-wows and events. A fire pit gathering place has been identified for other ceremonies at the edge of the Canoe Cove. The future Pavilion may be identified as an area that can support indigenous programming.
- **Cultural Markers in the Landscape** - A series of stopping points have been identified along the river path. The four directions, land acknowledgements, references to movement of Indigenous people, history of the site and other story telling of indigenous teachings could be reflected through features within the landscape.
- **Dodems as Nature Play Features** - Depiction of the clans is being considered within the Nature Play Area at River Valley Park North.

# History - Stopping Points on the River Path





# Stewardship - Parks And River Planting Design

- Plants selected that have medicinal and cultural significance for the First Nation communities.
- Plant identification/education could be highlighted within the play areas.

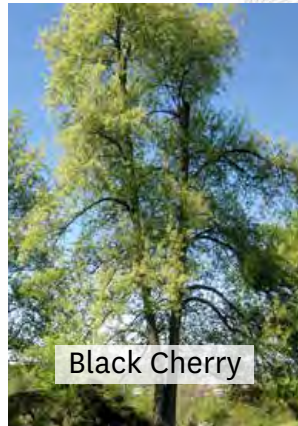
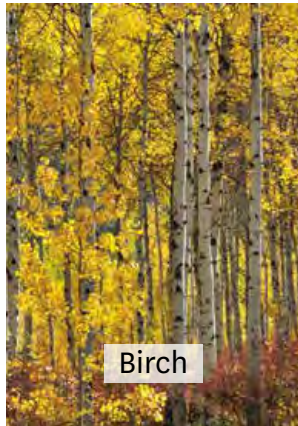



# Identity - Dodems as Nature Play Features

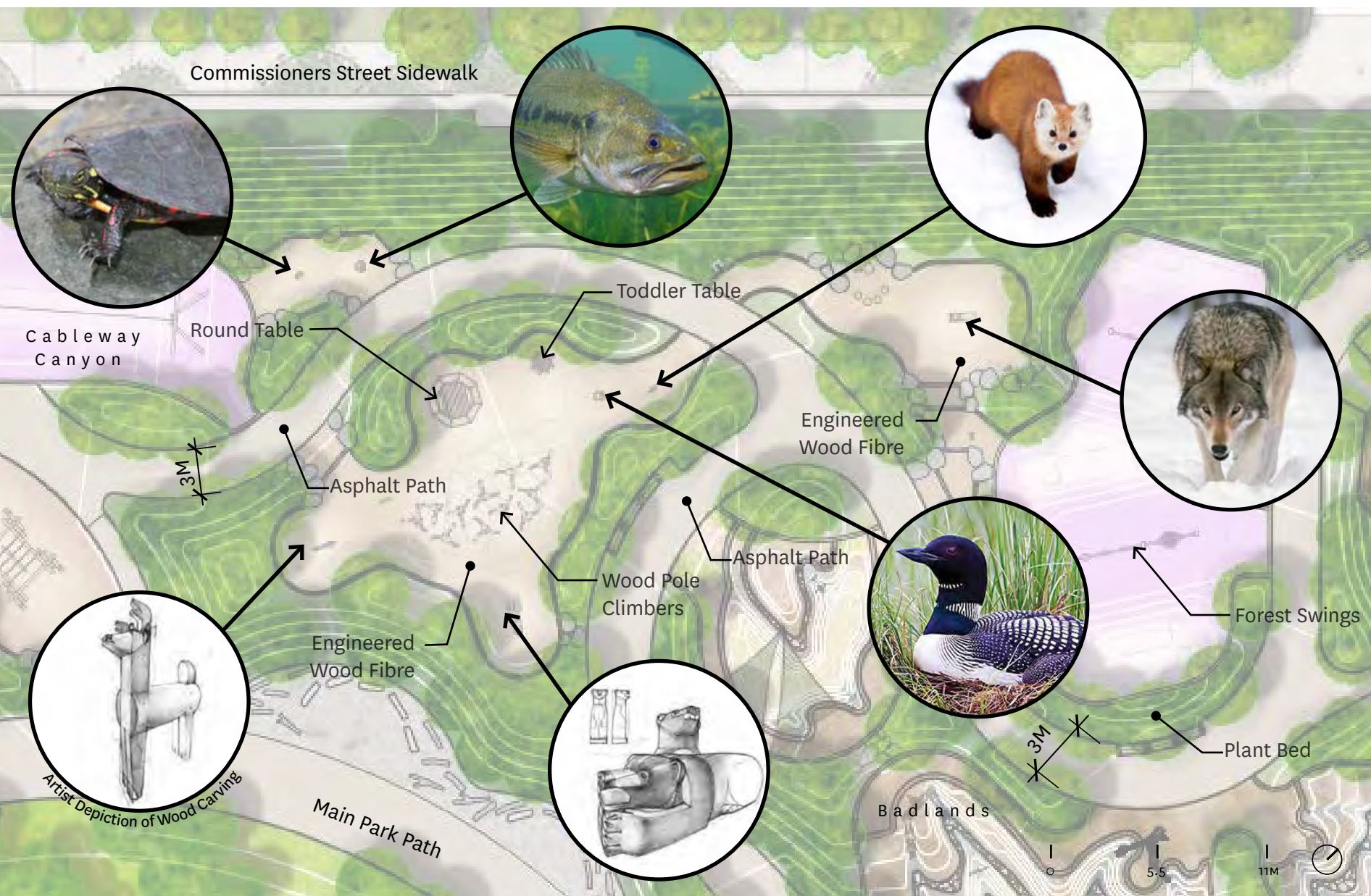

Update current design of play features to reflect Animals of the 9 Clans

- Bear
- Deer
- Marten
- Crane
- Fish
- Loon
- Bird (Eagle)
- Wolf
- Turtle

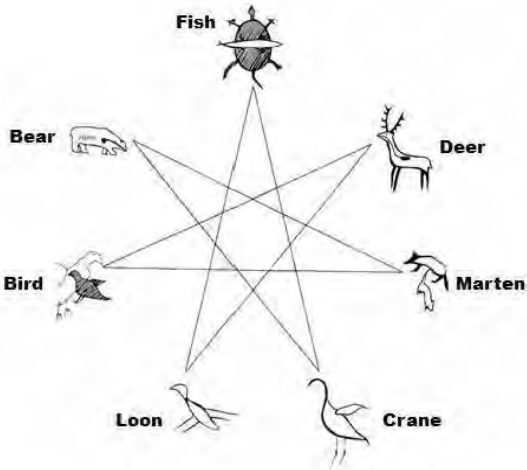

Clan System Diagram



# Inclusion - Fire Pit Gathering Space

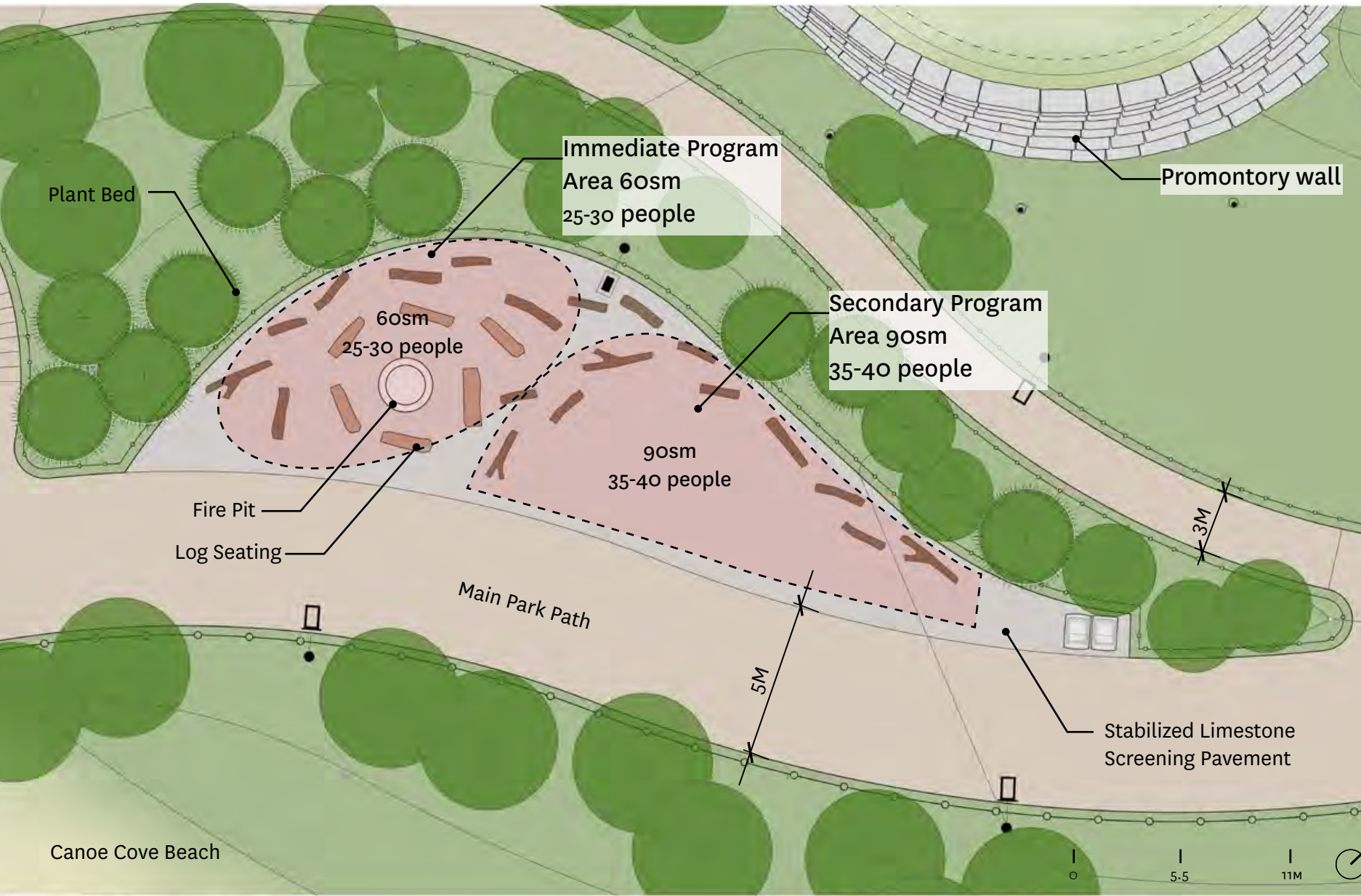

Total Fire Pit Gathering Space  
Program Area: 150sm  
Seating: 25 Log Seating Features  
Total People: **60-70 people (mix sitting and standing)**





# Regional Pow-Wow Programing Diagram

Toronto  
Inner  
Harbour

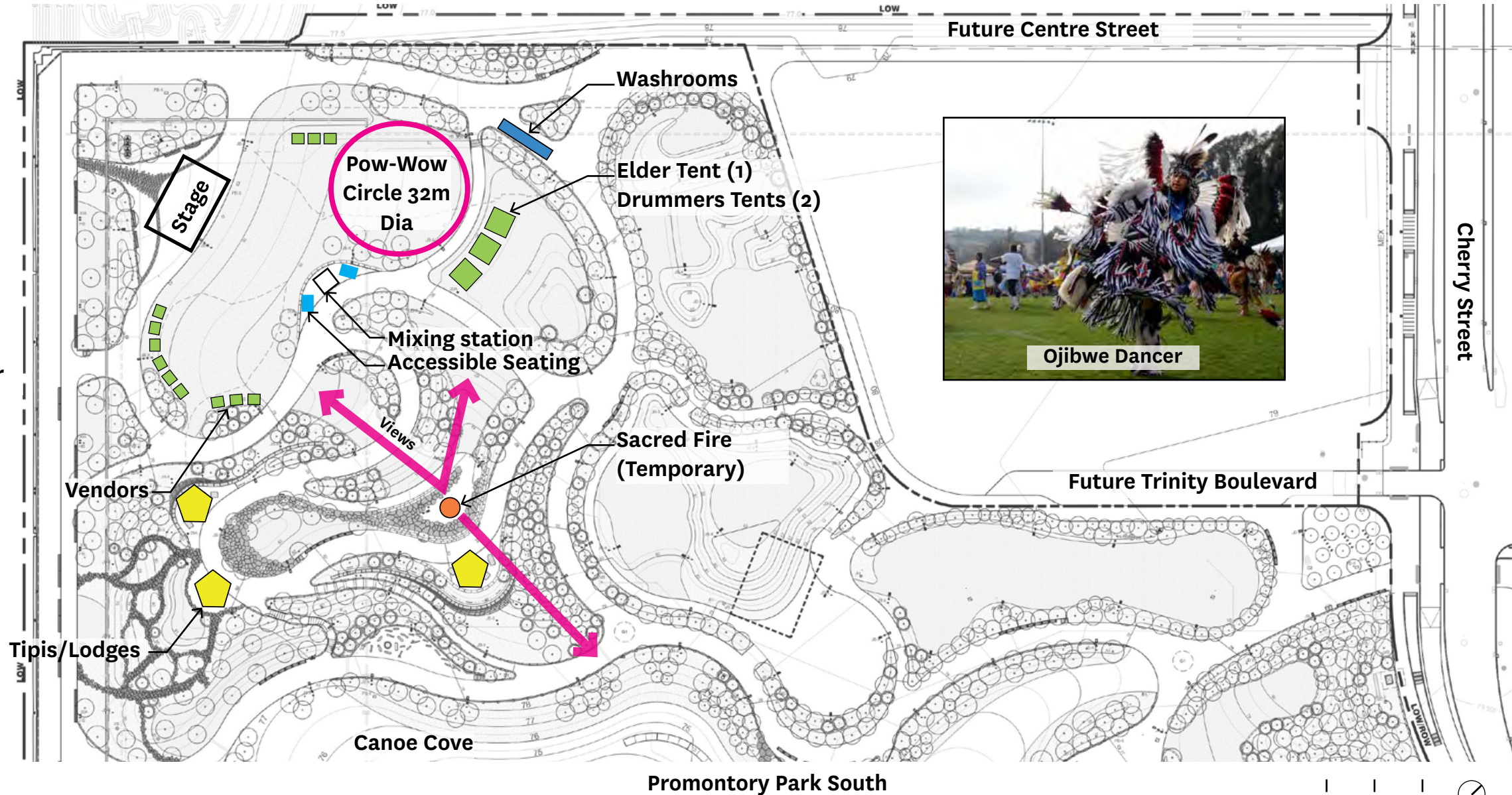



# Local Pow-Wow Programing Diagram

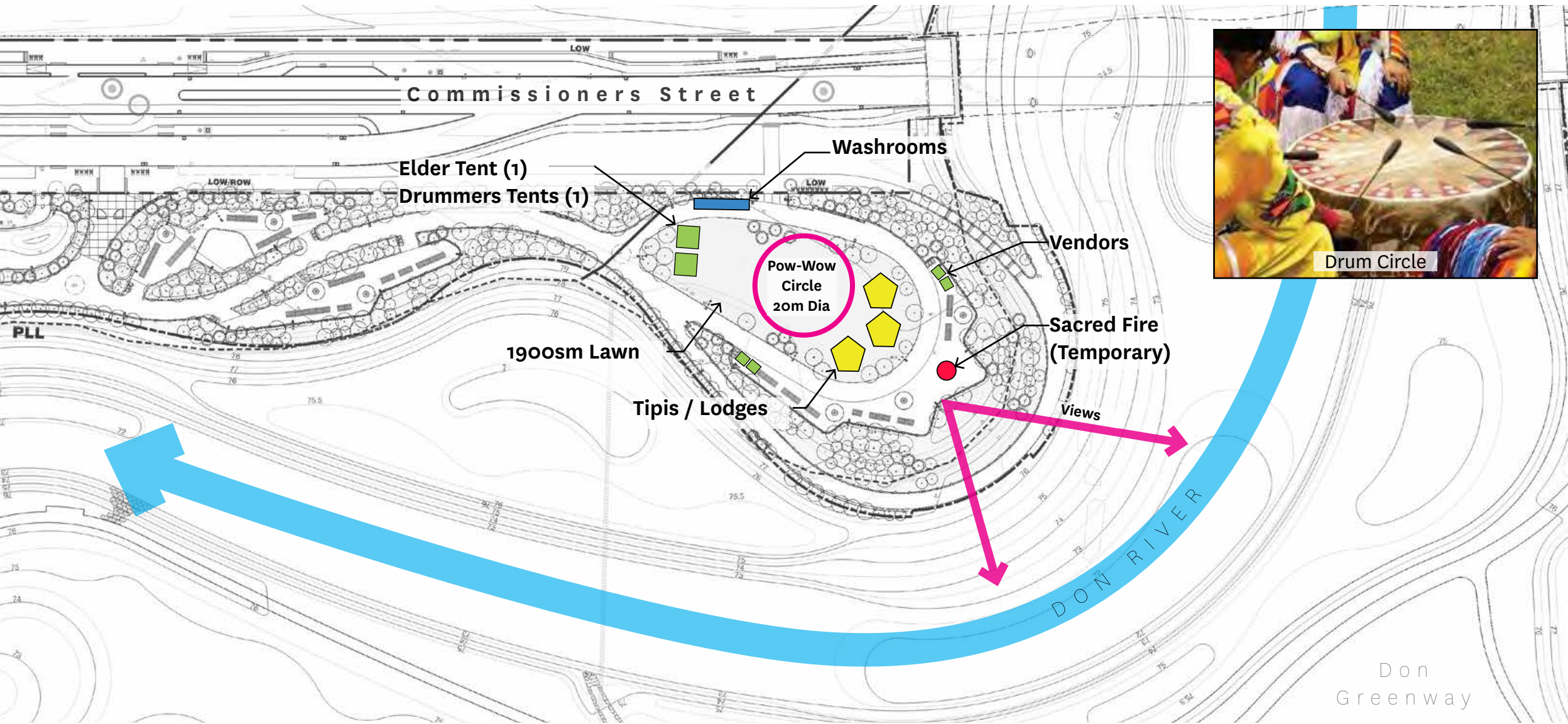

## **Indigenous Designer/Artist Engagement Process Next Steps**

- List of Potential Indigenous Features for Parks and River Identified
- List of Potential Indigenous Designer/Artists Developed by MCFN, WT and MinoKamik
- MVVA team Preparing Artist Brief to Begin Designer/Artist Request for Proposals



# Discussion