

**PORT**

**2024**

**December 4, 2020**

# Port Lands Flood Protection Public Meeting

**LANDS**

Canada

Ontario



Toronto



# Herb Sweeny, MVVA

Presented to the Port Lands Flood Protection  
Stakeholder Advisory Committee on October 22, 2020

# Project Feedback

## Design Review Panel

- Find a role for **public art** within the design
- Develop signage and way-finding
- Create a family of materials and furnishings
- **Consider future conditions** in and around the park, such as the catalyst building and urban massing
- Future-proof the design to **accommodate fluctuating lake levels**
- **Study event programming** at the central lawn
- Develop **park operations** and programming
- Choreograph **winter programming and character**
- Consider unique engagement opportunities between park visitors and site ecology
- Create an **inventive, bio-diverse, and daring planting strategy**
- **Strongly integrate remnants** of industrial and natural heritage
- Provide renderings of the Esplanade
- Develop the character of Destination Play

## Community (Survey + Consultations)

- Feeling immersed in nature comes from ability to wander while discovering new views or un-manicured vegetation
- **Variation of landscape and ecology** was noted as “nice to have”
- People expressed a desire for **clear information about access points** (lighting and signage indicating formal paths)
- Emphasis on **views and variety of landscape types**
- **Create views of Inner Harbour and City**
- **All season use** support winter programming
- Facilitate public water activities and **connections/access to the water**
- **Integrate history** through preserving local heritage and culture (adaptive reuse, art)

## SAC Meeting #7 - May 28, 2020

- The adventurous, all-ages design for the River Valley Park North **play area is exciting, appreciative of the wildness that has been kept there**
- The park design, promontory and the MT-35 Commemoration elements, are **exciting and appropriate for the site context**
- Wayfinding and interpretive signage are creatively thought out. This is a good **opportunity to incorporate Indigenous history or culture, and information about natural species and habitats.**
- **Concern about management of sediment** after it is dredged from the river, especially the smell if it is stock piled on land

Future Promontory Park North

Future Centre Street

Future Development Parcel

Cherry Street

Old Cherry Street

Munitions Street

Commissioners Street

Polson Slip

River Valley Park

Don River

Future Polson Street

1 Central Lawn

2 Promontory

3 Esplanade

4 Canoe Cove

5 Atlas Crane Peninsula

6 Future Destination Play Area

7 Future Play Pavilion/Comfort Station

8 Wetland Viewing Lawn

9 Dogs Off Leash Area

10 Nature Play Area

11 Fire Hall 30 Plaza

12 Picnic Terrace

13 Picnic Lawn

14 Fitness Lawn

15 Lower Don Trail

- 15 Lower Don Trail



# Promontory Park South and River Valley Park North/South - Updated Design



# Orchestrating a Complete Ensemble

## Promontory Park South

- Event Lawn & Plaza
- Harbour Esplanade
- Marine Terminal 35 Building Commemoration
- Promontory
- Atlas Crane Peninsula
- Entry Plaza
- Destination Play Area (Contingent on Fundraising)

## River Valley Park North and South

- Commissioners Street Edge
- Nature Play Area
- Picnic Area
- Picnic Lawn
- Dog Off Leash Areas
- Entry Plaza with Indoor Amenities at FH-30
- Future Polson Street Edge
- Bike Bridges

## Park Wide Features

- Gathering Areas
- Art
- Wayfinding and Signage
- Site Furnishings, Lighting and Materials
- Operations and Maintenance
- Planting

# Promontory Park South



# Promontory Park South - Updated Design





# Event Lawn, Plaza and Esplanade - Promontory Park South





# View From Harbour Promenade Looking South Towards Toronto Islands





# Promontory - Bird's Eye View





# View from Polson Slip Overlook looking Northwest to Harbour Promontory





# Park Entrances at Cherry Street - Promontory Park South

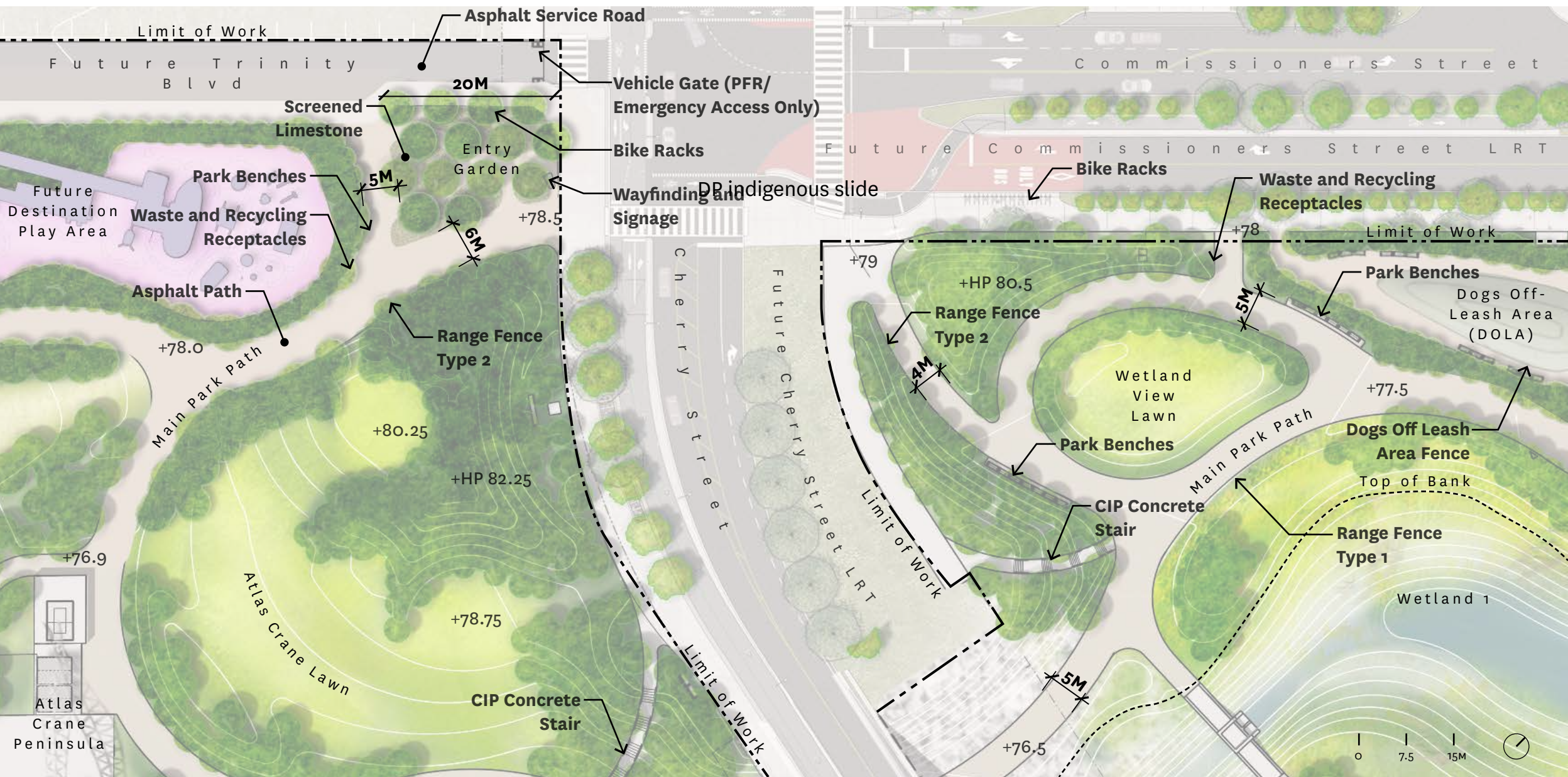

# River Valley Park North and South



# An Integrated Network of Paths and Trails

- Main Park Path: 4-6m
- Secondary Park Path: 2-3m
- Recreational Trails: 2.8m
- Lower Don Trail: 3.6m
- Commuter Bike Lane: 2m
- Martin Goodman Trail: 4m
- Interim Paths: 4m
- City Sidewalks: 3-5m

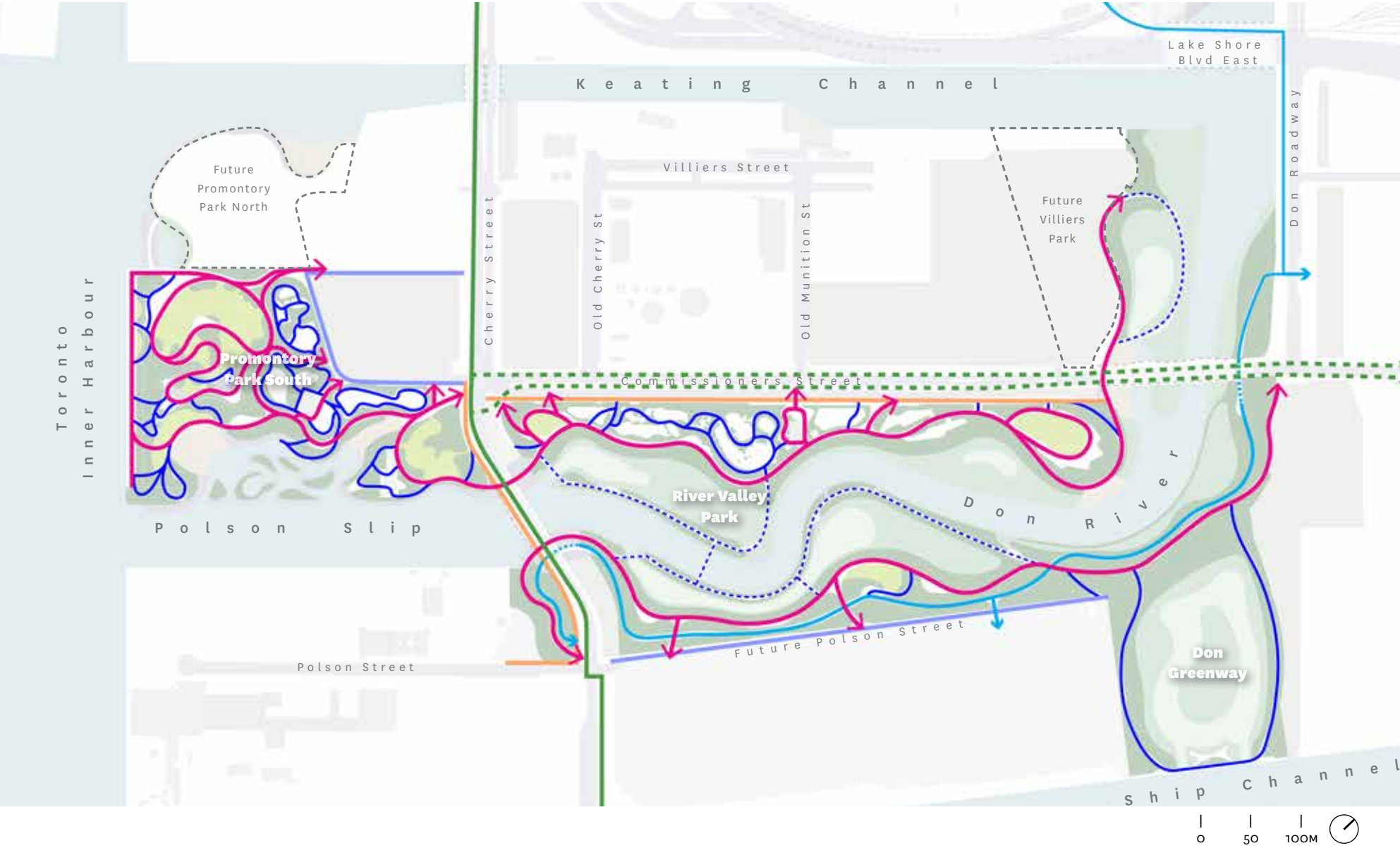



# River Valley Park South Main Entrances - Enlargement plan

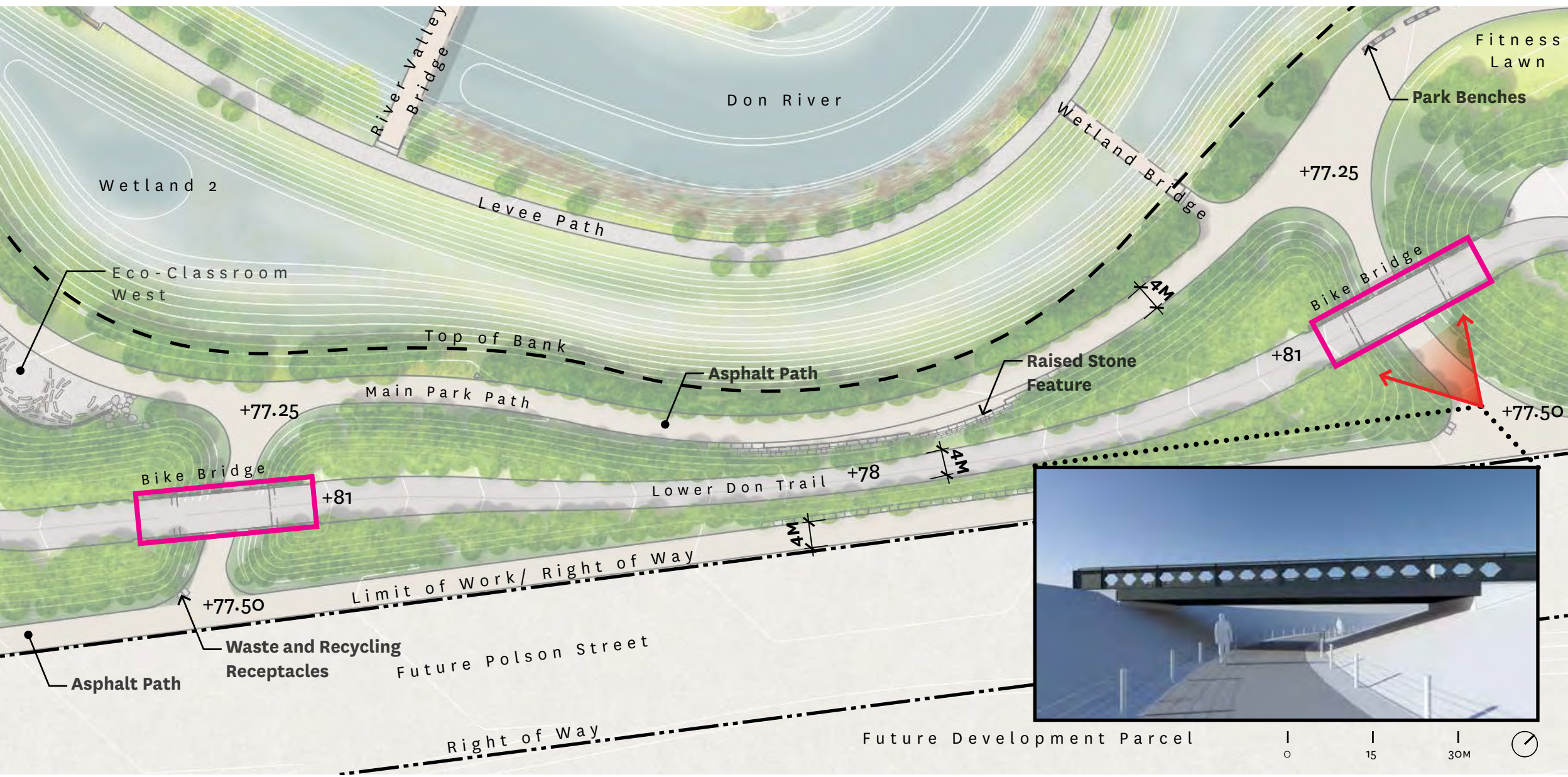



# RVPS West Bike Bridge - Current Design

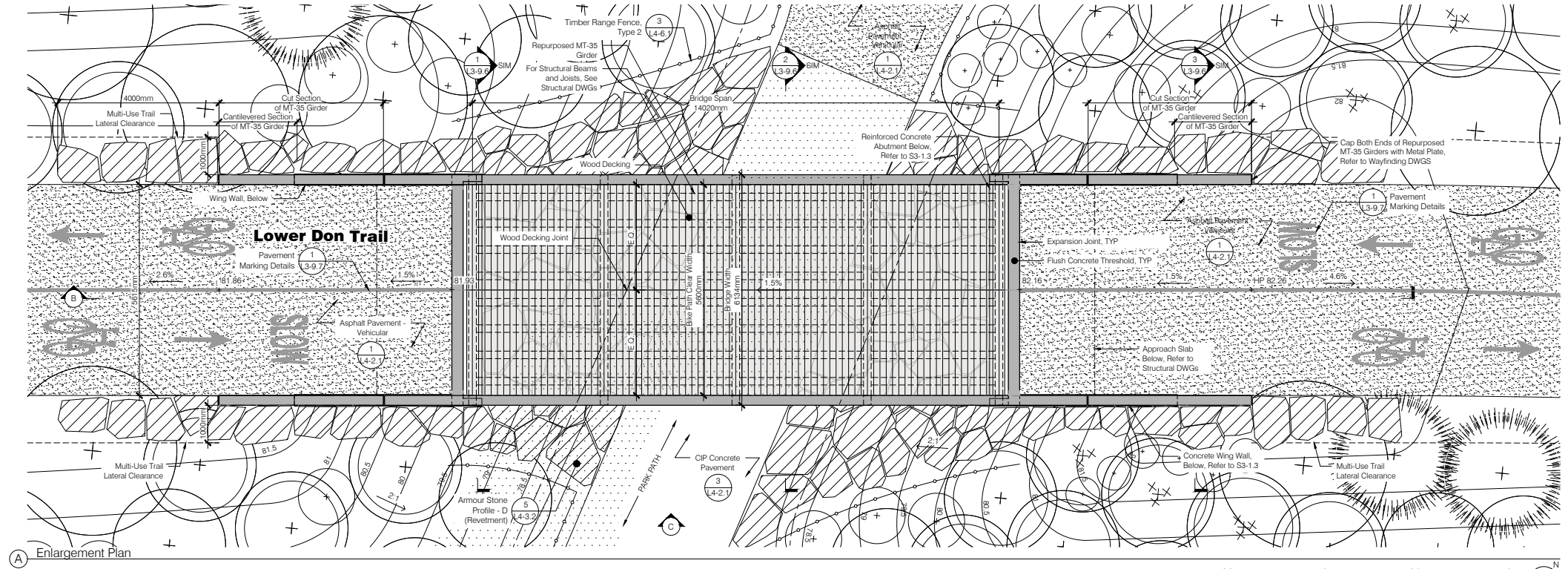



# RVPS West Bike Bridge -Current Design

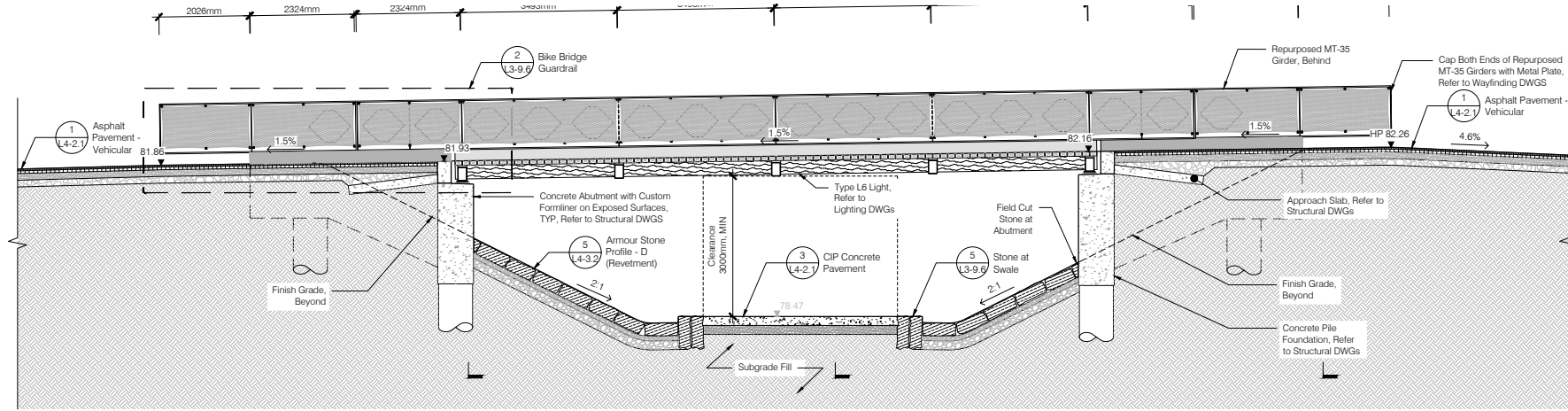

Ⓑ Section Elevation - Longitudinal

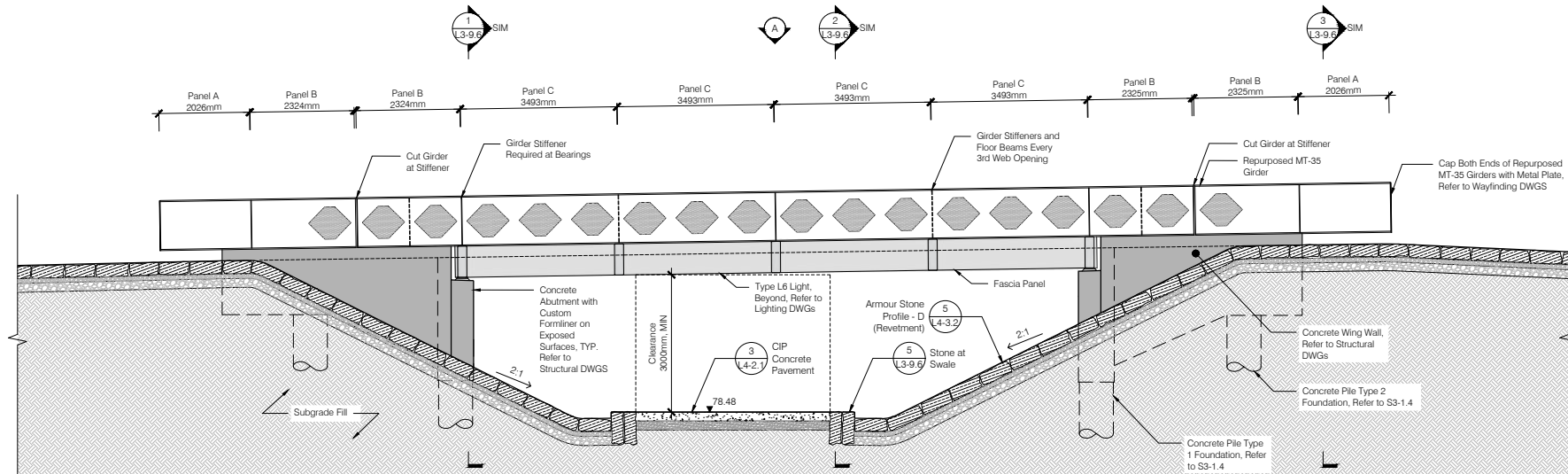

Ⓒ Elevation - Longitudinal

# RVPS West Bike Bridge -Current Design

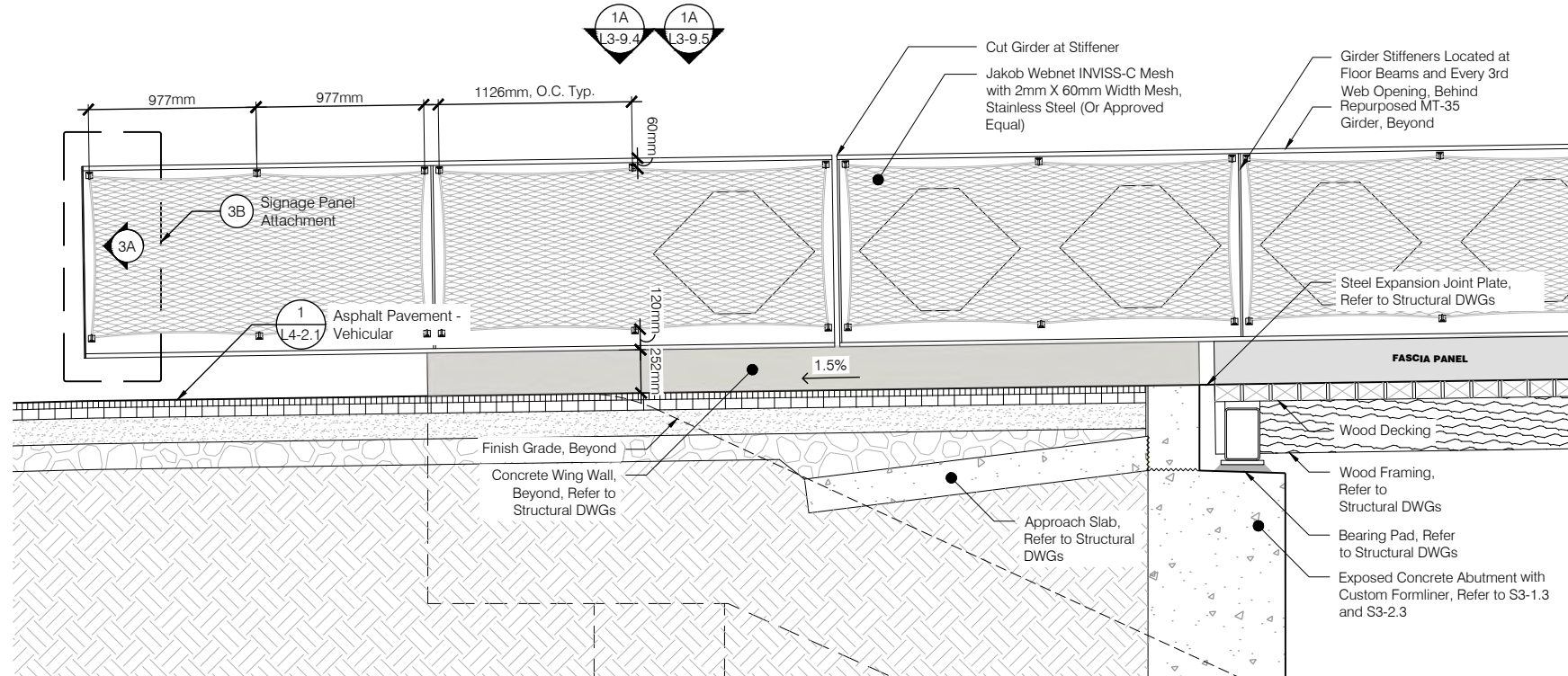

## RVPS West Bike Bridge -Current Design

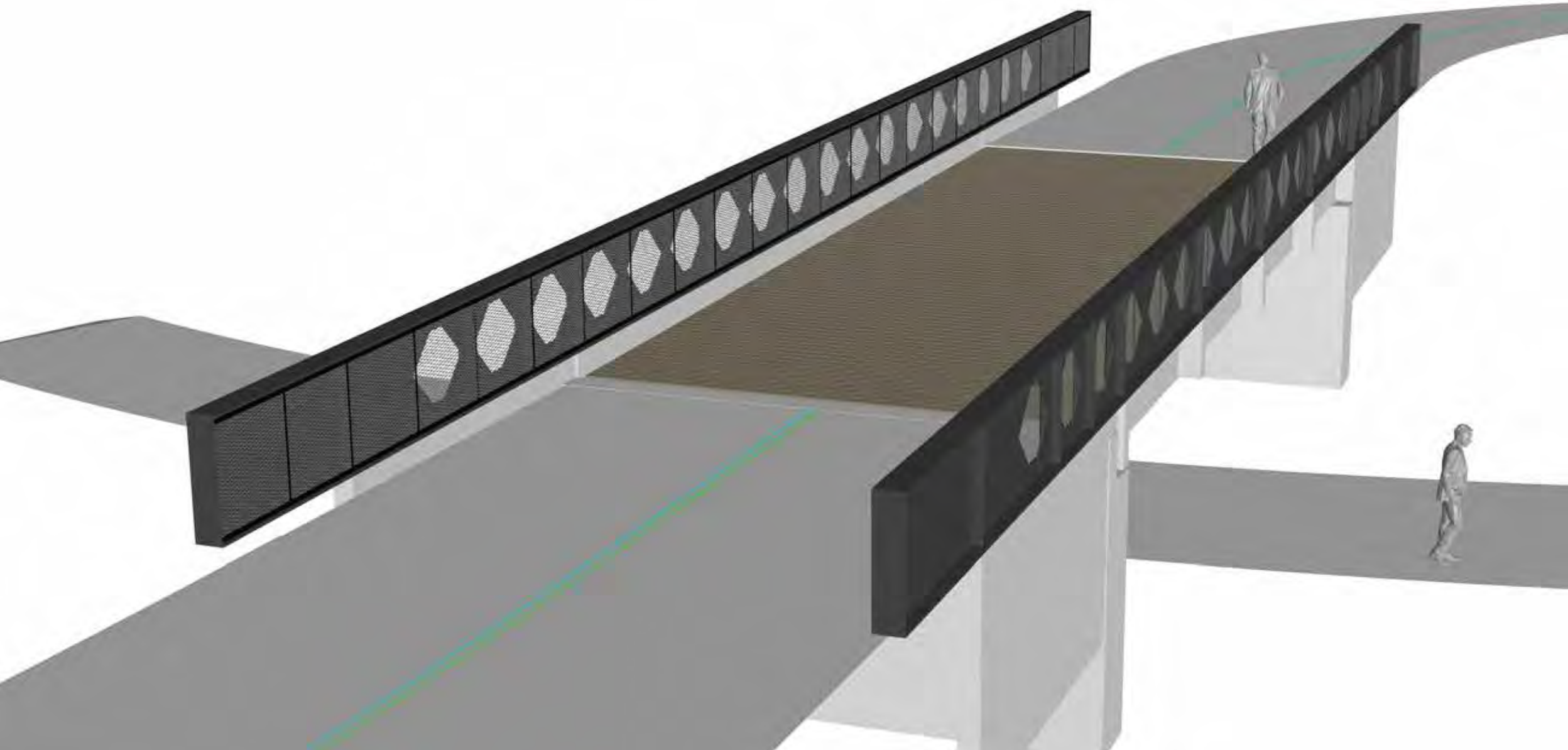



# View From Cherry Street Entrance Looking Southeast into River Valley Park North





# View from Commissioners Street Looking Southeast to Fire Hall 30 Plaza





# Planning for Future Operations and Maintenance Needs



2024

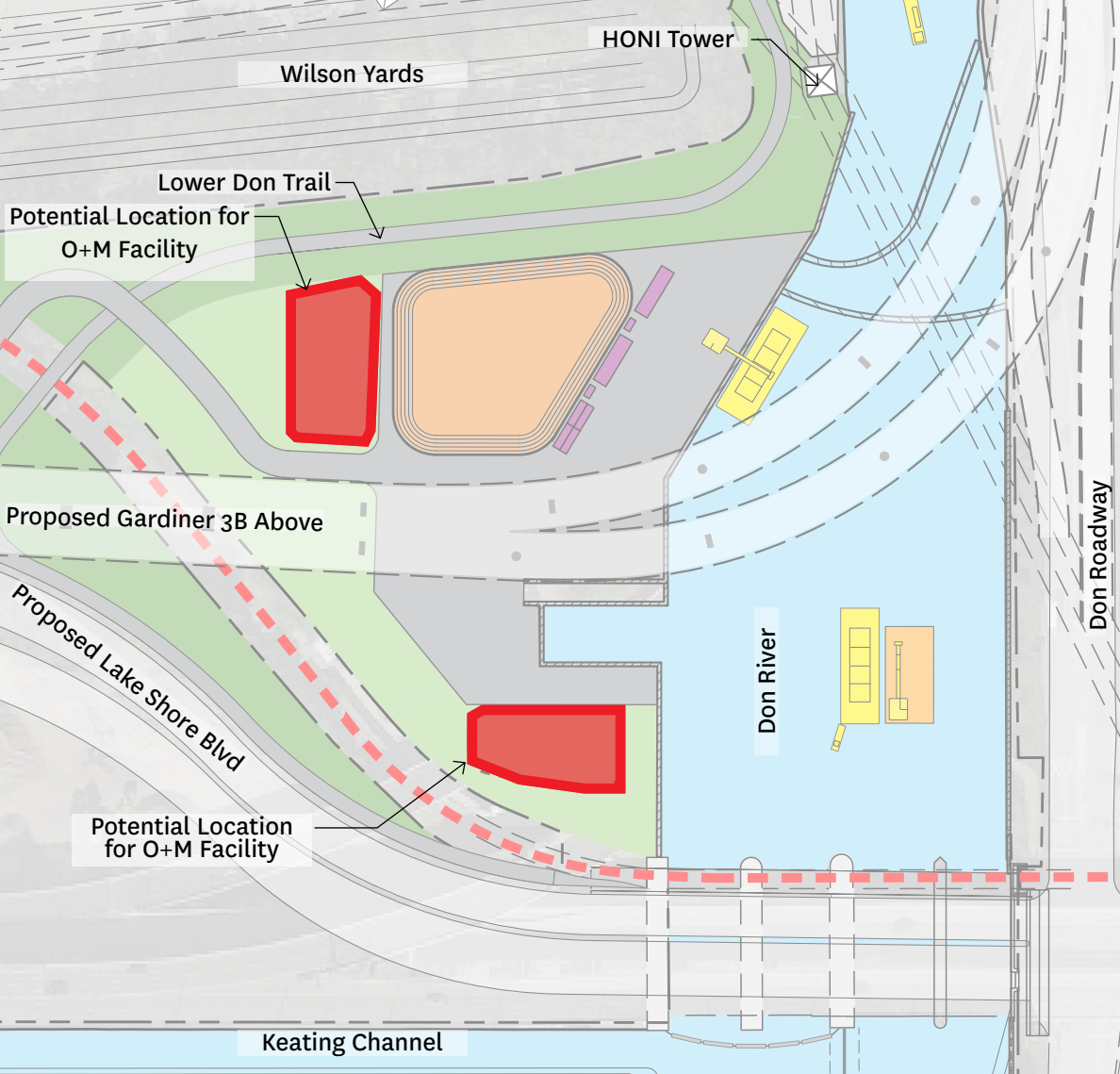

Full Vision





# River Valley Park North - Updated Design





# Nature Play Area - Plan





# Cableway Canyon - River Valley Park North

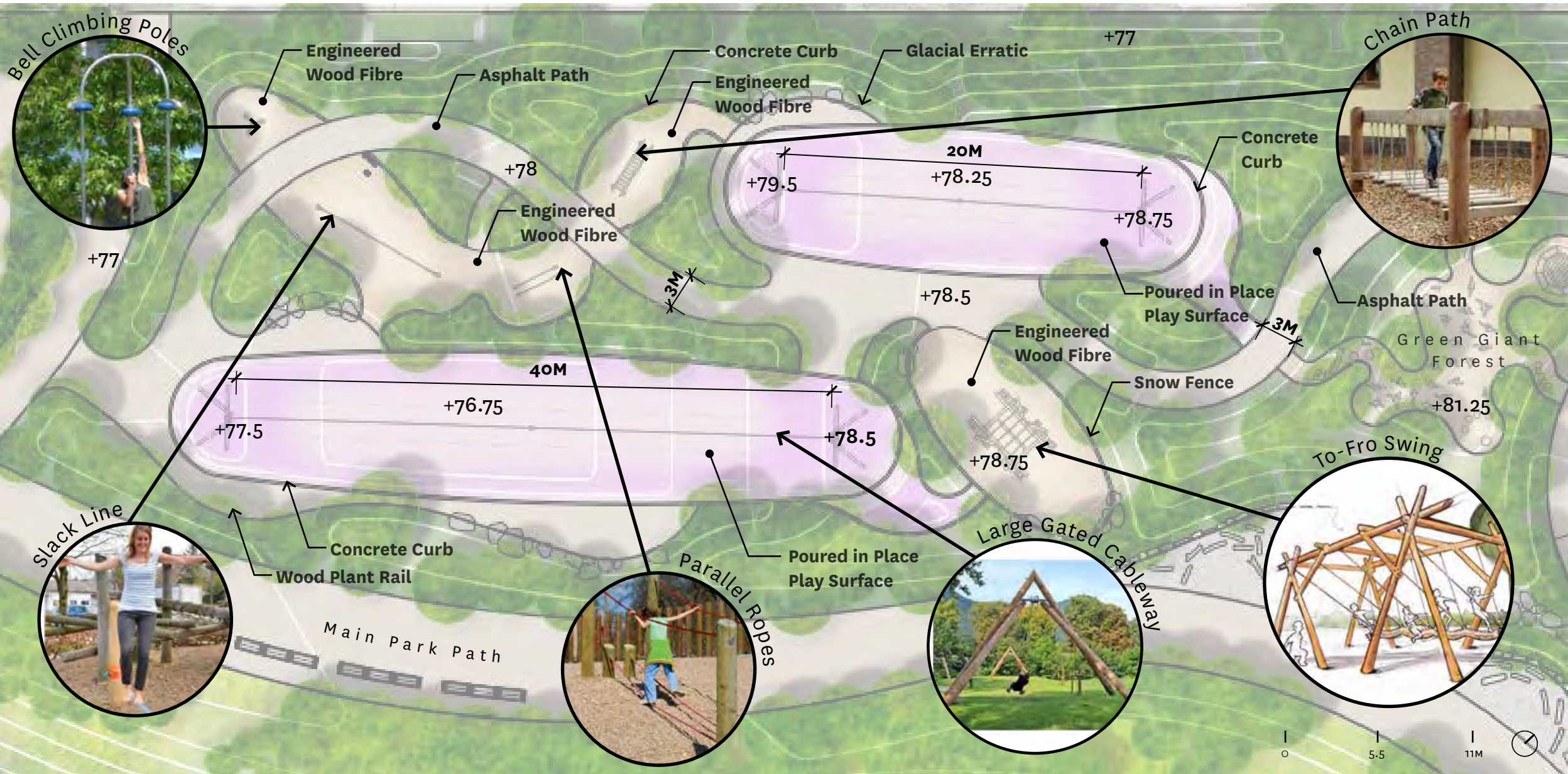



# Green Giant Forest - River Valley Park North

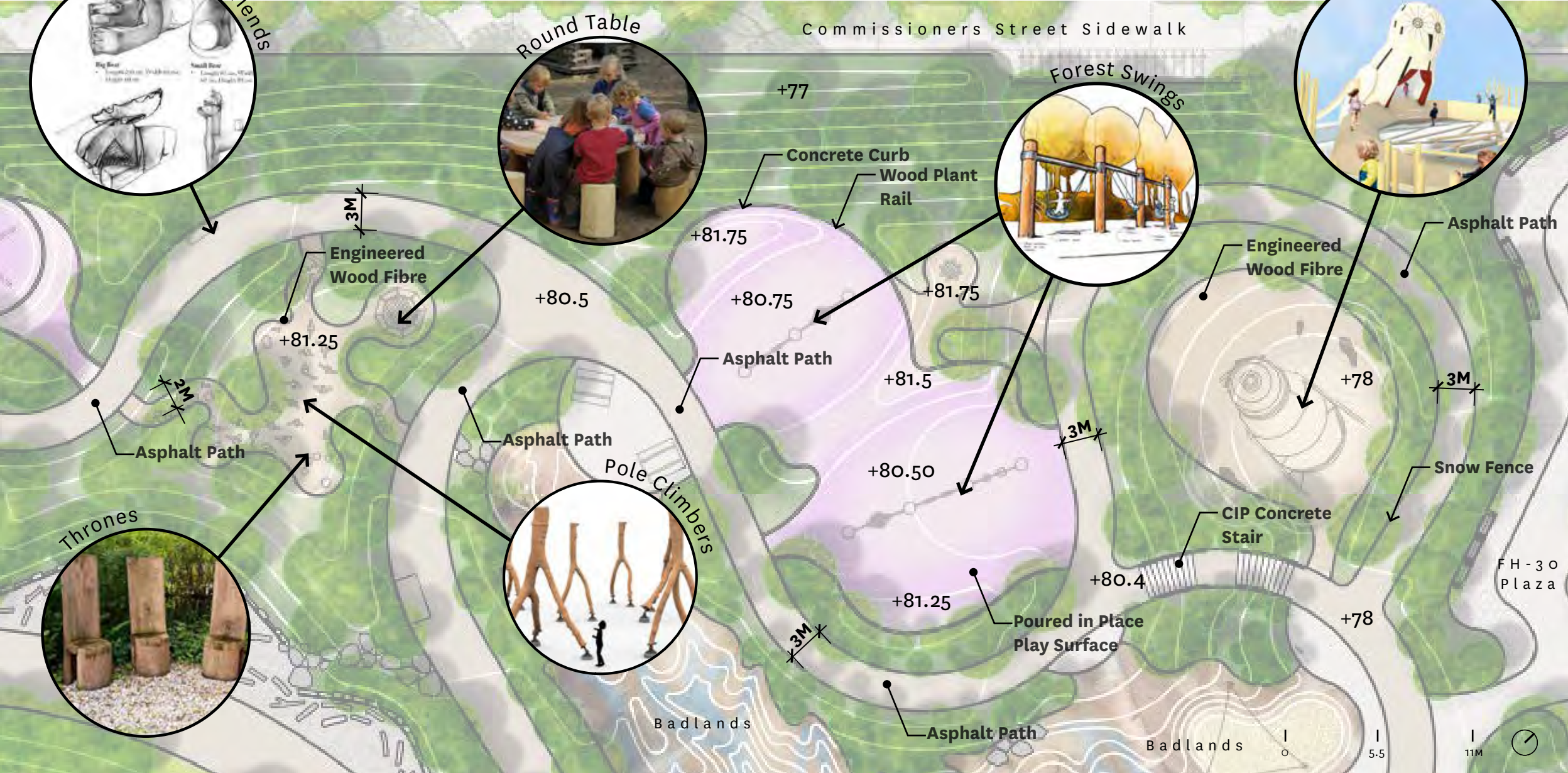

# Badland Scramble - River Valley Park North

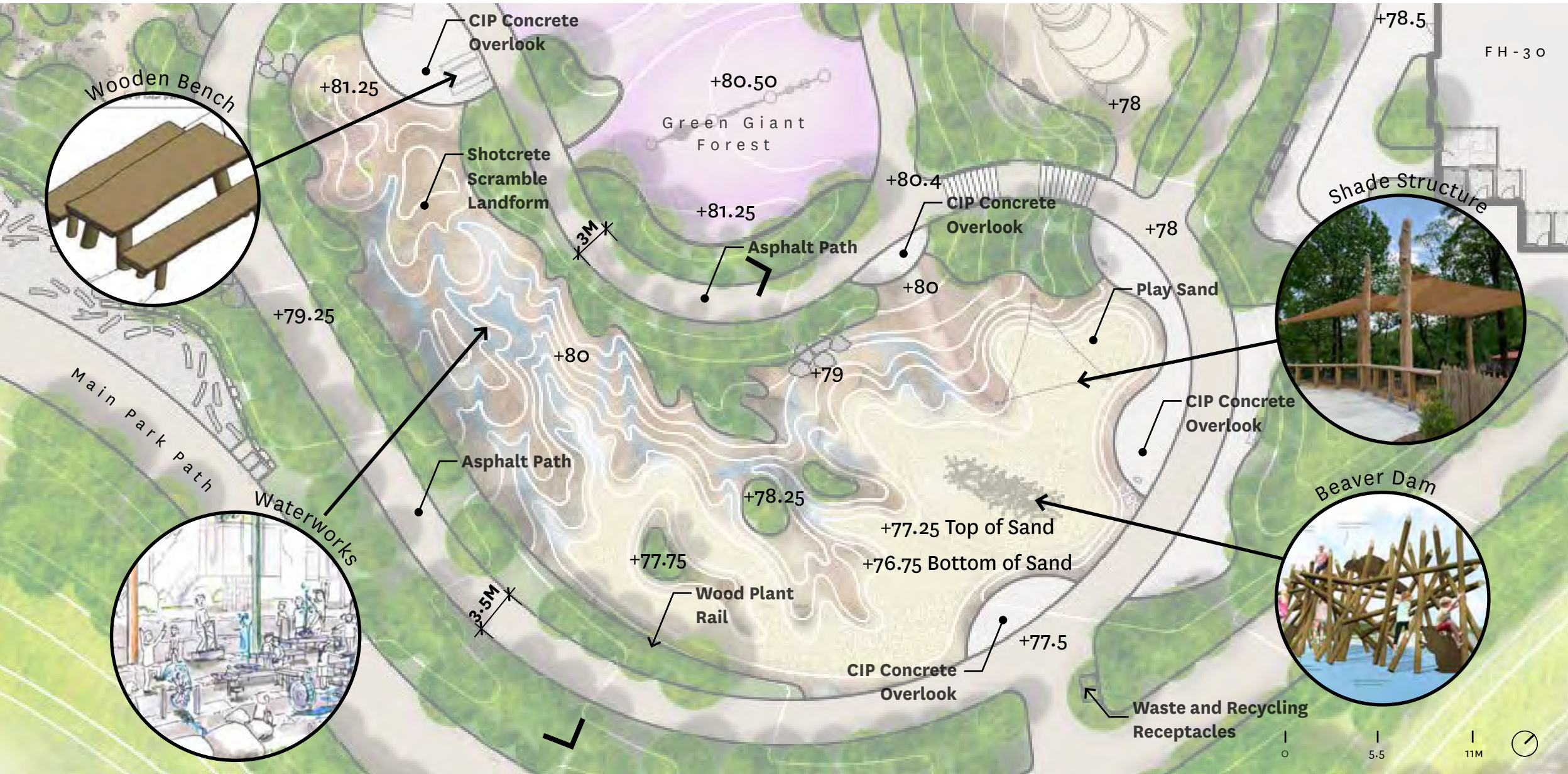



# Picnic Terraces and Picnic Lawn - Plan





# Picnic Terrace - River Valley Park North

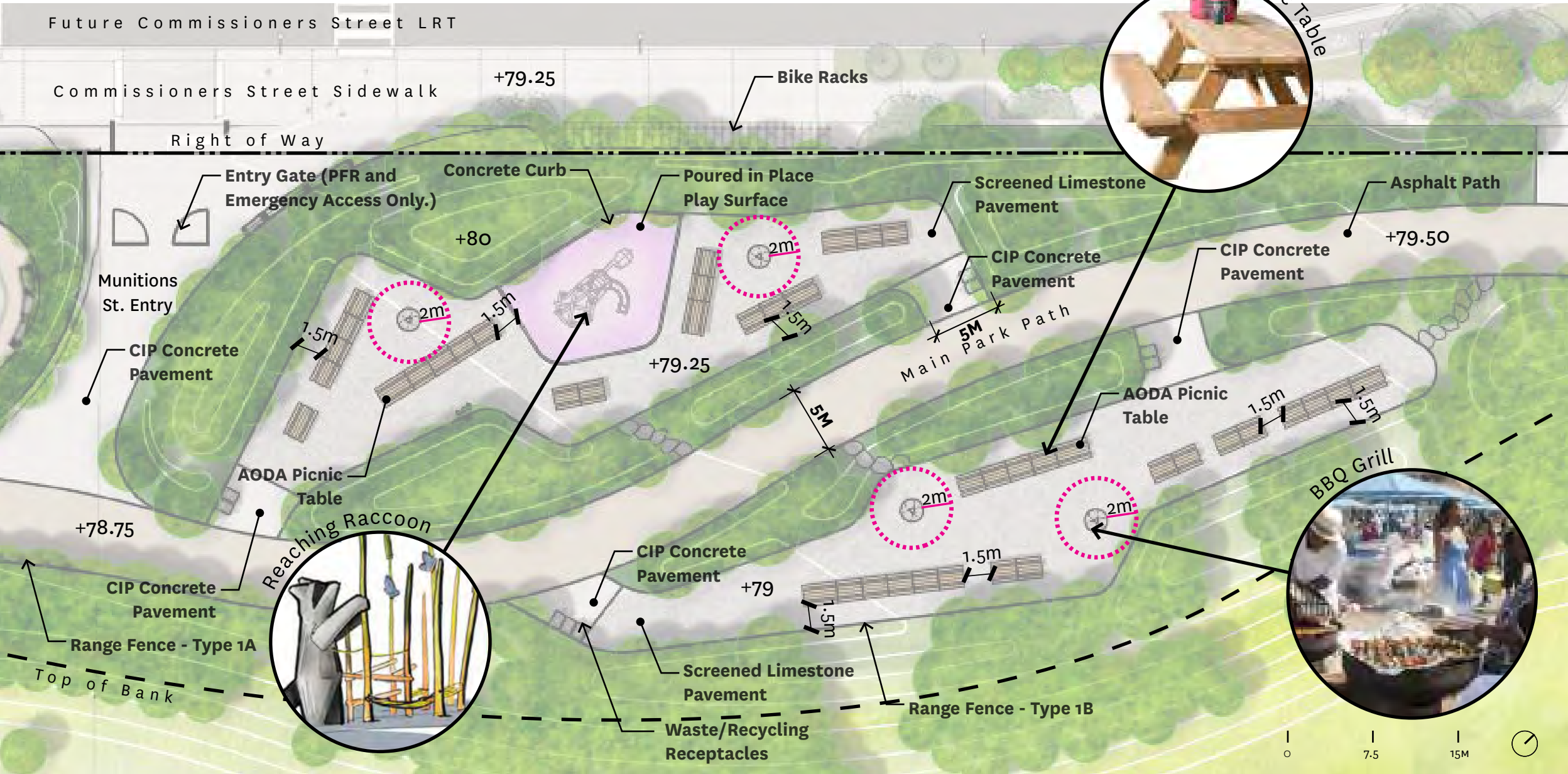



# River Valley Park South Main Entrances - River Valley Park North

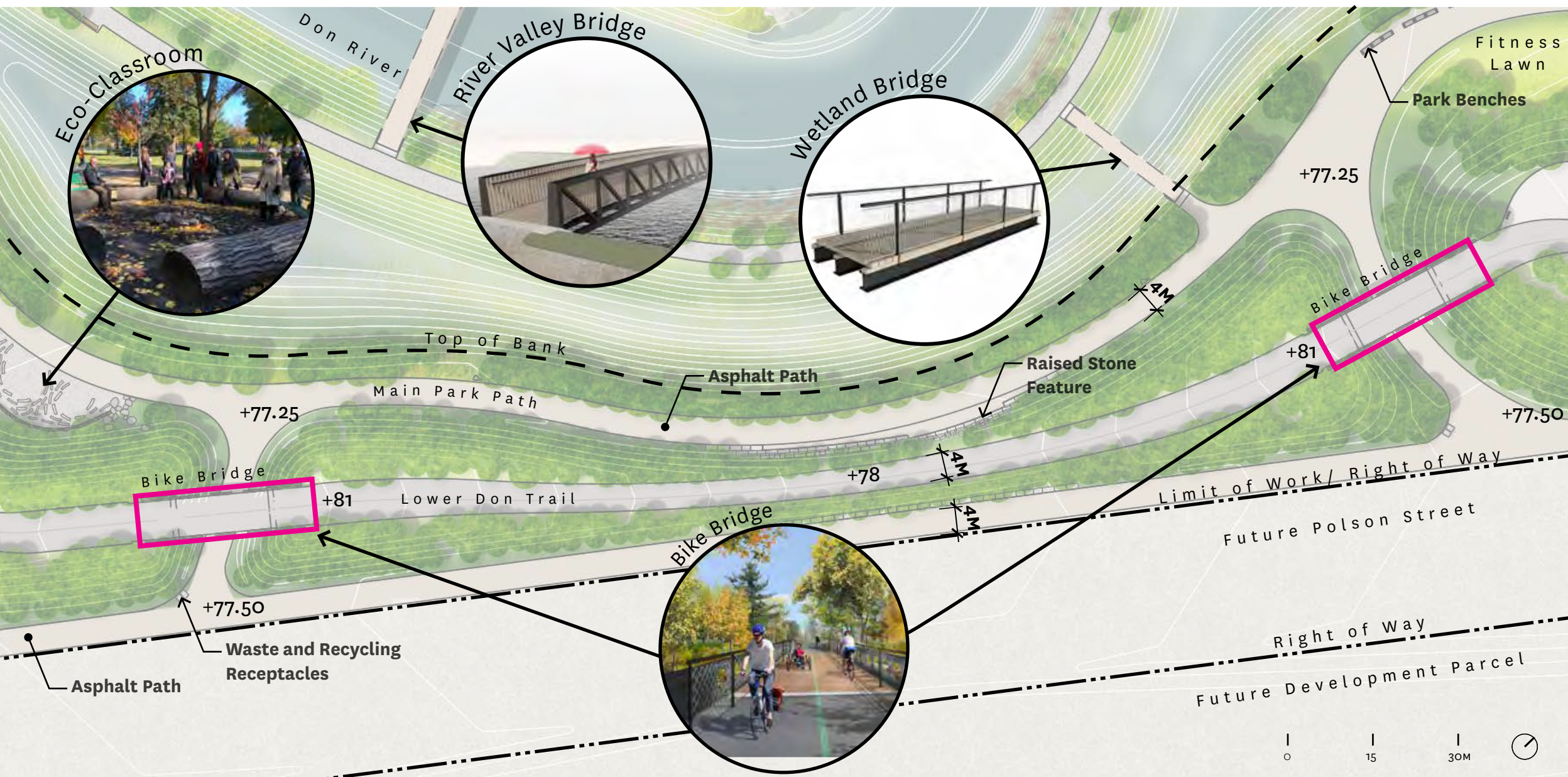

# High Lake Level Analysis



# PLFP - Mean Lake Level (74.74 CGVD:28 Pre 78)



# PLFP - 100 Year High Lake Level (76.09 CGVD:28 Pre 78)





# PLFP - 100 Year High Lake Level - Available River Crossings (76.09)



# Planting a Forest Frame



# Park Planting Zones- Diagram

- Garden
- Grove
- Glade
- Hedgerow
- Mixed Forest
- Lawn



# Planning for Planting Evolution Over Time

Handoff: 2024

Stage 1 - Initial Development



5-9 Years

Stage 2 - Early Closed Canopy



10-20+ Years & Beyond

Stage 3 - Mature Canopy





**View from Cherry Street Park Entrance looking Southwest towards Canoe Cove**





# View from River Valley Park South Lawn looking West Towards Promontory Park South

