

August 2021



Construction Notice #19: Port Lands Flood Protection

Construction manager



Traffic Notice: Lane Diversions at Cherry Street and Lake Shore Boulevard East Intersection

August - October 2021

Starting in August, changes to the north section of the intersection of Cherry Street and Lake Shore Boulevard will begin. Traffic travelling south on Cherry Street towards Lake Shore Boulevard will not be able to turn left to go eastbound on Lake Shore Boulevard. Eastbound Lake Shore Boulevard traffic will be restricted to one lane.

Reconfiguring the intersection of Cherry Street and Lake Shore is necessary to:

- Integrate with the future Cherry Street, which will be rebuilt further west of existing Cherry Street
- Connect a new watermain to the Port Lands and install new traffic signals and street lighting
- Improve the intersection for pedestrians and cyclists

To learn more about what we're building, find a project [map](#).

WHAT TO EXPECT:

- Southbound traffic on Cherry St. will be forced onto Lake Shore Boulevard westbound
- Eastbound traffic on Lake Shore Boulevard will be reduced to a single lane
- Construction noise and dust



Above: This map shows the location of the intersection improvements

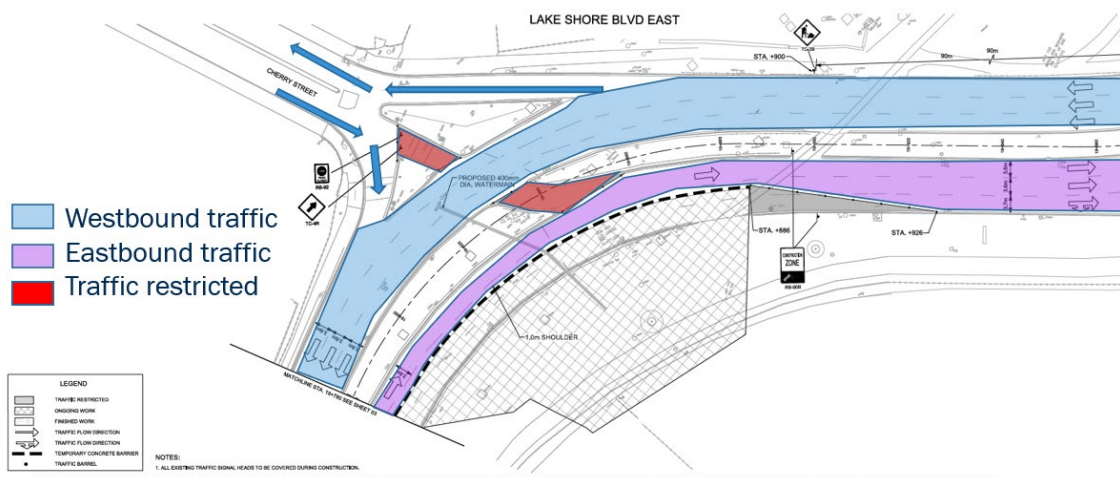

Above: This map shows the lane restrictions on Lake Shore Boulevard eastbound and the restricted access to the eastbound lane from Cherry Street.

Lane Restrictions on the Martin Goodman Trail

Until November 2021

Continue to expect intermittent lane closures on the Martin Goodman Trail between Parliament Street and Cherry Street. One lane will always remain open. Signs and flagpersons will direct east-west pedestrian and cyclist traffic. Whenever it is safe, priority will be given to pedestrians and cyclists. As the work progresses, the path will be cleaned and patch-paved for safety. These closures are needed as we finish work on utilities beneath the new Cherry Street.

WHAT TO EXPECT:

- Lane restriction: The Martin Goodman Trail will be reduced to a single lane only for periods of 1-2 days at a time
- Closures will shift between eastbound and westbound lanes
- Delays: Cyclists and pedestrians will be prioritized when safe, but expect some wait time
- Construction noise and dust



Above: This map shows the section of the Martin Goodman Trail (MGT) where closures will occur between March-November 2021, and the location of signage and flagpersons.

Road Work

Commissioners Street remains closed between Cherry Street and Don Roadway. Don Roadway remains closed between Commissioners Street and Villiers Street. Both closures will remain in place until Summer 2022.

Future Road Work

Changes to the Lake Shore Bridge over the Don River are required as part of both Port Lands Flood Protection and the City of Toronto's Gardiner Expressway and Lake Shore Boulevard Reconfiguration (Gardiner East) project.

This work includes:

- Removing the Logan Ramps at the east end of the Gardiner Expressway
- Widening and lengthening the Lake Shore Bridge
- Rebuilding the roadway between Don Roadway and Carlaw Avenue, including more landscaping and protected spaces for cyclists and pedestrians

Find out more about the [Lake Shore Boulevard East project](#).

LEARN MORE

Join us for a **Virtual Public Information Centre** on **August 5 from 1:00 - 3:00 p.m.** to hear more about construction timing and future road work related to the Lake Shore Boulevard East project.

[Register HERE](#).

Construction Update

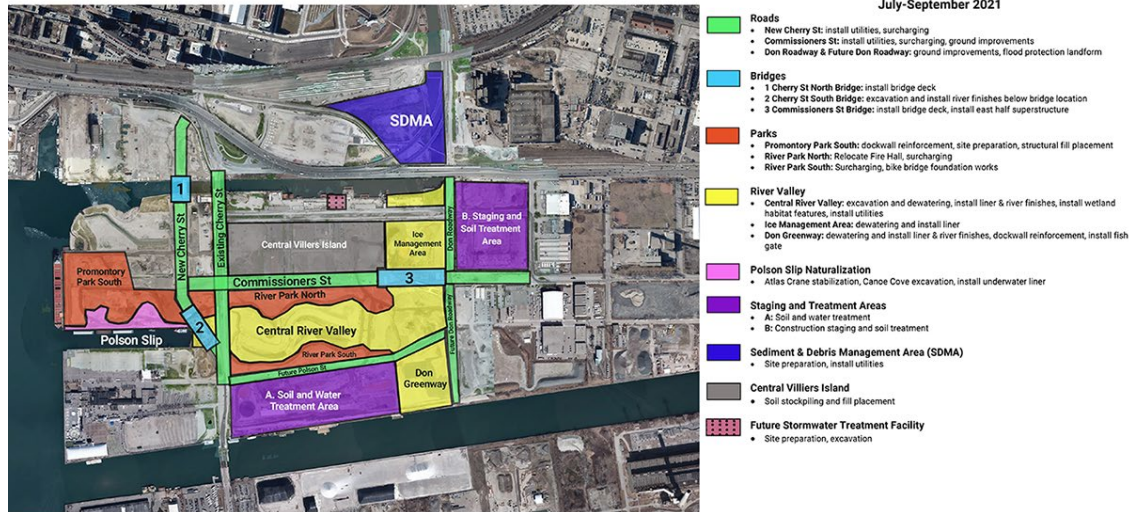

Click [here](#) to open a larger version of this map.

Ongoing Work

River Valley

Excavation is complete in the Ice Management Area and Don Greenway, and the liner is being installed. In the central river valley, crews are placing river finishes – rocks and other materials that will become the bottom of the new river. Learn more about the progress in the river valley in this [video](#).

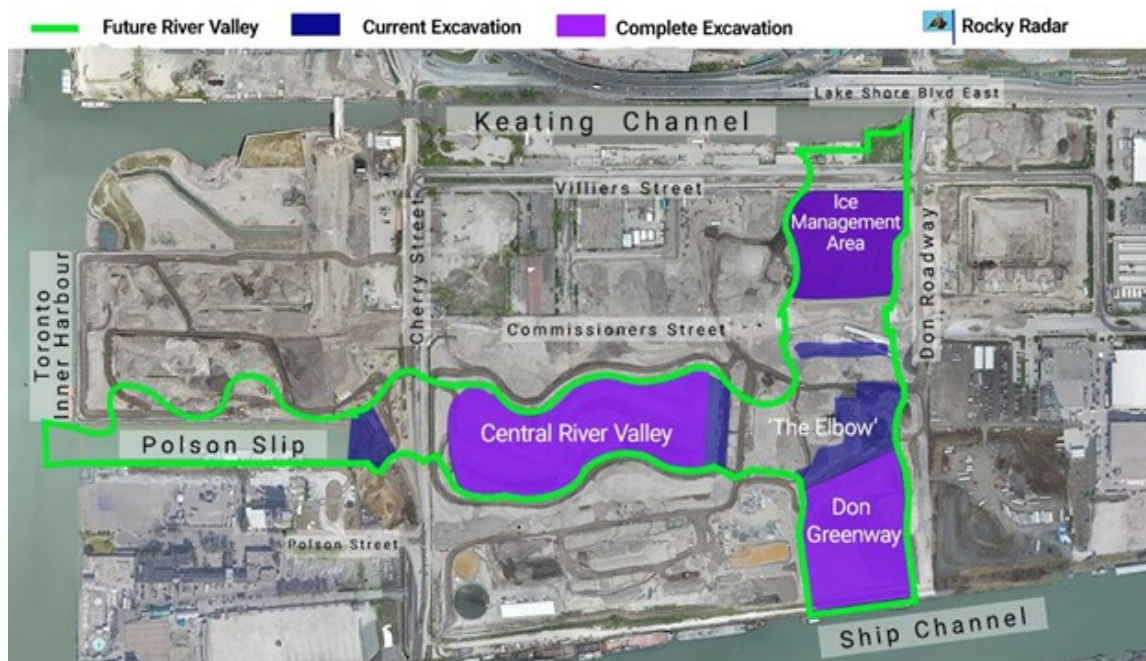

July 23, 2021

@TheRockRipper

Above: Deep excavation is complete in the Don Greenway/Spillway at the south end of the site and the Ice Management Area to the north. We've also started excavation at the east end of Polson Slip, where the new river will meet the lake. Follow Rocky [@TheRockRipper](#) on Twitter for more updates.



Above: These trees will reinforce sections of the river bank. In an extreme flood event, the roots of the trees help protect the bank from erosion due to fast-moving water.



Above: This is the location of the future Cherry Street South Bridge, at the east end of Polson Slip. The large concrete pole in the foreground is one of the bridge piers. The ground below the bridge has been excavated and will have river finishes installed before the bridge arrives

Commissioners Street Bridge



Above: The west half of the Commissioners Street Bridge arrived in May. It travelled to the Port Lands on a barge and was then carried overland using Self-Propelled Modular Transporters. The east half of the bridge is scheduled to arrive later this summer.

Moving Fire Hall 30



Above: Fire Hall 30 is a designated heritage structure built in the 1920s. It was relocated in order to improve Commissioners Street, which will be raised by one to two metres and widened. These improvements are necessary for flood protection. You can learn more about how the Fire Hall was moved in this [blog post](#).

See more photos from the site [here](#).

Questions?

To learn more about this project, please visit [PortLandsto.ca](#).

Use this [online form](#) to send us questions or concerns about construction or email us at plfp@ellisdon.com.

For urgent construction related issues, please contact Cameron Coleman, EllisDon, at 416-464-3583.

Waterfront Toronto

20 Bay Street, Suite 1310, Toronto, Ontario M5J 2N8

T. 416-214-1344 | waterfronttoronto.ca | info@waterfronttoronto.ca

